

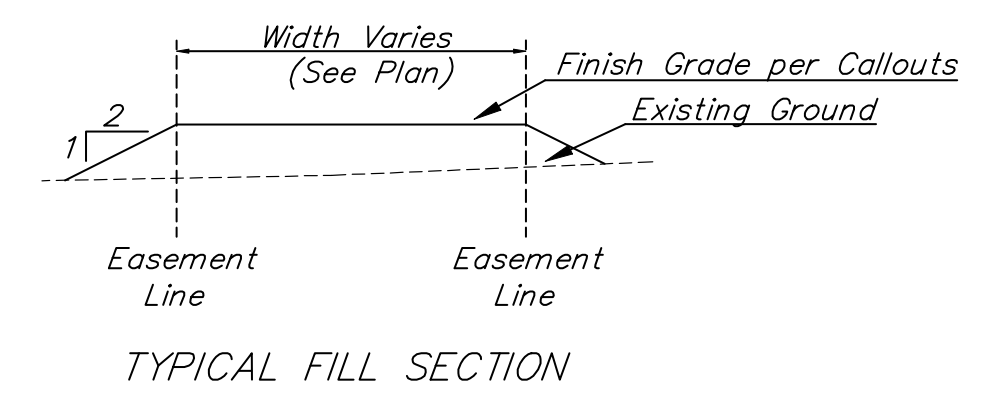

Scale: 1" = 40'

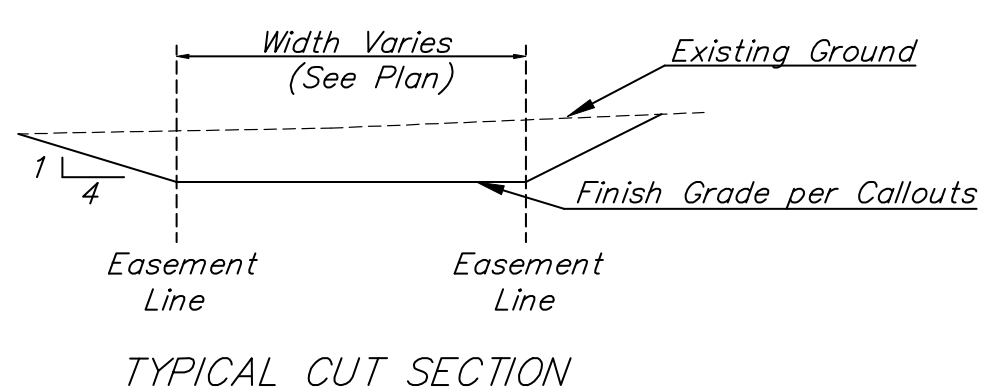

TYPICAL FILL SECTION



TYPICAL CUT SECTION

SECTION A-A

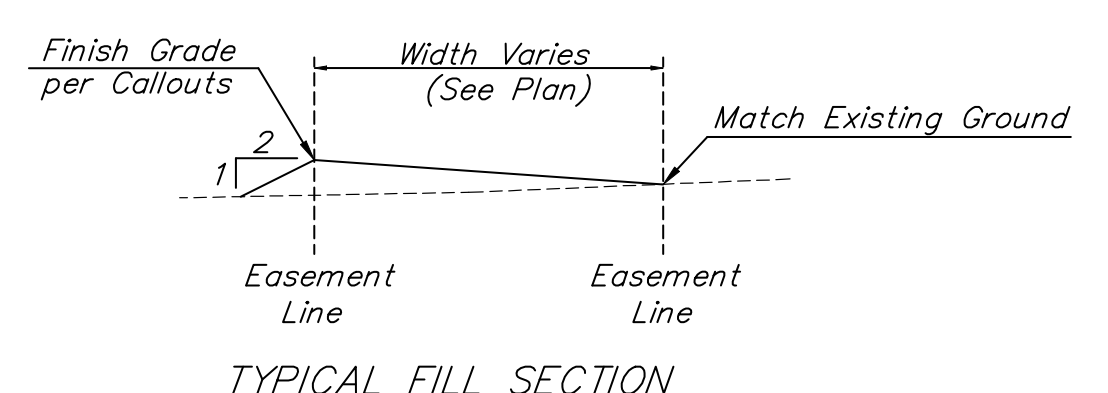

TYPICAL FILL SECTION

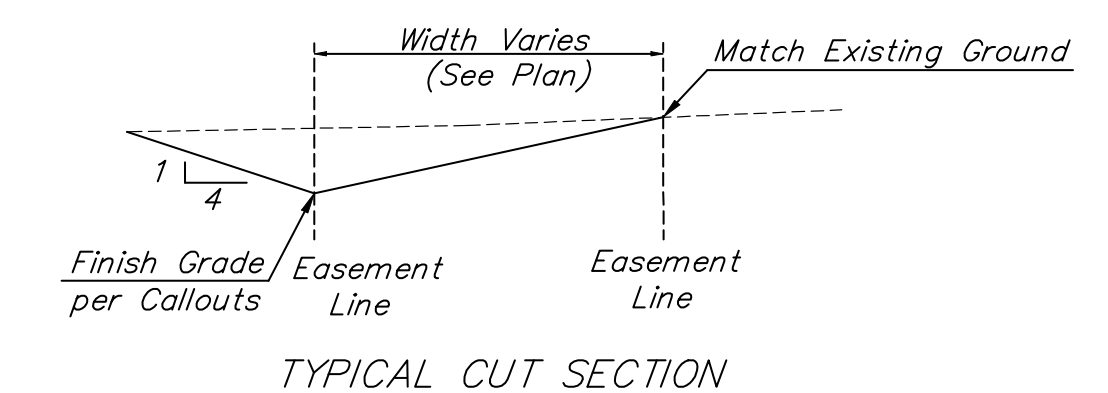

TYPICAL CUT SECTION

SECTION B-B

= Easements To Be Graded

Approximate Easement Grading Quantities:
(For Information Only)
Excavation: 126 C.Y.
Fill: 0 C.Y.

The contractor shall grade the easements as shown to the elevations given on the easement grading plan. All costs for grading shall be incidental to the Easement Grading Bid Item.

The contractor shall 'straight' grade the easements between the elevations given. Where a callout designates 'Match', the contractor will grade to the existing ground elevation.

Stockpile excess material on-site at a location determined by the Engineer out of easements and right-of-way. All cost associated with mass grading shall be incidental to lump sum bid item "Mass Grading".

- Contractor to strip top 3" of soil within street R/W before mass grading and stockpile.
- Compaction of 95% shall be obtained in all street R/W's, 90% in all other areas.
- It shall be the Contractor's responsibility to protect the sanitary sewer and water distribution system during mass grading. Any damage done to these systems by Contractor or subcontractor shall be repaired at no additional cost to the project.
- Only trees within the street R/W may be removed if necessary for grading. All other trees shall be protected from damage.
- All areas disturbed during construction not under proposed pavement are to be seeded as follows:
Seed: - Rye Grass (PLS) - 5#/1000 Sq. Ft. and
Kansas Premium Fescue Blend - 5#/1000 Sq. Ft.
Cost of seeding shall be incidental to "Project Seeding".

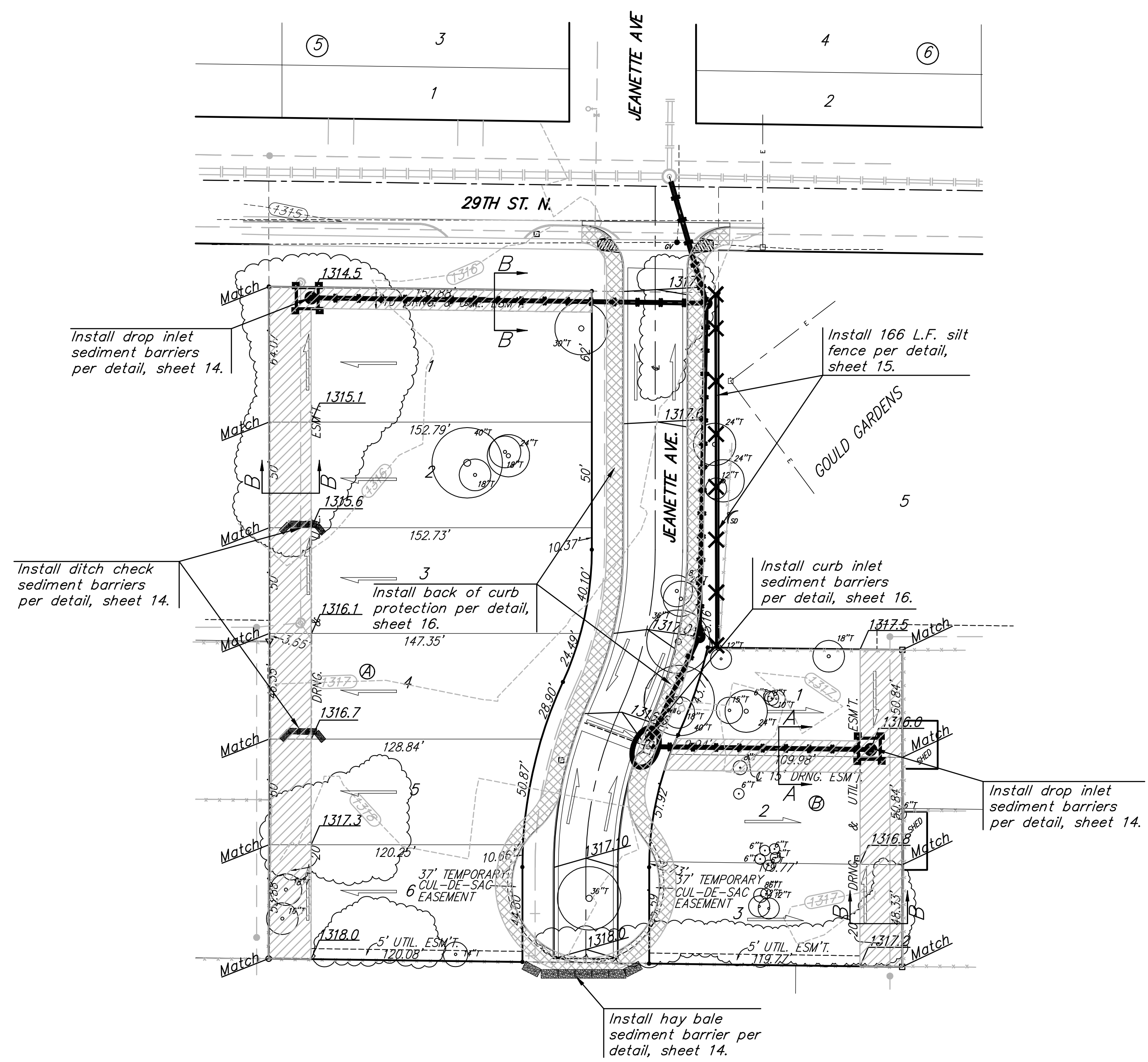

EROSION CONTROL PLAN LEGEND
(Installation Details Found in the SMP2 Plan)

- DROP INLET PROTECTION
- CURB INLET PROTECTION
- DITCH CHECKS
- SILT FENCING
- CUT-OFF TRENCH
- BACK OF CURB PROTECTION
- EROSION CONTROL MAT
- TEMPORARY DITCH

NO SCALE

Maintain one construction entrance onto existing paved roadway per detail, sheet 16.

		WOODLAND NORTH ESMT. GRADING & EROSION CONTROL PLAN	
<small>Baughman Company, P.A. 315 Ellis St. Wichita, KS 67211 P 316-262-7771 F 316-262-0149 ENGINEERING SURVEYING PLANNING LANDSCAPE ARCHITECTURE</small>			
PROJECT NUMBER	DESIGN	DRAWN	
	NBW/TJW	TMS	
REVISIONS:	APPROVED	DATE	
		05/08	
	SCALE		
	Noted		
	SHEET		
			12 OF 19
WoodlandNorth/SurECPlan		08-02-E055	