

FHWA REGION NO.	STATE	PROJECT NO.	FISCAL YEAR	SHEET NO.	TOTAL SHEETS
7	KANSAS	87N-0378-01	2008	10	72

P.V.I.
ELEV. = 1332.00 T.C.
NO V.C.

P.V.I.
ELEV. = 1331.50 T.C.
NO V.C.

P.V.I.
ELEV. = 1333.00 T.C.
NO V.C.

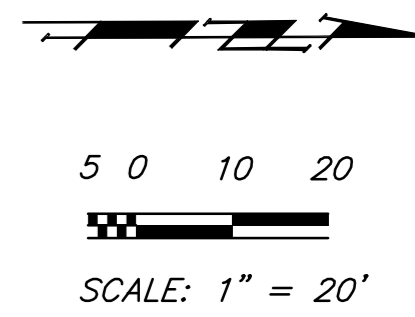

Sta 51+13.17 BL B
End Construction 9" Intersection Pavement on 6" Crushed Stone Base on Geogrid Reinforcement. Begin Construction 7" A.C. Pavement (8" Crushed Stone Subgrade)

Remove and Replace exstg Median Pvmnt w/ Curb & Gutter. Construct Std Comb Low Edge Median Curb & Gutter (8"x 1.75")(Type III)(AE) and 6/0' Solid Conc Median Ramp-type Nose Section (N) & Modified Median Nose(S). Construct Brick Paver Median Pvmnt. See Misc. Detail Sheet

Construct WCR's Per Std. WCR Detail Sheet (Both Sides) Match Exist Walk Grade

Remove & Replace Conc. Combined Curb & Gutter to Match, Each Side to be paid as L.F. curb & Gutter (Combined)(Type I & II)(6")

Sta 54+95.63 BL B
End Construction 7" A.C. Pavement on 8" Crushed Stone Subgrade on Geogrid Reinforcement w/ Std Comb Curb & Gutter (Type I)(AE)

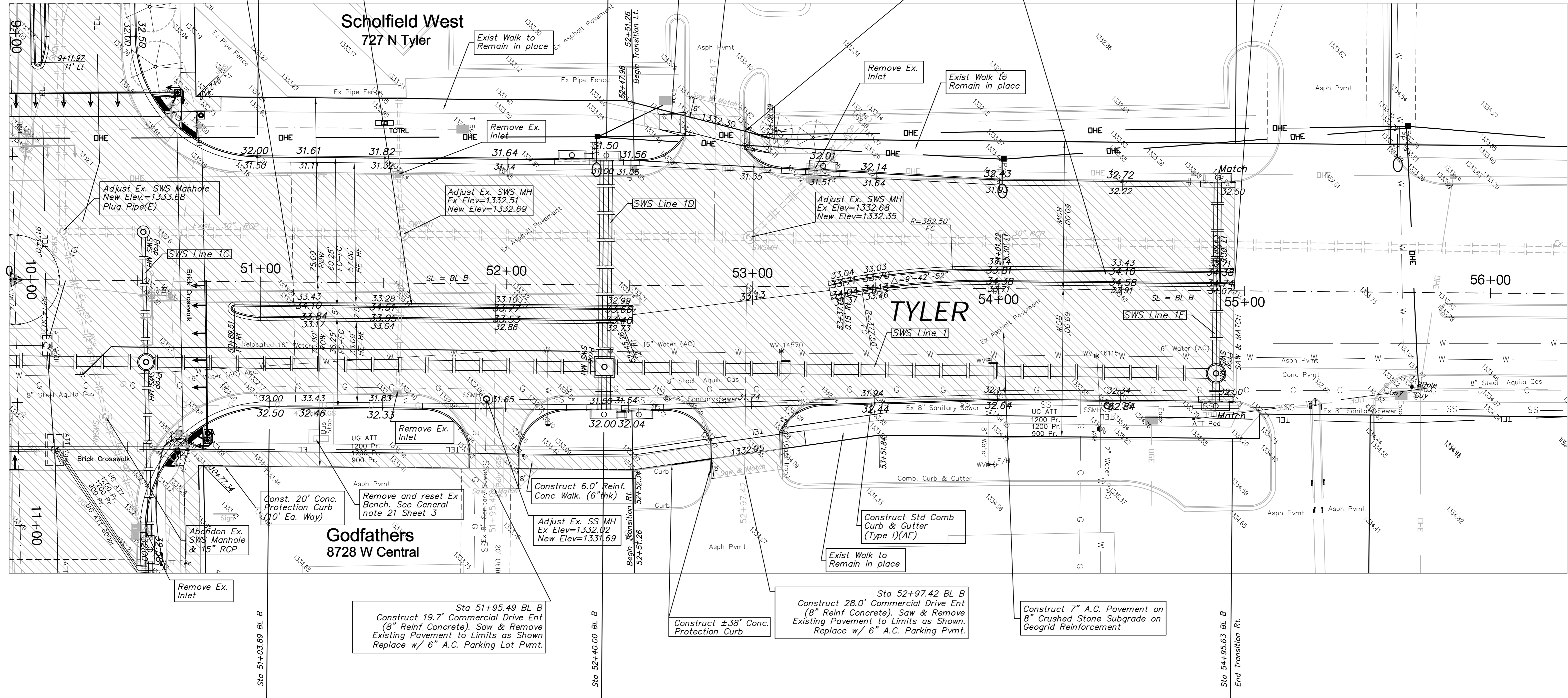

P.V.I.
ELEV. = 1332.50 T.C.
NO V.C.

P.V.I.
ELEV. = 1332.00 T.C.
NO V.C.

P.V.I.
ELEV. = 1333.00 T.C.
NO V.C.

Note:
Trees/Shrubs to be removed are marked thus:

Note:
Pavement, Sidewalks, and Etc. To Be Removed Are Indicated By:

Design: T. Azlere
Drawn: J. F. Bradley
Scale: 1:20

Project No. 05T0E393 CAPITAL IMPROVEMENT PROJECT
TYLER NORTH PAVING
CENTRAL & TYLER INTERSECTION
PAVEMENT, STORM WATER SEWER, TRAFFIC CONTROL IMPROVEMENTS

Baughman Company, P.A.
315 Ellis St. Wichita, KS 67211 P 316-262-7271 F 316-262-0149
ENGINEERING | SURVEYING | PLANNING | LANDSCAPE ARCHITECTURE

MAY 2008
SHEET 10 OF 72