

BENCHMARK:
 BM #5 - COW Benchmark 17.2' South and 48.0' West of the Centerlines of 37th St. North and Hoover Road.
 B.L. Sta. 159+79.1, 16.9' Rt.
 Elev. = 1333.68 (MSL)

Reseed 1100 L.F. According to General Note 19 as Measured Along the Force Main from Sta. 31+00 to Sta. 42+00.

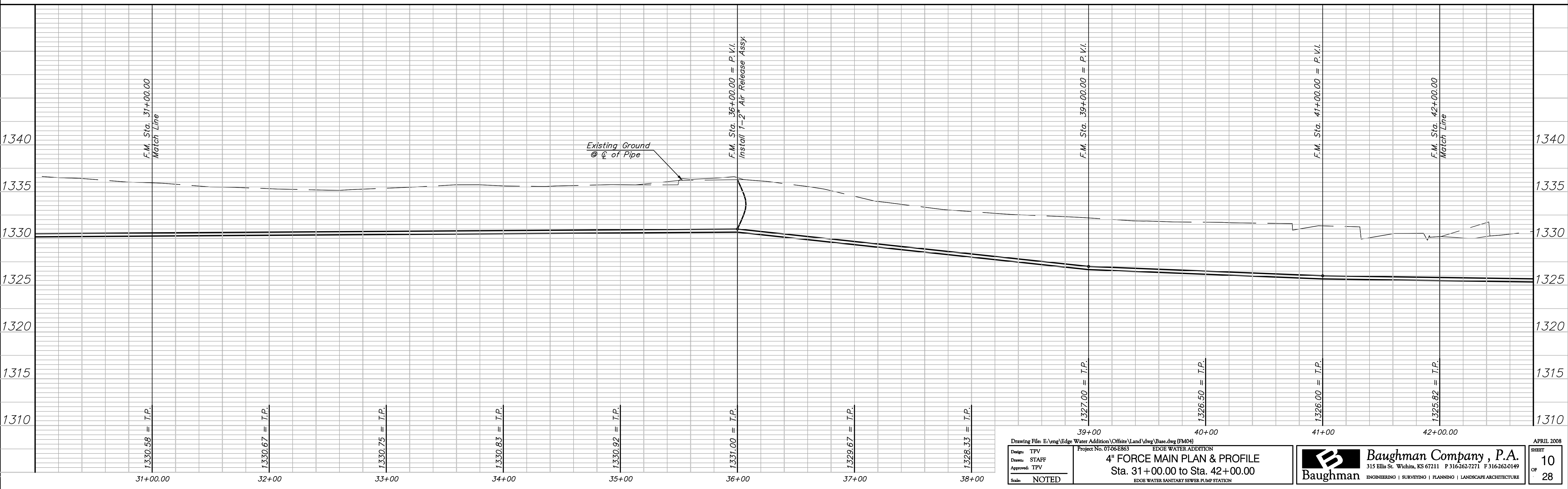
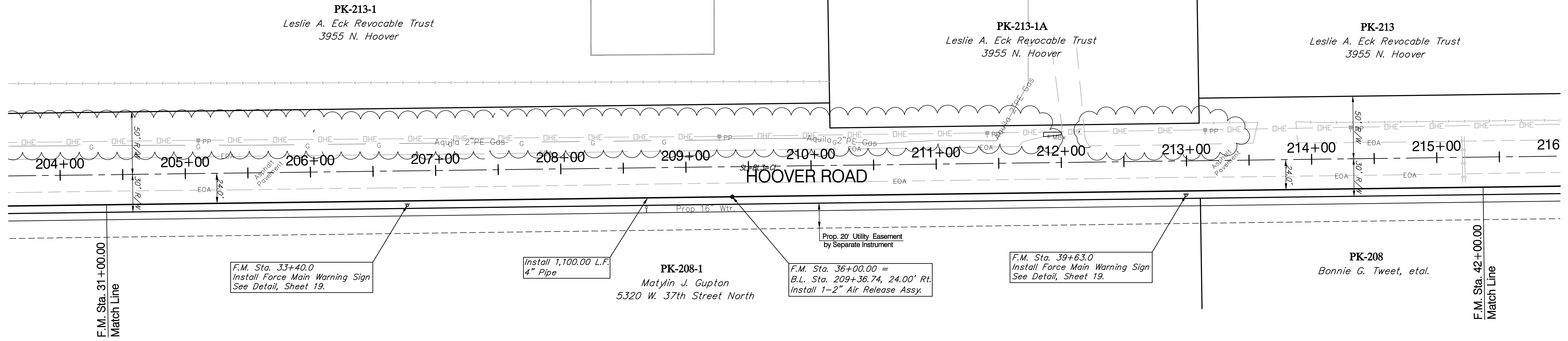
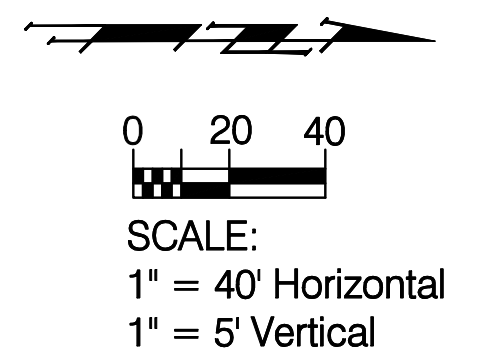

Drawing File: E:\eng\Edge Water Addition\Offsite\Land\dwg\Basc.dwg (FM04) Project No. 07-06-EB63 Design: TPV Drawn: STAFF Approved: TPV Scale: NOTED		EDGE WATER ADDITION 4" FORCE MAIN PLAN & PROFILE Sta. 31+00.00 to Sta. 42+00.00 EDGE WATER SANITARY SEWER PUMP STATION		Baughman Company, P.A. 315 Ellis St. Wichita, KS 67211 P 316-262-7271 F 316-262-0149 ENGINEERING SURVEYING PLANNING LANDSCAPE ARCHITECTURE		APRIL 2008 SHEET 10 OF 28
---	--	--	--	---	--	---