

Scale: 1" = 60'

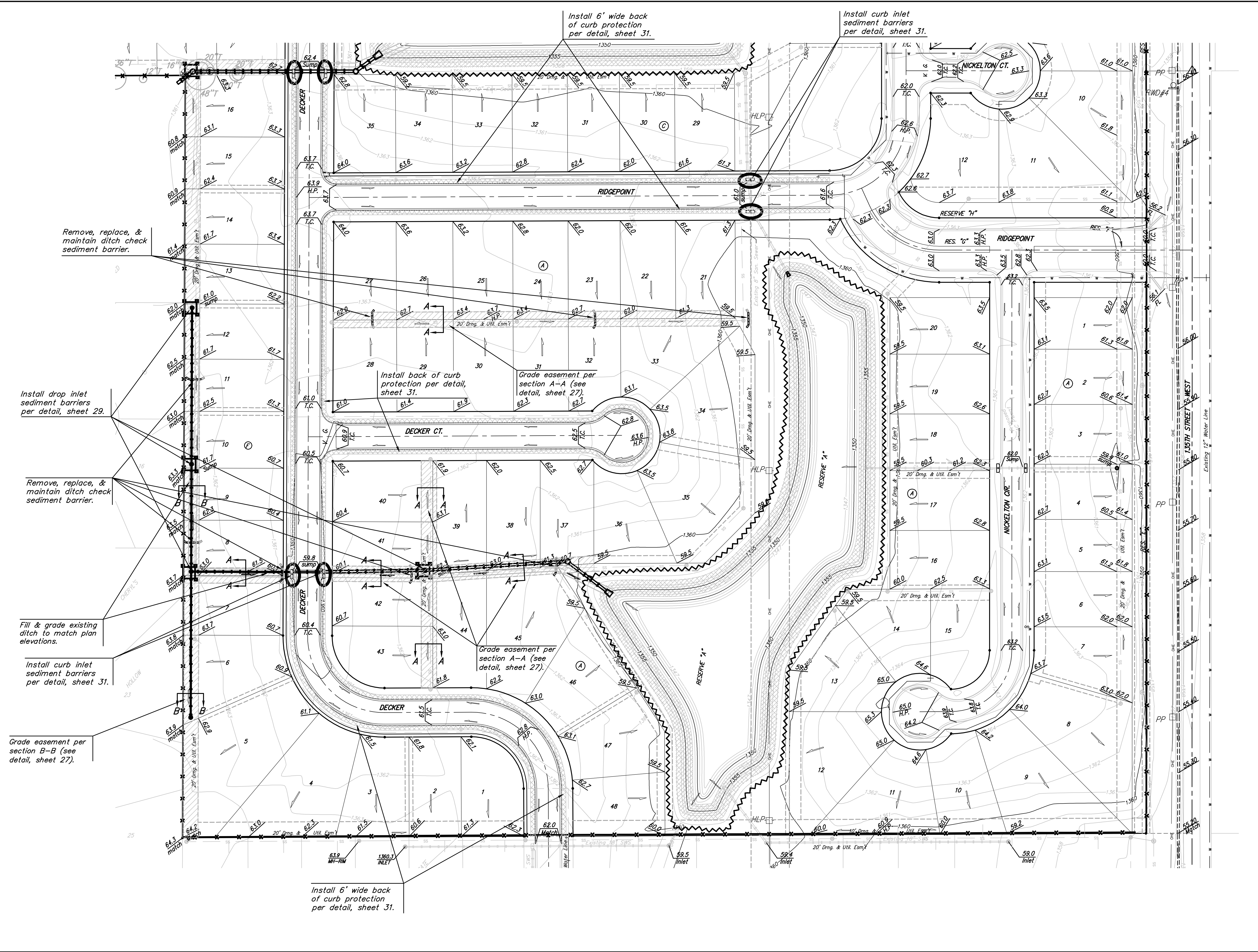

All easements have been graded prior to construction with the mass grading plan, however, hatched easements shall be fine graded with this project after street & sws construction has been completed. All cost associated with the fine grading shall be included in the lump sum bid item "Easement Grading".

Maintain one construction entrance onto existing paved roadway per detail, sheet 31.

EROSION CONTROL PLAN LEGEND
(Installation Details Found in the SWP2 Plan)

- DROP INLET PROTECTION
- CURB INLET PROTECTION
- DITCH CHECKS
- SILT FENCING
- CUT-OFF TRENCH
- BACK OF CURB PROTECTION
- EROSION CONTROL MAT
- TEMPORARY DITCH

NO SCALE

Baughman Engineering | Surveying | Planning | Landscape Architecture

Silverton Addition - Phase II
Easement Grading / Erosion Control Plan
Street & SWS Improvements

PROJECT NUMBER: 472-84460
DESIGN: JAK
DRAWN: JAK/TMS
APPROVED: [Signature]
DATE: 7/14/08

REVISIONS:

SCALE: Noted
SHEET: **26 OF 41**

Silverton\Phase 2\Str_Erosion.dwg 07-10-E955