

BENCHMARK:
CROSS CUT ON NORTH
END OF WEST HEADWALL
137.5' SOUTH & 12' WEST
OF THE INTERSECTION OF
29TH ST N & 127TH ST E.
ELEV. = 1382.45 NAVD88

Q OF WEST EDGE OF
CONCRETE DRIVE 31.4' NE
OF THE EAST 1/4 CORNER
OF SEC. 3, TWP 27-S,
R-2-E.
ELEV. = 1373.82 NAVD88

Scale: 1" = 20'
• = Iron

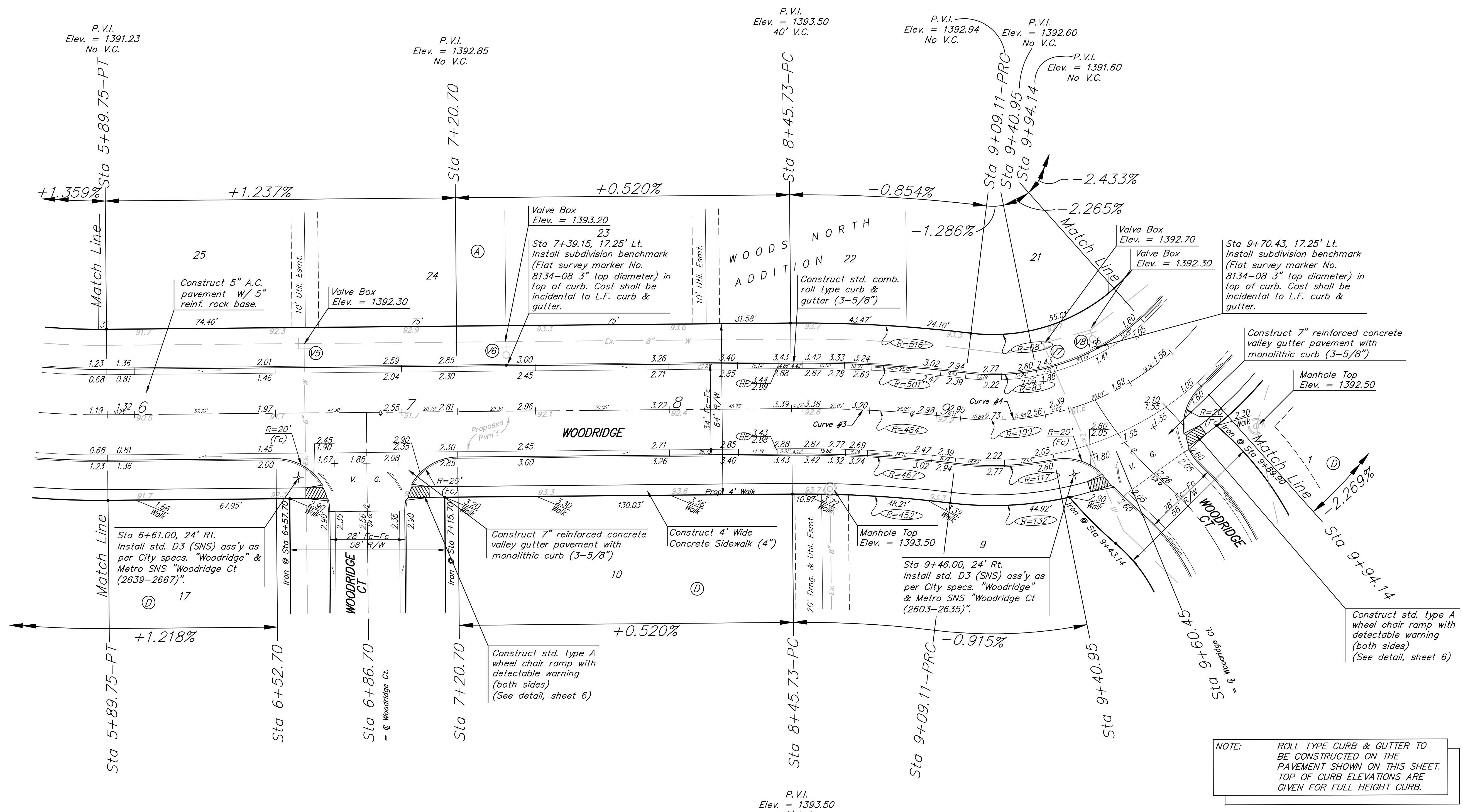

Curve #3
Curve Data Based on Centerline
Rad. = 484' Delta = 7° 30' 10" Tangent = 31.73'
Arc = 63.38' L.C. = 63.33' Def/Ft. = 3.55133 Min.

Station	Arc	FACE CHORD LENGTHS		Defl.	T. Defl.
		8' Lt.	8' Rt.		
8+45.73	-	-	-	0'00"00"	0'00"00"
8+50.00	4.27'	4.49'	4.05'	0'15"10"	0'15"10"
8+75.00	25.00'	26.29'	23.71'	1'28"47"	1'43"57"
9+00.00	25.00'	26.29'	23.71'	1'28"47"	1'43"57"
9+09.11	9.11'	9.58'	8.64'	0'32"21"	3'45"05"

Curve #4
Curve Data Based on Centerline
Rad. = 100' Delta = 83° 36' 58" Tangent = 89.44'
Arc = 145.94' L.C. = 133.33' Def/Ft. = 17.18846 Min.

Station	Arc	FACE CHORD LENGTHS		Defl.	T. Defl.
		8' Lt.	8' Rt.		
9+09.11	-	-	-	0'00"00"	0'00"00"
9+25.00	15.89'	11.90'	19.84'	4'33"07"	4'33"07"
9+40.95	15.95'	11.95'	19.92'	4'34"09"	9'07"17"
9+60.45	19.50'	14.60'	24.34'	5'35"10"	14'42"27"
9+94.14	33.69'	25.15'	41.91'	9'39"05"	24'21"32"
10+00.00	5.86'	4.39'	7.32'	1'40"43"	26'02"15"
10+25.00	25.00'	18.70'	31.17'	7'09"42"	33'11"58"
10+50.00	25.00'	18.70'	31.17'	7'09"42"	40'21"41"
10+55.05	5.05'	3.79'	6.31'	1'26"48"	41'48"29"

NOTE: ROLL TYPE CURB & GUTTER TO BE CONSTRUCTED ON THE PAVEMENT SHOWN ON THIS SHEET. TOP OF CURB ELEVATIONS ARE GIVEN FOR FULL HEIGHT CURB.

Baughman WOODS NORTH ADD. - PH. I
WOODRIDGE
STA 5+89.75 TO STA 9+94.14

Baughman Company, P.A. 315 Ellis St. Wichita, KS 67211 P 316-262-7271 F 316-262-0149
ENGINEERING | SURVEYING | PLANNING | LANDSCAPE ARCHITECTURE

PROJECT NUMBER 41284651	DESIGN JAK	DRAWN TMS
REVISIONS:	APPROVED	DATE 07/08
	SCALE Noted	
	SHEET	9 OF 37

WoodsNorth/Str2 07-10-E964