

BENCHMARK:
 CROSS CUT ON NORTH
 END OF WEST HEADWALL
 137.5' SOUTH & 12' WEST
 OF THE INTERSECTION OF
 29TH ST N & 127TH ST E.
 ELEV. = 1382.45 NAVD88

☉ OF WEST EDGE OF
 CONCRETE DRIVE 31.4' NE
 OF THE EAST 1/4 CORNER
 OF SEC. 3, TWP 27-S,
 R-2-E.
 ELEV. = 1373.82 NAVD88

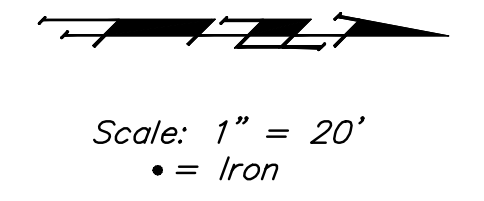

Note: Contractor shall repair and restore any damage to lawn and/or irrigation system within Lot 1, Block B, and Lot 10, Block A, The Fairmont Addition or adjacent street Right-of-Way. Any portion of the lawn damaged during construction shall be replaced with sod.

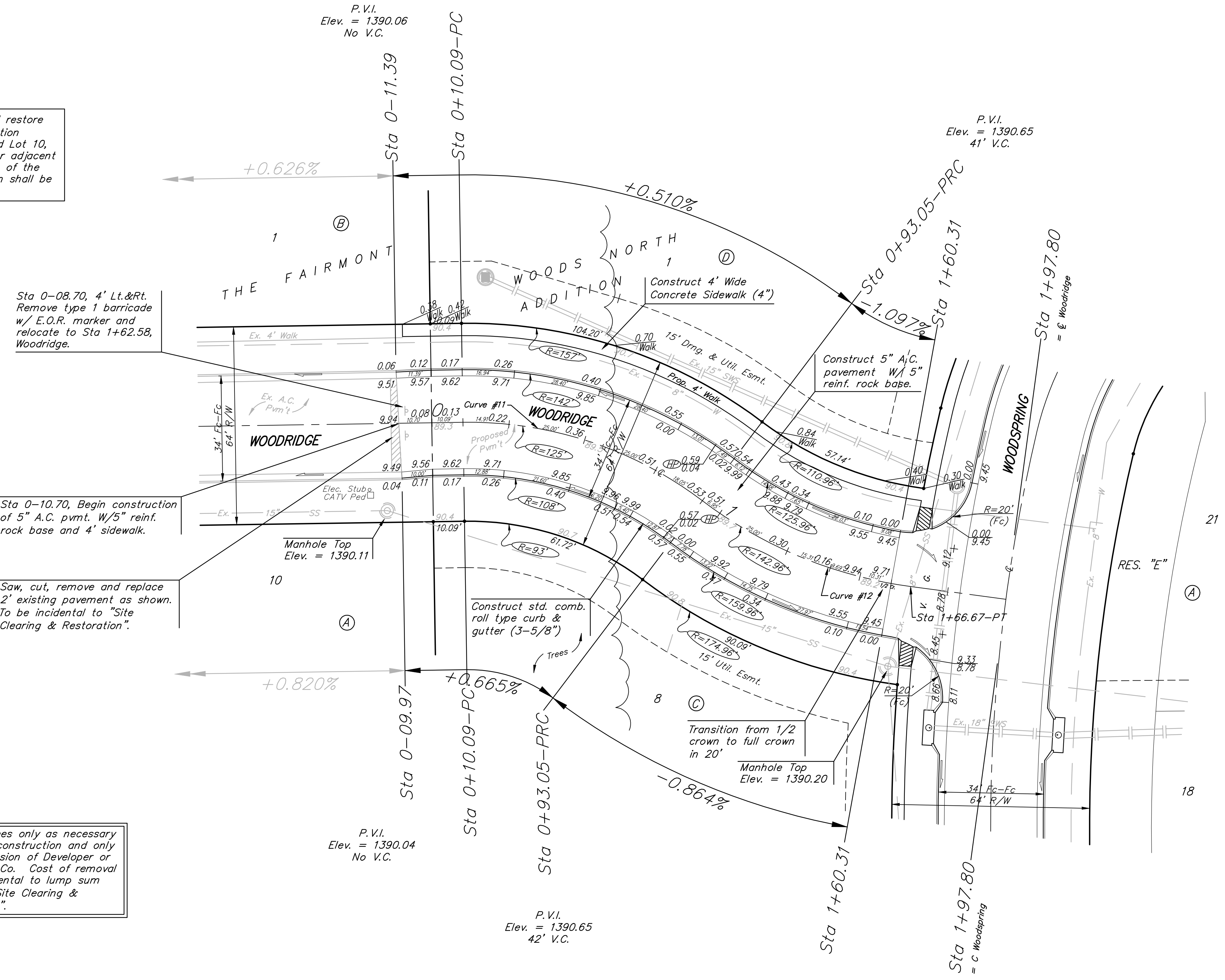

Sta 0+08.70, 4' Lt.&Rt. Remove type 1 barricade w/ E.O.R. marker and relocate to Sta 1+62.58, Woodridge.

Sta 0+10.70, Begin construction of 5" A.C. pvm't. W/5" reinf. rock base and 4' sidewalk.

Saw, cut, remove and replace 2" existing pavement as shown. To be incidental to "Site Clearing & Restoration".

Remove trees only as necessary for street construction and only with permission of Developer or Baughman Co. Cost of removal to be incidental to lump sum bid item "Site Clearing & Restoration".

Curve #11
 Curve Data Based on Centerline
 Rad. = 125', Delta = 38°01'34" Tangent = 43.07'
 Arc = 82.96' L.C. = 81.45' Def/Ft. = 13.75101 Min.

| Station | Arc | FACE CHORD LENGTHS | | Def. | T. Def. |
|---------|--------|--------------------|--------|----------|-----------|
| | | 8' Lt. | 8' Rt. | | |
| 0+10.09 | - | - | - | 0'00"00" | 0'00"00" |
| 0+25.00 | 14.91' | 17.88' | 11.92' | 3'25"01" | 3'25"01" |
| 0+50.00 | 25.00' | 29.95' | 19.97' | 5'43"46" | 9'08"48" |
| 0+75.00 | 25.00' | 29.95' | 19.97' | 5'43"46" | 14'52"34" |
| 0+93.05 | 18.05' | 21.64' | 14.43' | 4'08"12" | 19'00"47" |

Curve #12
 Curve Data Based on Centerline
 Rad. = 142.96' Delta = 29°30'13" Tangent = 37.64'
 Arc = 73.62' L.C. = 72.80' Def/Ft. = 12.02266 Min.

| Station | Arc | FACE CHORD LENGTHS | | Def. | T. Def. |
|---------|--------|--------------------|--------|----------|-----------|
| | | 8' Lt. | 8' Rt. | | |
| 0+93.05 | - | - | - | 0'00"00" | 0'00"00" |
| 1+00.00 | 6.95' | 5.73' | 8.16' | 1'23"33" | 1'23"33" |
| 1+25.00 | 25.00' | 20.60' | 29.33' | 5'00"34" | 6'24"07" |
| 1+50.00 | 25.00' | 20.60' | 29.33' | 5'00"34" | 11'24"41" |
| 1+60.31 | 10.31' | 8.50' | 12.11' | 2'03"52" | 13'28"38" |
| 1+66.67 | 6.36' | 5.25' | 7.47' | 1'16"28" | 14'45"06" |

WATER VALVE LOCATION TABLE

| VALVE NUMBER | STREET | BASELINE STATION | OFFSET DISTANCE | OFFSET DIRECTION |
|--------------|---------------|------------------|-----------------|------------------|
| V1 | Woodridge | 1+53.69 | 28.20' | Rt. |
| V2 | Woodridge | 1+84.43 | 27.48' | Rt. |
| V3 | Woodridge | 3+69.62 | 26' | Rt. |
| V4 | Woodridge | 3+78.39 | 26' | Rt. |
| V5 | Woodridge | 6+63.60 | 26' | Lt. |
| V6 | Woodridge | 7+39.15 | 26' | Lt. |
| V7 | Woodridge | 9+71.44 | 26' | Lt. |
| V8 | Woodridge | 9+46.90 | 26' | Lt. |
| V9 | Woodspring | 10+82.72 | 26' | Lt. |
| V10 | Woodspring | 14+14.80 | 26' | Lt. |
| V11 | Woodspring | 14+95.91 | 26' | Lt. |
| V12 | Woodspring | 17+79.16 | 40' | Lt. |
| V13 | Woodridge Ct. | 0+26.22 | 39.73' | Rt. |
| V14 | Woodridge Ct. | 0+26.71 | 39.73' | Rt. |
| V15 | Woodridge Ct. | 0+17.12 | 39.73' | Rt. |
| V16 | Davin/Garnett | 6+98.92 | 23' | Rt. |

Paving contractor will be responsible to operate all water valves on the project, in the presence of the inspector, to ensure accessibility to the valves, and that all valves are left in the "ON" position when the project is completed.

NOTE: ROLL TYPE CURB & GUTTER TO BE CONSTRUCTED ON THE PAVEMENT SHOWN ON THIS SHEET. TOP OF CURB ELEVATIONS ARE GIVEN FOR FULL HEIGHT CURB.

Baughman

ENGINEERING | SURVEYING | PLANNING | LANDSCAPE ARCHITECTURE

WOODRIDGE

WOODS NORTH ADD. - PH. I

STA 0+00 TO STA 1+97.80

PROJECT NUMBER
41284651

DESIGN
JAK

DRAWN
TMS

REVISIONS:

APPROVED

DATE
07/08

SCALE
Noted

SHEET

15 OF 37

WoodNorth/Std8

07-10-E964