

**Benchmark:**  
 "□" Cut On Top of Curb, West Side of Forestview, East of Fire Hydrant, and Along Easterly Extension of the South Line of Lot 2, Block A, Liberty Park 2nd Addition.  
 Elev. = 1347.62 NGVD29

City of Wichita Benchmark Southwest Corner of 13th ST N and 135th ST W 30' South and 35' West Intersection. East Side of Concrete Base for Highline Pole.  
 Elev. = 1355.65 NGVD29

Subdivision Bench Marks		
Street & Station	Location Description	Elevation
N. Liberty St. 4+29.46, 17.25' Lt.	Adjacent to Fire Hydrant at S. End of S.W. Curb Return of N. Liberty St. & W. Hunters View St.	
W. Hunters View St. 4+75.37, 14.25' Rt.	Adjacent to Fire Hydrant adjacent to Lots 9 & 10, Block A.	
W. Hunters View St. 9+30.93, 14.25' Rt.	Adjacent to Fire Hydrant adjacent to Lots 17 & 18, Block A.	
W. Hunters View St. 13+51.93, 14.25' Rt.	Adjacent to Fire Hydrant adjacent to Lots 24 & 25, Block A.	
W. Nantucket St. 18+90.31, 14.25' Rt.	Adjacent to Fire Hydrant adjacent to Lots 35 & 36, Block A.	

P.V.I.  
 Elev. = 1353.49  
 No V.C.

P.V.I.  
 Elev. = 1353.90  
 No V.C.

P.V.I.  
 Elev. = 1353.90  
 No V.C.

Scale: 1" = 20'  
 • = Iron

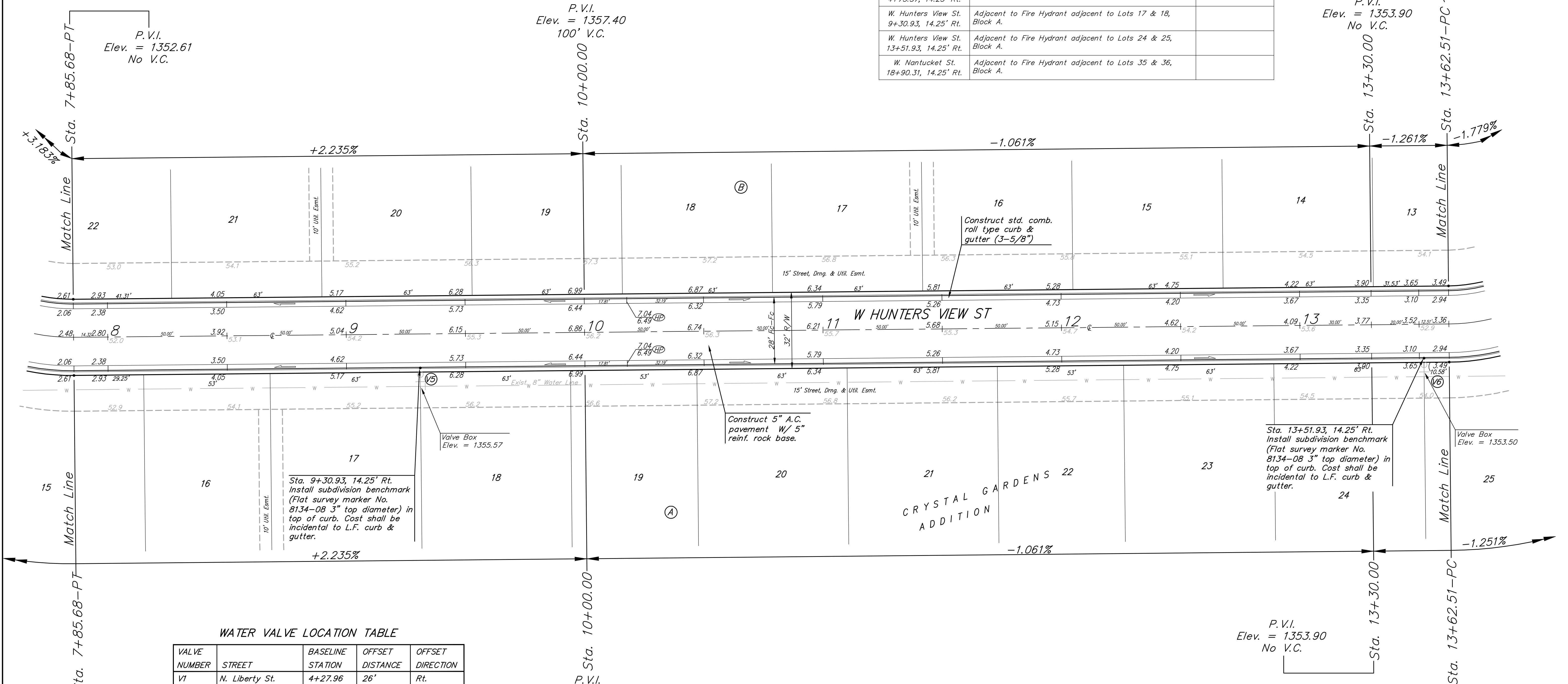

WATER VALVE LOCATION TABLE

VALVE NUMBER	STREET	BASELINE STATION	OFFSET DISTANCE	OFFSET DIRECTION
V1	N. Liberty St.	4+27.96	26'	Rt.
V2	W. Hunters View St.	0+26.14	54.22'	Lt.
V3	W. Hunters View St.	0+57.40	22'	Rt.
V4	W. Hunters View St.	4+75.37	22'	Rt.
V5	W. Hunters View St.	9+30.93	22'	Rt.
V6	W. Hunters View St.	13+51.93	22'	Rt.
V7	W. Nantucket St.	18+90.31	22'	Rt.

Paving contractor will be responsible to operate all water valves on the project, in the presence of the inspector, to ensure accessibility to the valves, and that all valves are left in the "ON" position when the project is completed.

NOTE: ROLL TYPE CURB & GUTTER TO BE CONSTRUCTED ON THE PAVEMENT SHOWN ON THIS SHEET. TOP OF CURB ELEVATIONS ARE GIVEN FOR FULL HEIGHT CURB.

	Crystal Gardens Addition	
	<b>W. HUNTERS VIEW ST.</b>	
STA. 7+85.68 TO STA. 13+62.51		
<small>Baughman Company, P.A. 315 Ellis St. Wichita, KS 67211 P 316-262-7271 F 316-262-0149          ENGINEERING   SURVEYING   PLANNING   LANDSCAPE ARCHITECTURE</small>		
PROJECT NUMBER 472-84606	DESIGN JAK	DRAWN TMS
REVISIONS:	APPROVED	DATE 9/09/08
	SCALE Noted	SHEET
		<b>9 OF 34</b>