

| DRAINAGE STRUCTURE SCHEDULE | | | | | | | | | | | |
|-----------------------------|-------------------|----------|---------------|-----------------------|------------------------------|-------------------------------|---------------|----------|-----------|-------------|---------------------|
| STRUCTURE NUMBER | STRUCTURE | TOP OF | DISTAL NUMBER | PIPE SIZE & DIRECTION | PIPE IN (IN/DIR) & DIRECTION | PIPE OUT (IN/DIR) & DIRECTION | DRAINAGE AREA | CFS | TOTAL CFS | PIPE NUMBER | PIPE LENGTH & SLOPE |
| SC1 | DROP INLET | CONCRETE | D316 | 18" DIA. 15' RCP | | | 1346.71 | 0.72 AC. | 4.37 | SC1 | 139 LF @ 1.00% |
| SD1 | DROP INLET | CONCRETE | D316 | 18" DIA. 15' RCP | | | 1346.80 | 0.97 AC. | 9.21 | SD1 | 189 LF @ 1.00% |
| SE1 | DOUBLE CURB INLET | CONCRETE | D317 | 24" DIA. 24' RCP | | | 1346.81 | 0.36 AC. | 0.94 | SE1 | 137 LF @ 1.00% |
| SE2 | CAP BUILDUP | | | | | | 1346.30 | 3.96 AC. | 26.30 | SE2 | 64 LF @ 0.50% |

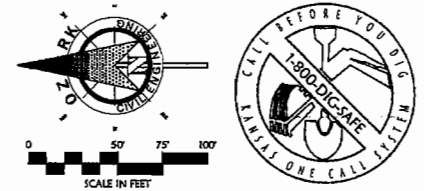

BENCHMARK
 City of Wichita Disc on the northwest corner of 29th St. N. and Maize Rd.
 Elevation = 1349.32 (M.S.L.)
 Elevation = 161.92 (City Datum)

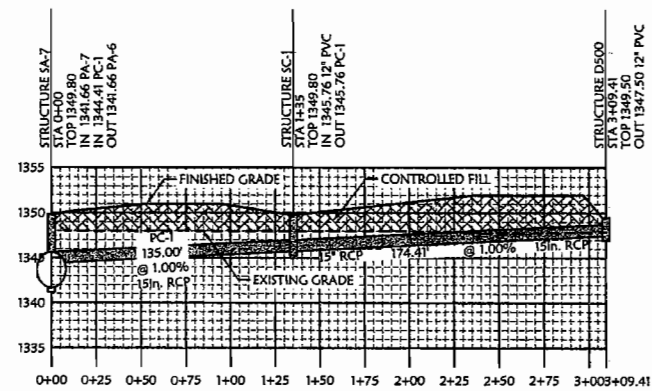
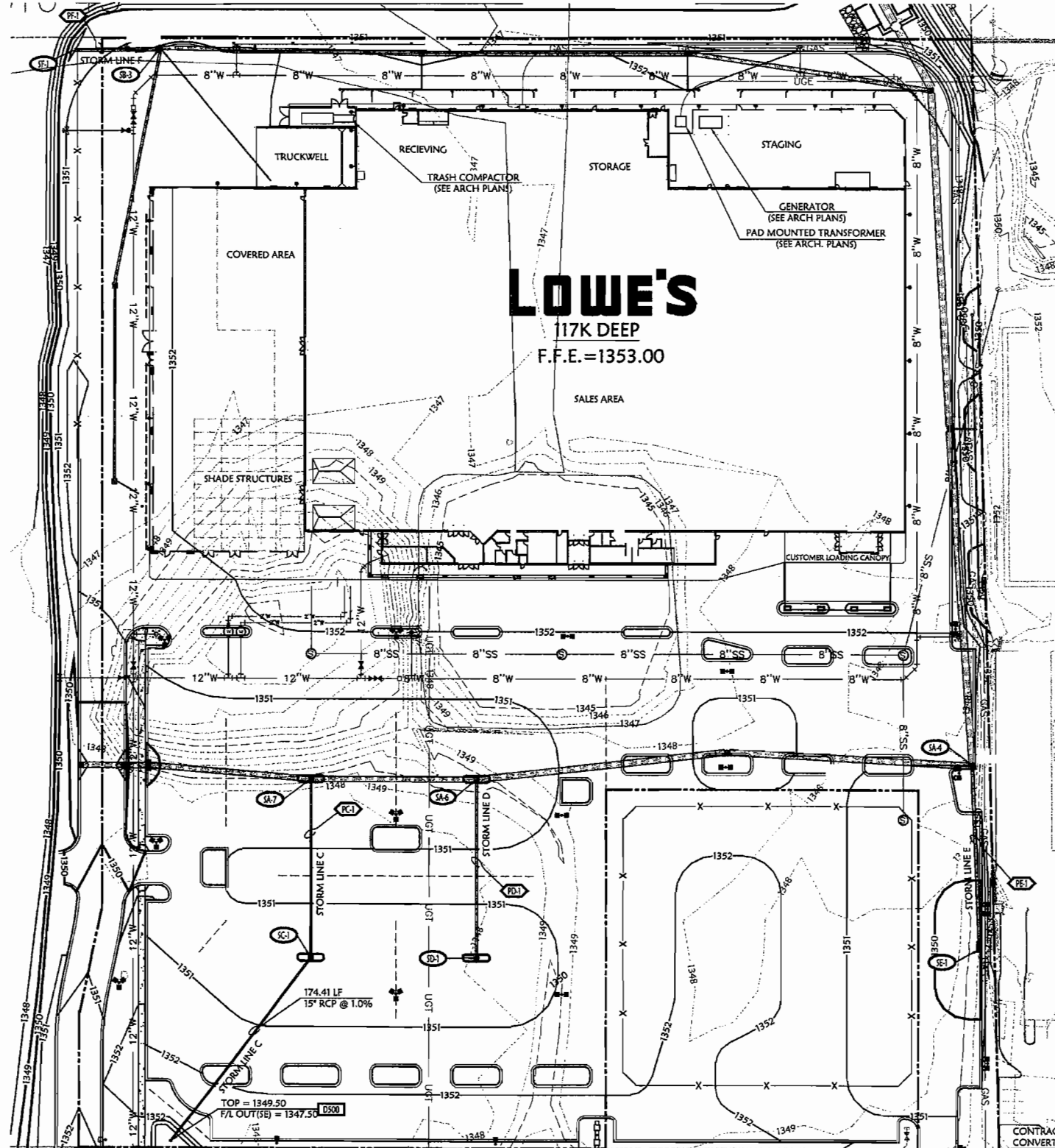

STORM SEWER PROFILE C
 VERTICAL SCALE: 1"=5'
 HORIZONTAL SCALE: 1"=50'

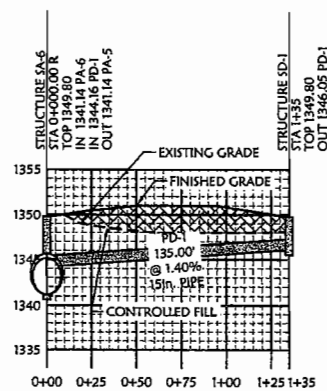

STORM SEWER PROFILE D
 VERTICAL SCALE: 1"=5'
 HORIZONTAL SCALE: 1"=50'

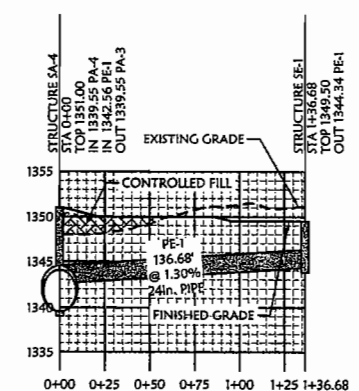

STORM SEWER PROFILE E
 VERTICAL SCALE: 1"=5'
 HORIZONTAL SCALE: 1"=50'

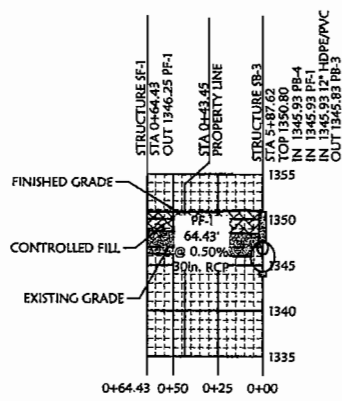

STORM SEWER PROFILE F
 VERTICAL SCALE: 1"=5'
 HORIZONTAL SCALE: 1"=50'

| GRADING PROPOSED FEATURES | |
|---------------------------|--|
| --- | BOUNDARY LINE |
| --- | RIGHT OF WAY LINE |
| --- | EASEMENT LINE |
| --- | CONCRETE CURB AND CUTTER |
| X | FENCE |
| --- | GUARD RAIL |
| --- | SANITARY SEWER SERVICE |
| --- | WATER SERVICE |
| --- | UNDERGROUND ELECTRIC SERVICE |
| --- | UNDERGROUND TELEPHONE SERVICE |
| --- | OVERHEAD ELECTRIC SERVICE |
| --- | OVERHEAD TELEPHONE SERVICE |
| --- | FIBER OPTIC CABLE SERVICE |
| --- | GAS SERVICE |
| X | SPOT ELEVATIONS |
| X | TO-TOP OF CURB |
| X | C-CENTER OF CURB |
| X | TO-TOP OF GRADE (BEHIND TOP OF WALL) |
| X | TO-TOP OF GRADE (AT FRONT OF WALL) |
| X | HEIGHT POINT |
| X | UP-LOW POINT |
| X | END OF PAVEMENT |
| X | FEI-FLARED END SECTION |
| X | RIP-RAP PAD (SEE EROSION PLANS FOR SIZE) |
| X | SANITARY SEWER MANHOLE |
| X | FIRE HYDRANT WITH GUARD POSTS |
| X | UTILITY POLE |
| X | WATER LINE TEE, BEND, VALVE, AND PLUG |

| GRADING DETAILS | |
|-----------------|---|
| D316 | FRENCH DRAIN DETAIL |
| D319 | CLEANOUT DETAIL |
| D500 | CITY OF WICHITA, KANSAS DROP-INLET DETAIL |
| VTX | VORTECHS STORM/WATER TREATMENT SYSTEM |

GRADING AND DRAINAGE NOTES:

INFORMATION PERTAINING TO UNDER GRADE UTILITIES WAS OBTAINED FROM AVAILABLE RECORDS AND FIELD LOCATIONS WHEN POSSIBLE. THE CONTRACTOR MUST DETERMINE THE EXACT LOCATION AND DEPTH OF ALL EXISTING UTILITIES BY DIGGING TEST PITS BY HAND AT ALL UTILITY CROSSINGS IN ADVANCE OF MACHINE TRENCHING. IF CLEARANCE IS LESS THAN SPECIFIED ON THESE PLANS OR IF INTERFERENCES OCCUR, CONTACT THE ENGINEER AND THE OWNER/DEVELOPER PRIOR TO PROCEEDING WITH CONSTRUCTION.

ALL STRUCTURES LOCATED WITHIN R.O.W. OR OTHERWISE NOTED ON THESE PLANS SHALL BE CONSTRUCTED PER THE HIGHEST APPLICABLE STANDARD. IF STRUCTURES ARE NOT IDENTICAL OR CONSTRUCTION CANNOT BE ACHIEVED, CONTRACTOR SHALL SUBMIT SHOP DRAWINGS TO OBTAIN CIVIL ENGINEER'S REVIEW AND APPROVAL.

WHERE THE WROTE PIPE IS USED ON THESE PLANS, THE CONTRACTOR HAS THE OPTION TO SUBMIT MATERIAL WITH A DIFFERENT SLOPE.

CONTRACTOR SHALL BE RESPONSIBLE FOR RELOCATION OR REMOVAL OF EXISTING UNDERGROUND UTILITIES SHOWN OR NOT SHOWN AT NO ADDITIONAL COST TO THE OWNER.

CONTRACTOR SHALL COORDINATE WITH UTILITY COMPANIES ON ADJUSTING EXISTING UTILITY LINE AS REQUIRED BY CUT AND FILL AT NO ADDITIONAL COST TO THE OWNER.

CONTRACTOR SHALL BE FIELD RESPONSIBLE FOR THE DESIGN AND SUPERVISION OF SHEETING, DRAINING, BRACING AND PRELIMINARY EXCAVATION MEASUREMENTS TO FEDERAL, STATE AND LOCAL REGULATIONS PURSUANT TO THE INSTALLATION OF THE WORK INDICATED ON THESE DRAWINGS.

ALL STORM DRAIN PIPES ARE MEASURED FROM CENTER OF STRUCTURES AND END OF FINISHED END SECTION. RETAINING WALLS SHALL BE CONSTRUCTED TO EXTEND A MINIMUM OF 6 INCHES ABOVE THE TOP OF FINISHED GRADE. CONTRACTOR SHALL REFER TO THE RETAINING WALL PLANS FOR CONSTRUCTION AND DESIGN SPECIFICATIONS. CONTRACTOR SHALL NOTIFY OWNER CIVIL ENGINEERING, INC. IF RETAINING WALL PLANS DIFFER FROM THESE.

ALL DISTURBED AREAS AND ROADS SHALL BE GRADED SMOOTH AND 4" OF TOP SOIL APPLIED. THE AREA SHALL BE SEEDED AND MAINTAINED UNTIL HARDY GRASS GROWTH HAS BEEN ESTABLISHED. (SEE LANDSCAPING GENERAL NOTES FOR SEEDING SPECIFICATIONS)

STORM DRAIN PIPE BEDDING SHALL BE INSTALLED PER DETAIL D316 (SEE DETAIL SHEETS)

SEE EROSION CONTROL PLAN FOR RIP-RAP PAD SIZE.

CONTRACTOR SHALL CONTACT AND MAINTAIN ALL EROSION AND RECONSTRUCTION CONTROL PRACTICES IN ACCORDANCE WITH THE EROSION CONTROL PLAN AND RECONSTRUCTION SCHEDULE. CONTRACTOR SHALL ALSO BE RESPONSIBLE FOR IMPLEMENTING THE EROSION CONTROL PLAN.

REMOVE GOOD TOPSOIL FROM AREAS TO BE GRADED AND FILL, AND PRESERVE FOR USE IN FINISHING THE GRADING OF ALL CRITICAL AREAS.

SOILS ARE TO BE TESTED TO A MINIMUM DEPTH OF 8 INCHES BEFORE PLACING TOPSOIL PER OWNER/DEVELOPER, CITY AND/OR HIGHWAY DEPARTMENT STANDARDS AND SPECIFICATIONS.

CLEAR AND GRUB AREAS TO BE FILLED, REMOVE TREE VEGETATION, ROOTS, OR OTHER DEBRIS AND OTHER MATERIALS THAT WOULD AFFECT THE STABILITY OF THE FILL.

ENSURE THAT FILL MATERIAL IS FREE OF BRUSH, RUBBER, BODIES, LOGS, STUMPS, BUILDING DEBRIS, AND OTHER MATERIALS INAPPROPRIATE FOR CONSTRUCTION OF FILL.

DO NOT INCORPORATE FRESH MATERIAL OR SOFT, MOIST, OR HIGHLY COMPRESSIBLE MATERIALS INTO FILL ROADS.

KEEP DIVERSIONS AND OTHER WATER CONVEYANCE MEASURES FREE OF SEDIMENT DURING ALL PHASES OF DEVELOPMENT.

PERMANENTLY STABILIZE ALL GRADED AREAS AFTER FINAL GRADING IS COMPLETED ON EACH AREA OF THE GRADING PLAN. APPLY TEMPORARY STABILIZATION MEASURES ON ALL GRADED AREAS WHEN WORK IS TO BE INTERRUPTED OR DELAYED (SEE EROSION CONTROL PLAN).

CONTRACTOR SHALL MATCH TOP OF PROPOSED DRAINAGE STRUCTURE WITH PROPOSED GRADE. IF A DISCREPANCY OCCURS BETWEEN PROPOSED GRADES AND PROPOSED STRUCTURE TOPS, THE GRADING SHALL CONTROL. IF THE DISCREPANCY IS MORE THAN 4 INCHES THE CONTRACTOR SHALL CONTACT THE ENGINEER OF RECORD.

ALL UTILITIES, INCLUDING STORM SEWER, SHOWN WITHIN PUBLIC EASEMENTS OR RIGHT OF WAYS SHALL BE CONSTRUCTED TO THE GOVERNING AGENCY'S SPECIFICATIONS. ALL OTHER UTILITIES SHALL BE CONSTRUCTED TO THE CLIENTS OR THE GOVERNING AGENCY'S SPECIFICATIONS, WHICHEVER IS MORE FAVORABLE. IF THERE IS A QUESTION AS TO WHICH SPECIFICATIONS SHOULD APPLY, THE CONTRACTOR SHALL CONTACT THE ENGINEER OF RECORD.

ALL EXISTING STRUCTURES, UNLESS OTHERWISE NOTED TO REMAIN, ALL FENCING, TREES, ETC., WITHIN CONSTRUCTION AREA SHALL BE REMOVED & DISPOSED OF OFF SITE. UNLESS OTHERWISE NOTED, ANY REMOVAL OF SITE SHALL BE SUBJECT TO LOCAL ORDINANCES AND/OR THE OWNER/DEVELOPER'S STANDARDS AND SPECIFICATIONS. (SEE DEMOLITION PLAN)

ALL DRAINAGE STRUCTURES SHALL BE PRECAST.

CONTRACTOR SHALL NOTIFY ALL UTILITY COMPANIES HAVING UNDERGROUND UTILITIES ON LOT OR IN RIGHT-OF-WAY PRIOR TO EXCAVATION. CONTRACTOR SHALL CONTACT UTILITY LOCATING COMPANY STATE-WIDE CALL CENTER AND LOCATE ALL UTILITIES PRIOR TO EXCAVATION.

SITE GRADING SHALL NOT PROCEED UNTIL EROSION CONTROL MEASURES HAVE BEEN INSTALLED.

AFTER PERMITS HAVE BEEN OBTAINED & EROSION CONTROL MEASURES INSTALLED, THE CONTRACTOR SHALL GRADE BUILDING PADS, GARDEN CENTERS & APPLICABLE TO 1" TO 12" OF BURGANDY AS PER SECTION 02100, DIVISION 2 OF LOWES STANDARD SITE SPECIFICATIONS.

IMMEDIATELY APPLY A CONCRETE STONE BASE FOR BUILDING PADS TO 4" TO 12" PRIOR TO EXCAVATING INTERIOR & EXTERIOR FOOTING.

FRENCH DRAINS SHALL BE INSTALLED IF DIRECTED BY THE GEOTECHNICAL ENGINEER OR AS SHOWN ON PLANS PER DETAIL D316. (SEE DETAIL SHEETS)

GENERAL CONTRACTOR SHALL PROVIDE 2" x 2" x 4" THICK CONCRETE APRON AT ALL CLEANOUTS/OUTLETS OF BUILDING AND DR PAVED AREAS.

ALL ROOF DRAINS TO BUILDING SHALL END OUTSIDE THE BUILDING LIMITS AND SHALL BE PROVIDED WITH A TEMPORARY FLAG AT THE END. SEE ARCH PLAN FOR EXACT END LOCATION AND SLOPE OF DRAIN.

ALL WORK TO BE DONE IN STRICT ACCORDANCE WITH DIVISION 2 OF LOWES STANDARD SITE SPECIFICATIONS.

| REVISIONS | |
|-----------|-------------|
| DATE | DESCRIPTION |
| 4-08-08 | REVISION 2 |
| 5-12-08 | REVISION 3 |

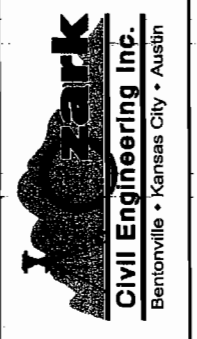
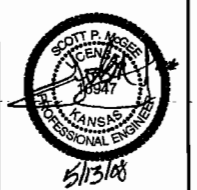

LOWE'S HOME CENTERS, INC.
 1605 CURTIS BRIDGE ROAD
 REEC DOCK
 WILKESBORO, NC 28697
 336.658.4000 (V) 336.658.3257 (F)

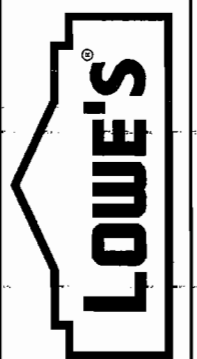

STORM SEWER PLAN & PROFILE
STORM RUNS C, D, E & F
LOWE'S OF
N.W. WICHITA
 MAIZE RD. & CENTRAL PARK ST.
 WICHITA, KS.
 PROJECT NO: 04-060
 DRAWN BY: JG
 CHECKED BY: JG

ORIGINAL ISSUE DATE:
 PERMIT SET ISSUE DATE:
 CONSTRUCTION SET ISSUE DATE: 8-17-07
DRAWING NUMBER:
8.6