

STATE	PROJECT NO.	YEAR	SHEET NO.	TOTAL SHEETS
KANSAS	87 N-0357-01	2008	6	185

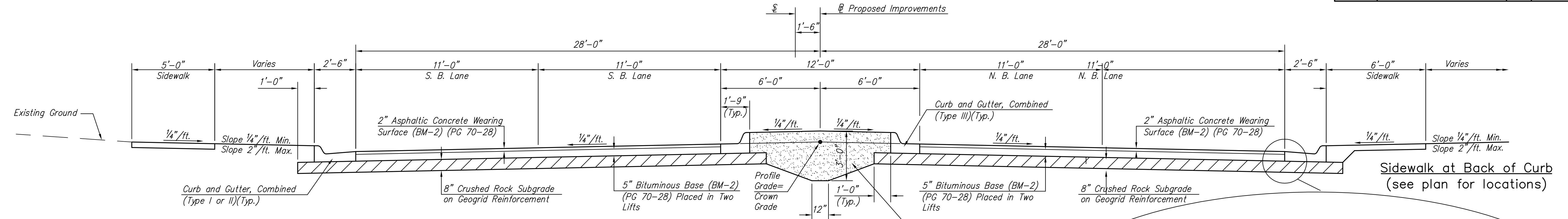

TYPICAL SECTION IV
Sta. 17+58.46 to Sta. 26+93.95
Sta. 31+26.97 to Sta. 32+84.12

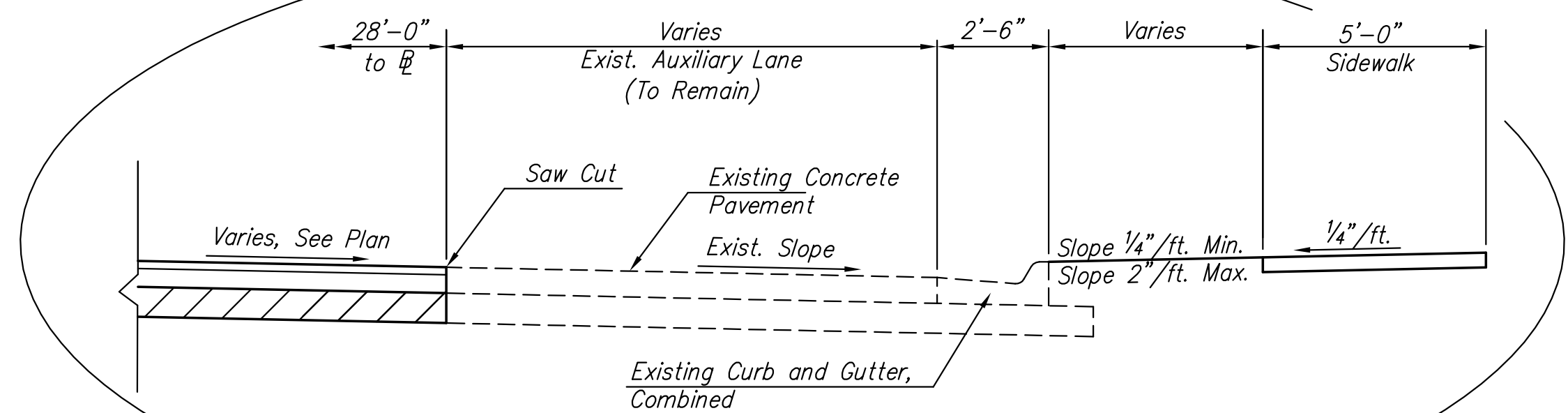

SUBSECTION TO TYPICAL SECTION III & IV
(abutting Exist. Lane)
Sta. 24+15.79 to Sta. 27+85.75

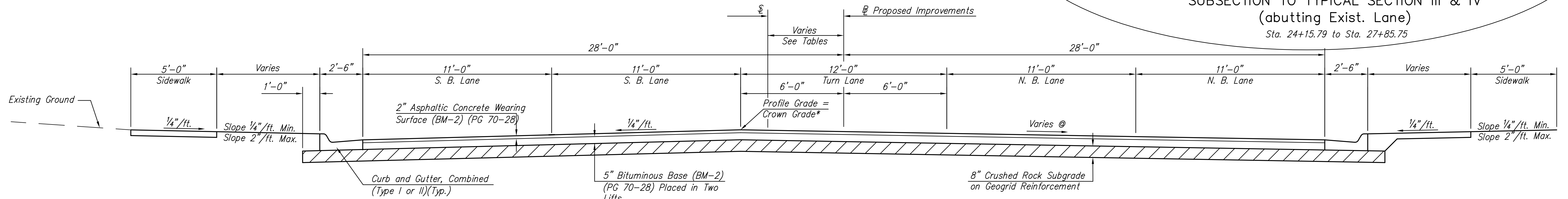

TYPICAL SECTION V
Sta. 34+33.43 to Sta. 35+89.41
Sta. 40+39.96 to Sta. 53+25.00

- * Crown grade distance varies off of Baseline from 0'-0" at Sta. 34+33.43 to 6'-0" at Sta. 35+07.56
- * Crown grade distance varies off of Baseline from 6'-0" at Sta. 52+50.00 to 0'-0" at Sta. 53+25.00
- @ Cross slope varies from 1/4"/ft. at Sta. 42+75.00, Rt. to 3/8"/ft. at Sta. 43+25.00, Rt.
- @ Cross slope is 3/8"/ft. from Sta. 43+25.00 to Sta. 52+50.00
- @ Cross slope varies from 3/8"/ft. at Sta. 52+50.00, Rt. to 1/4"/ft. at Sta. 53+25.00, Rt.

Sidewalk at Back of Curb
(see plan for locations)

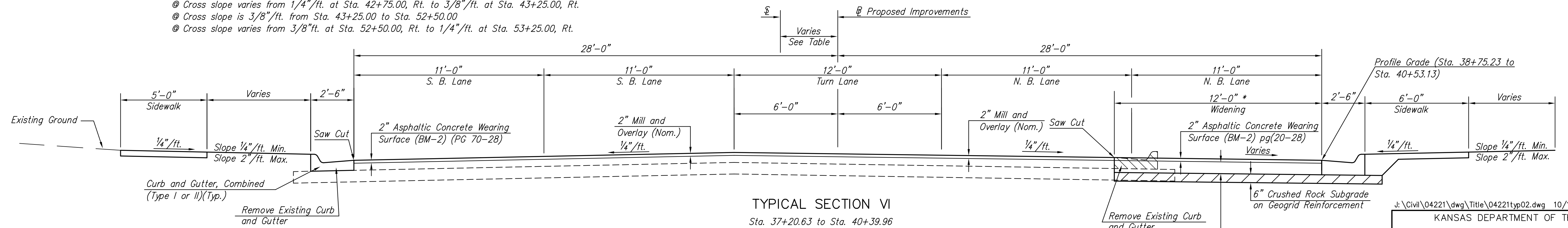

TYPICAL SECTION VI
Sta. 37+20.63 to Sta. 40+39.96

* Widening varies from 0'-0" at Sta. 38+75.23, Rt. to 12'-0" at Sta. 40+39.96, Rt.

Sidewalk at Back of Curb
(see plan for locations)

J:\Civil\04221\dwg\Title\04221typ02.dwg 10/19/2007 10:15:15 AM CST
KANSAS DEPARTMENT OF TRANSPORTATION
**OLIVER IMPROVEMENTS
TYPICAL SECTIONS**
PROJECT NO. 87 N-0357-01 SEDWICK CO.
M K E C ENGINEERING CONSULTANTS, INC.
WICHITA, KANSAS

DESIGNED BY: LAC	CHECKED BY: JRA
DRAWN BY: WNUJ	DATE: 4/07/05

SHEET 6 OF 185