

# 45th Street N. Paving

## Phase 1 Ridge Road to Cimarron Street

Project No.  
472-84587

O.C.A. No.  
766224

Tied with

## Phase 2 Cimarron Street to Hoover Street

Project No.  
472-84588

O.C.A. No.  
766225

CITY OF WICHITA, KANSAS

James L. Armour, P.E. City Engineer

November, 2008

### Final Plans

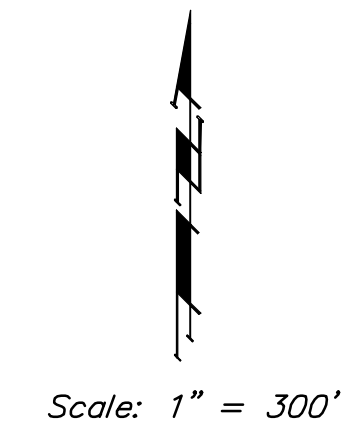

### Benchmarks

- BM #1: Hoover and 45th St. North - COW Benchmark at NE Corner of Intersection, 10.20' SSE of PP, 58.80' ESE of PP on NW corner, 85.50' NE of gas line marker, 59.00' North of gas line marker, 28.50' East of Centerline, 14.50' North of Centerline. Elev. = 1335.29 (NGVD 29)
- BM #2: Small RR spike in 3rd PP West of Hoover St. on the North side of 45th St. N. Elev. = 1337.68
- BM #3: PK Nail in PP 2140' East of Ridge Rd. on the North side of 45th St. N. Elev. = 1338.70

Sta 1+40.90  
Begin Project  
Phase 1

Sta 34+50.00  
End Project  
Phase 1  
Begin Project  
Phase 2

Sta 54+25.00  
End Project  
Phase 2

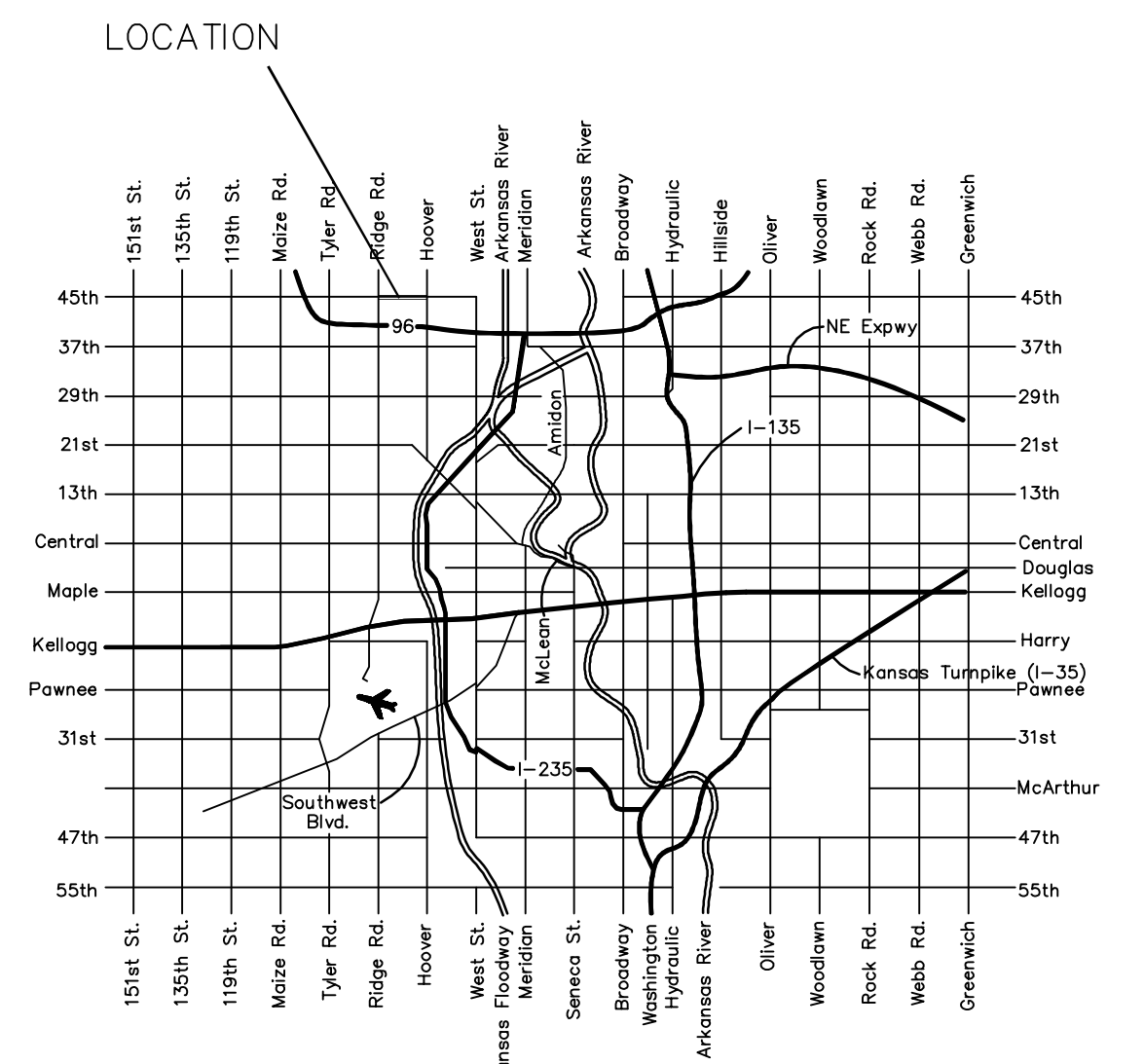
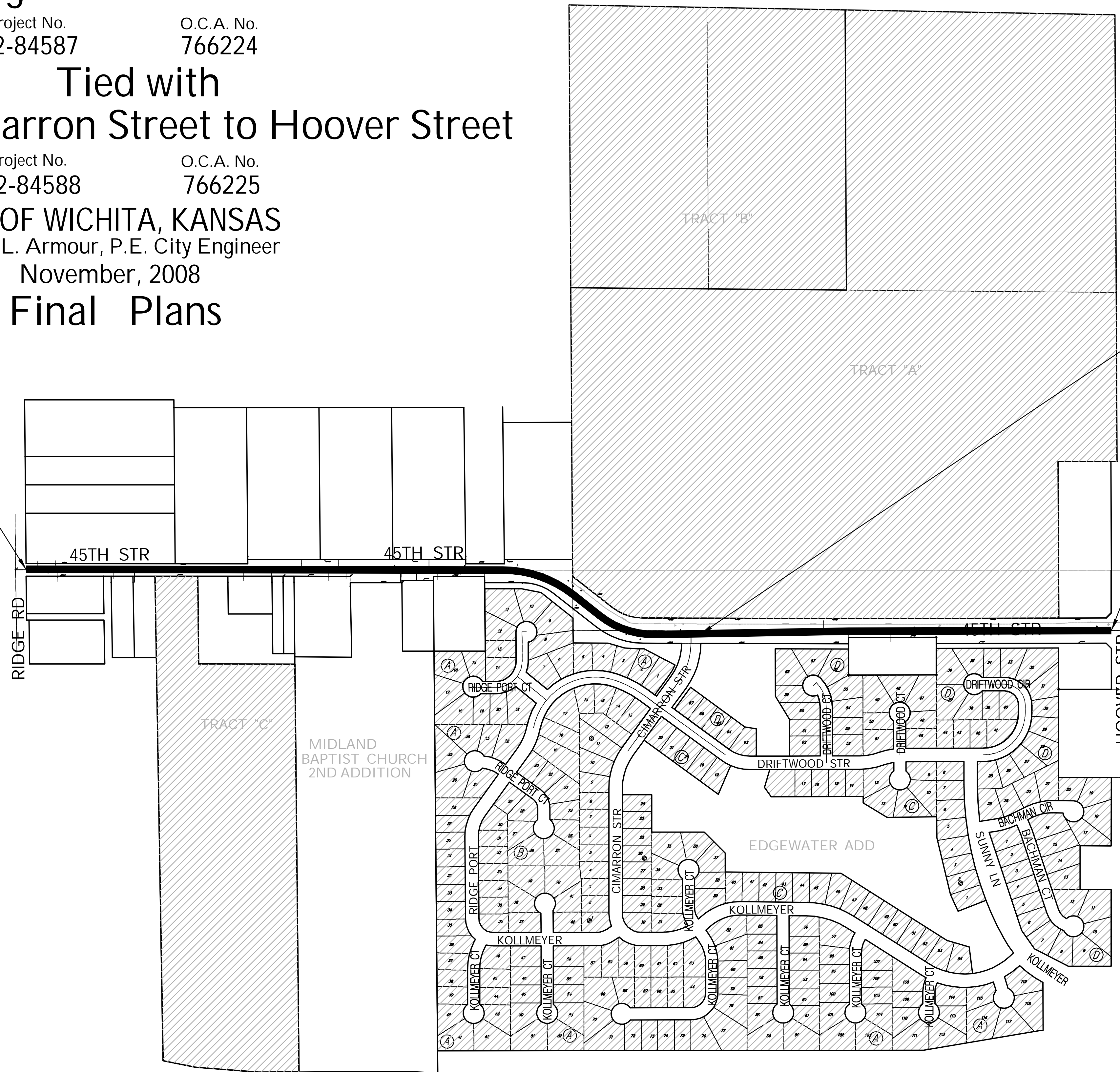

- Benefit District
- Construction