

**Benchmarks**

BM #3 : PK Nail in PP 2140' East of Ridge Rd. on the North side of 45th St. N.  
Elev. = 1338.70

Scale: 1" = 20'

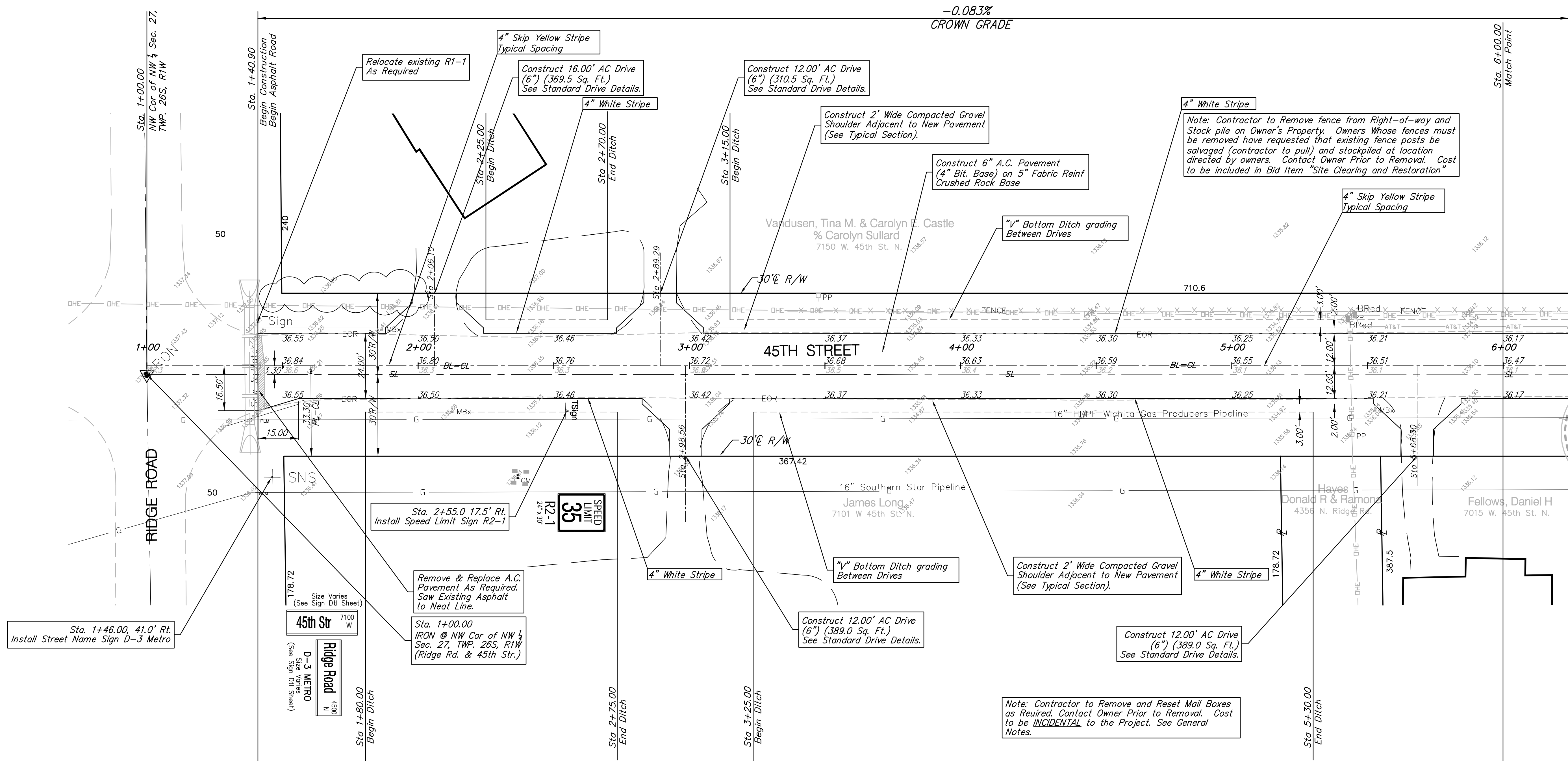
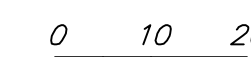

Sta. 1+46.00, 41.0' Rt.  
Install Street Name Sign D-3 Metro

45th Str 7100 W  
Ridge Road 4500 N  
D-3 METRO  
Size Varies (See Sign Dtl Sheet)

Sta. 2+55.0 17.5' Rt.  
Install Speed Limit Sign R2-1

Remove & Replace A.C. Pavement As Required. Saw Existing Asphalt to Neat Line.  
Sta. 1+00.00  
IRON @ NW Cor of NW 1/4 Sec. 27, TWP. 26S, R1W (Ridge Rd. & 45th Str.)

Construct 12.00' AC Drive (6") (389.0 Sq. Ft.)  
See Standard Drive Details.

Construct 12.00' AC Drive (6") (389.0 Sq. Ft.)  
See Standard Drive Details.

Note: Contractor to Remove and Reset Mail Boxes as Required. Contact Owner Prior to Removal. Cost to be INCIDENTAL to the Project. See General Notes.

Drawing File: E:\Edgewater\_45th Street Improvement\Land\dwg\base.dwg

Project No. 0808E183 CAPITAL IMPROVEMENT PROJECT  
Design: TCA  
Drawn: TCA  
Approved: JFB  
Scale: 1:20

45TH STREET PAVING  
RIDGE ROAD TO CIMARRON STREET  
PROJECT DESCRIPTION

**Baughman** Baughman Company, P.A.  
315 Ellis St. Wichita, KS 67211 P 316-262-7271 F 316-262-0149  
ENGINEERING | SURVEYING | PLANNING | LANDSCAPE ARCHITECTURE

OCTOBER, 2008  
SHEET 4 OF 25