

**Benchmarks**

BM #3 : PK Nail in PP 2140' East of Ridge Rd. on the North side of 45th St. N.  
Elev. = 1338.70

Scale: 1" = 20'

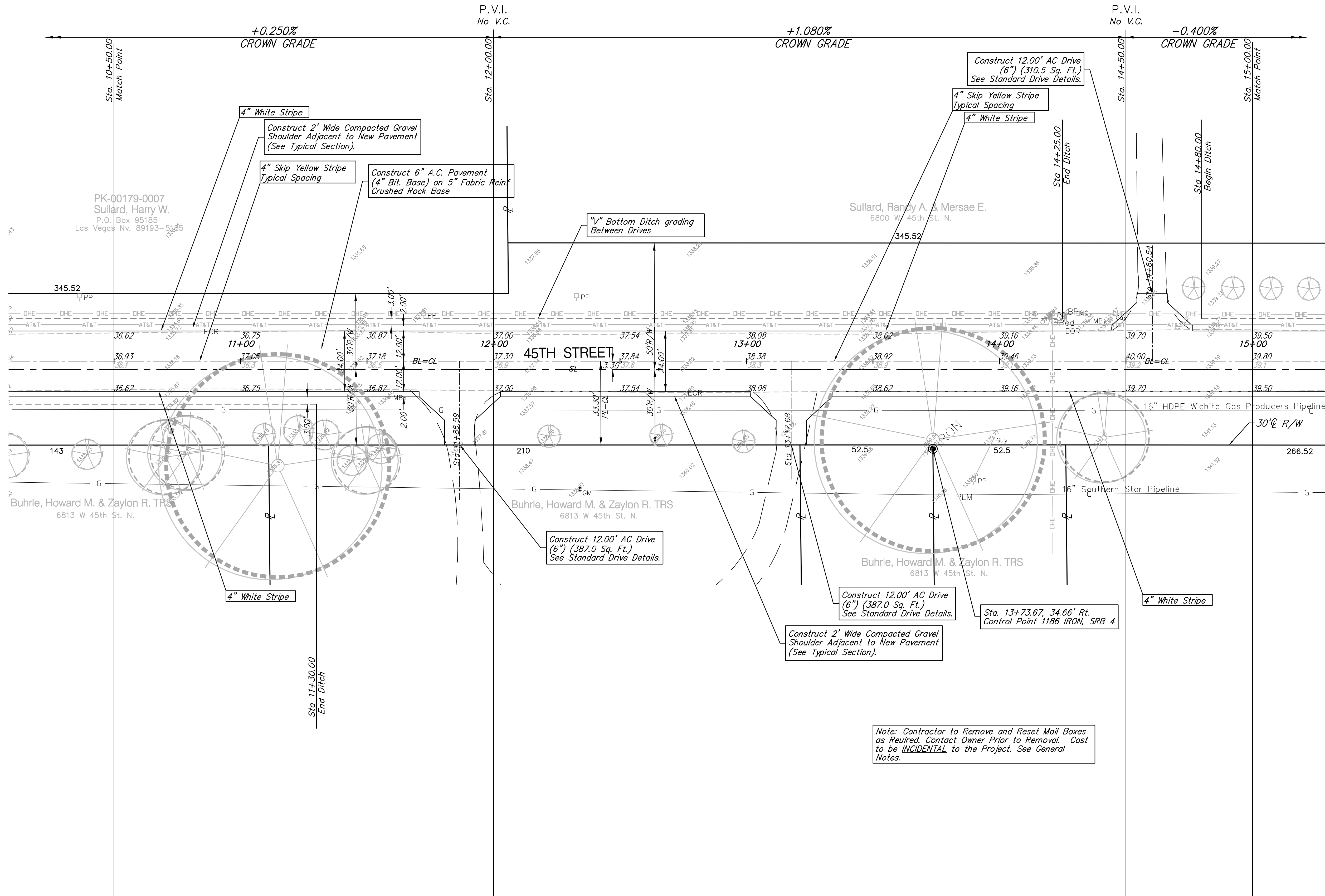
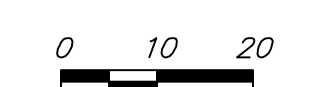

Note: Contractor to Remove and Reset Mail Boxes as Reuired. Contact Owner Prior to Removal. Cost to be INCIDENTAL to the Project. See General Notes.

Drawing File: E:\edgewater\_45th Street Improvement\Land\dwg\base.dwg

Design: TCA	Project No. 0808E183	CAPITAL IMPROVEMENT PROJECT
Drawn: TCA	45TH STREET PAVING	
Approved: JFB	RIDGE ROAD TO CIMARRON STREET	
Scale: 1:20	PROJECT DESCRIPTION	

**Baughman Company, P.A.**  
315 Ellis St. Wichita, KS 67211 P 316-262-7271 F 316-262-0149  
ENGINEERING | SURVEYING | PLANNING | LANDSCAPE ARCHITECTURE