

45th Street N. Paving

Phase 2 Cimarron Street to Hoover Street

Project No. 472-84588
O.C.A. No. 766225

CITY OF WICHITA, KANSAS

James L. Armour, P.E. City Engineer

November, 2008

Final Plans

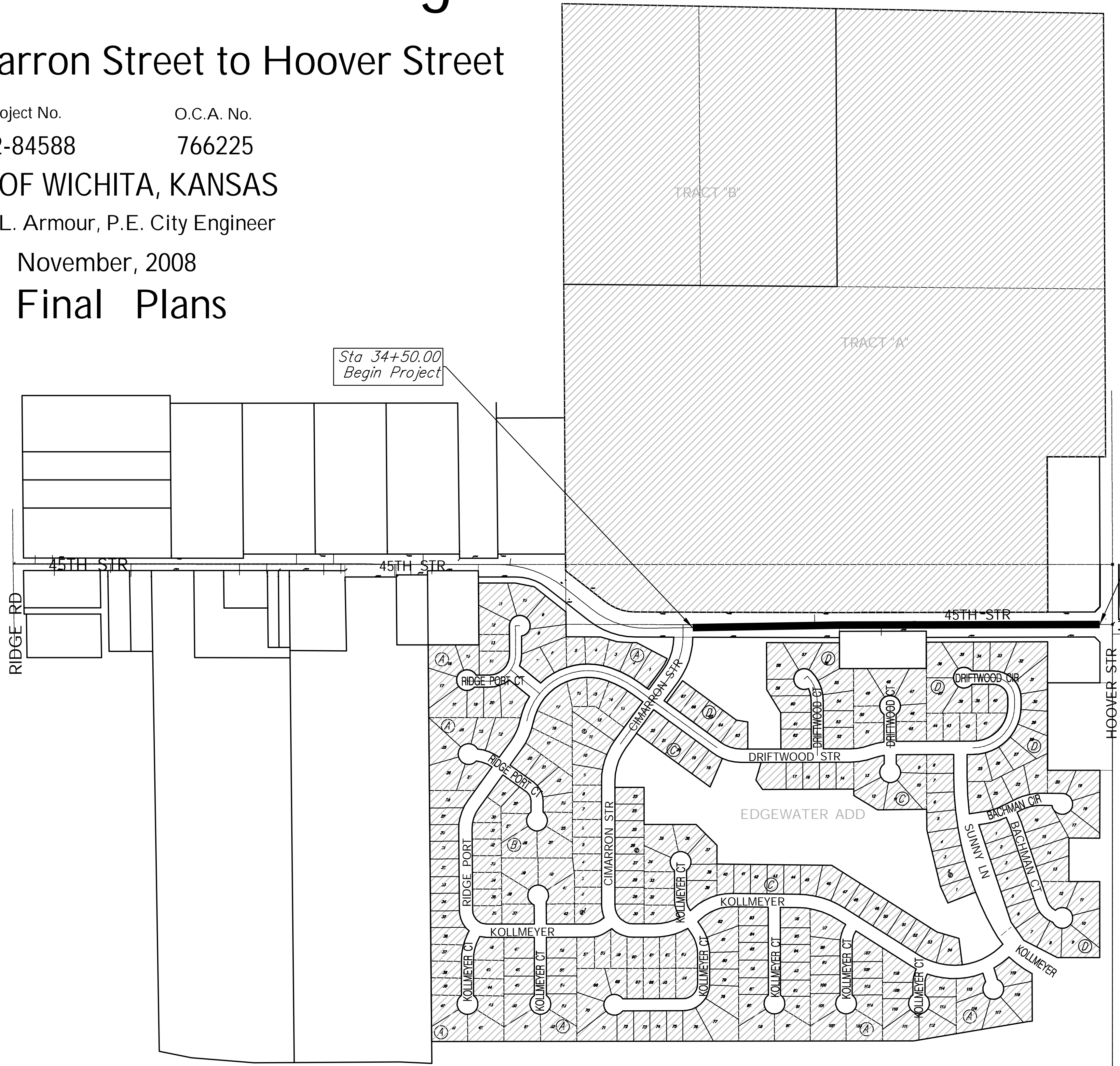
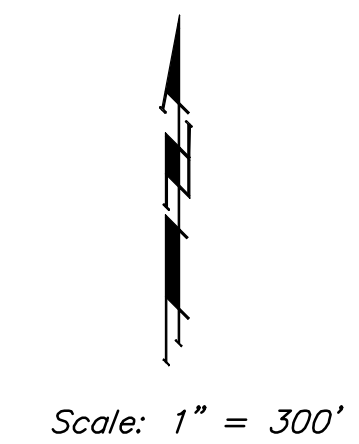

Benchmarks

BM #1: Hoover and 45th St. North - COW Benchmark at NE Corner of Intersection, 10.20' SSE of PP, 58.80' ESE of PP on NW corner, 85.50' NE of gas line marker, 59.00' North of gas line marker, 28.50' East of Centerline, 14.50' North of Centerline.
Elev. = 1335.29 (NGVD 29)

BM #2: Small RR spike in 3rd PP West of Hoover St. on the North side of 45th St. N.
Elev. = 1337.68

BM #3: PK Nail in PP 2140' East of Ridge Rd. on the North side of 45th St. N.
Elev. = 1338.70

Sheet Index

Title Sheet	1
General Notes	2
Typical Section	3
Plan	4-7
Signing Details	8
Erosion Control Plan	9
Erosion Control Details	10-13
Cross Sections	14-19

