

UNLESS OTHERWISE NOTED, ELEVATIONS SHOWN ARE TO TOP OF PIPE

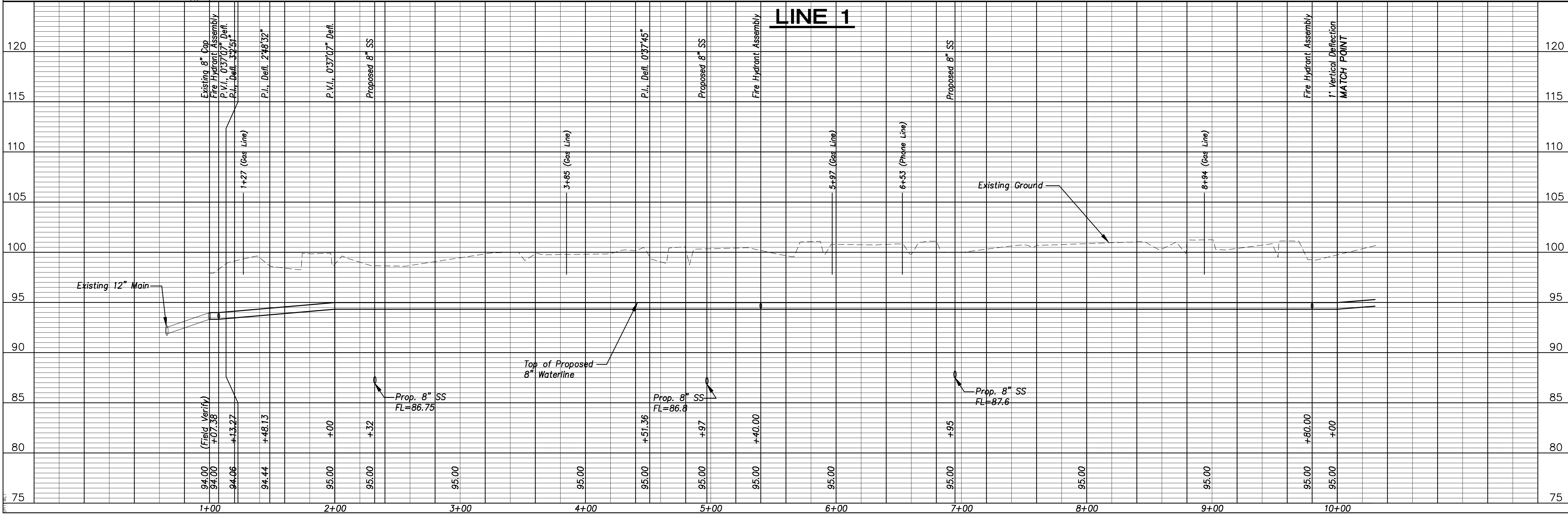

DATE: _____ BY: _____ APPROVED: _____

OATVILLE ADDITION
WATER DISTRIBUTION SYSTEM IMPROVEMENTS
LINE 1
CITY OF WICHITA, KANSAS
JAMES ARMOUR, P.E. - CITY ENGINEER
Proj.# 448-90072 O.C.A.# 73264

FINAL

Designed By: J. Dickman
Drawn By: M. Tucker
Poe Job No.: 1805A
Date: May 2008

POE & ASSOCIATES, INC.
CONSULTING ENGINEERS
5940 E. Central, Suite 200 • Wichita, KS 67208-4292
Phone 316/685-4114 • FAX 316/685-4444

Sheet
4 of 15