

UNLESS OTHERWISE NOTED, ELEVATIONS SHOWN ARE TO TOP OF PIPE

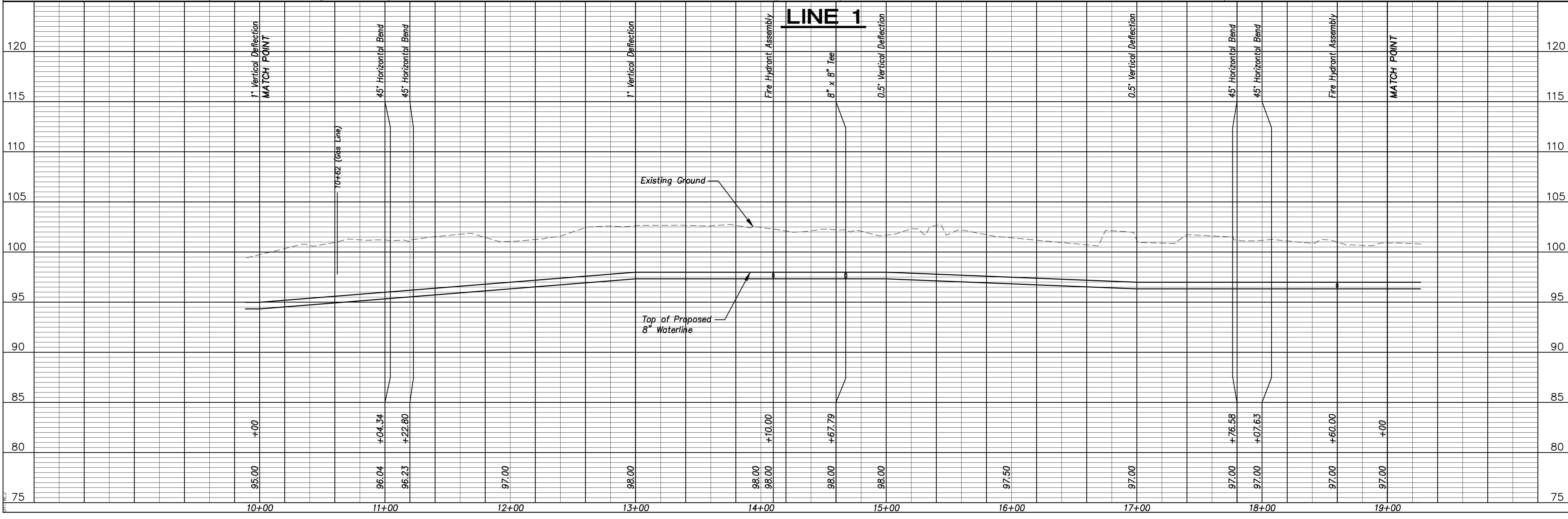

No.	Date	By	Approved	Revision

OATVILLE ADDITION  
WATER DISTRIBUTION SYSTEM IMPROVEMENTS  
LINE 1  
CITY OF WICHITA, KANSAS  
JAMES ARMOUR, P.E. - CITY ENGINEER  
Proj.# 448-90072 O.C.A.# 735264

**POE & ASSOCIATES, INC.**  
CONSULTING ENGINEERS  
5940 E. Central, Suite 200 • Wichita, KS 67208-4242  
Phone 316/685-4114 • FAX 316/685-4444

**FINAL**

Designed By: J. Dickman  
Drawn By: M. Tucker  
Poe Job No.: 1805A  
Date: May 2008

Sheet 5 of 15