

SPECIAL NOTES:

1. The Contractor shall use Best Management Practices to control erosion and sediment discharge in all disturbed areas of construction. The Contractor shall provide all necessary materials, and maintain temporary erosion and sediment controls during and after construction.
2. Unless otherwise noted all dimensions are measured center of structure to center of structure.
3. The Contractor shall field verify horizontal and vertical locations of existing buried utility lines prior to construction and report any discrepancies to the Engineer.

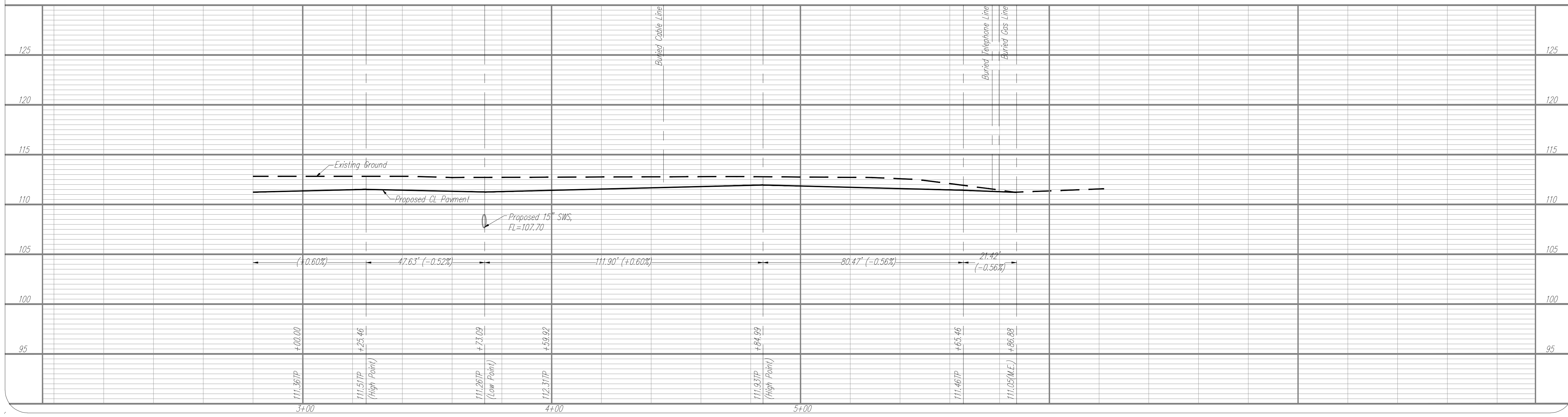

YOUNG & ASSOCIATES, P.A.
 Civil Engineering • Surveying • Land Development
 100 S. Georgia, Derby, KS 67037
 Tele: (316)788-2552, Fax: (316)788-4408, email: engineering@yga.com

Copyright 2007 by Young & Associates, P.A. All rights reserved. Prepared in the United States of America. This document, or any part thereof, or any concepts contained herein, are deemed confidential and proprietary information of Young & Associates, P.A. and may not be reproduced in any form without the specific written permission of Young & Associates, P.A. This plan and design is the exclusive property of Young & Associates, P.A. The liability of the original or copied material does not constitute professional liability.

MEAD STREET - PLAN & PROFILE
CL Sta. 3+00 to CL Sta. 5+86.88
 Street and Storm Sewer Improvements
 Mead Street, from Central to 3rd Street
 City of Wichita
 Sedgwick County, Kansas

scale: as noted
 drawn by: cc
 checked by: cry
 date: 9/9/08
 P/N: 07-246
 revisions:
 1/6/09