

SWS Line No. 1, CL Sta. 0+00
 Connect to proposed inlet
 Refer to "Old Town Drainage Improvements, Phase 2",
 Storm Water Sewer Line No. 4A:
 Inlet Top/IC=111.90 (1299.30 USGS)
 18" Stub FL In (N)=102.82 (1290.22)
 15" Stub FL In (W)=102.82 (1290.22)
 18" FL Out (E)=102.72 (1290.12 USGS)

CL Mead Street 2+42.88, 14.00' Lt. to 29.00' Lt.
 Install 15 LF 15" RCP Stub
 Plug west end of RCP
 FL 15" RCP = 106.36

CL Mead Street 2+40.79, 14.00' Lt. =
 SWS Line No. 1, CL Sta. 2+47.58 =
 SWS Line No. 2, CL Sta. 0+00 (see Sht. 13)
 Construct Std. Double Driveway Inlet
 See details Sht. 14
 Inlet Top El.=110.70
 FL 18" RCP In (N)=106.01
 FL 15" RCP In (E)=107.26
 FL 15" RCP Stub In (W)=106.26
 FL 18" RCP Out (S)=105.91

CL Mead Street 3+73.09, 14.00' Lt. =
 SWS Line No. 1, CL Sta. 3+79.88 =
 Construct Std. Single Driveway Inlet
 See details Sht. 15
 Inlet Top El.=110.96
 FL 15" RCP In (E)=107.56
 FL 15" RCP In (NW)=107.56
 FL 15" RCP Stub In (W)=107.56
 FL 18" RCP Out (S)=107.31

CL Mead Street 3+73.09, 14.00' Rt. =
 SWS Line No. 1, CL Sta. 4+07.88 =
 Construct Std. Single Driveway Inlet
 See details Sht. 15
 Inlet Top El.=110.96
 FL 15" RCP Out (E)=107.84

CL SWS Line No. 1, Sta. 0+00 to Sta. 2+47.58
 Install 247.58 LF 18" RCP

CL SWS Line No. 1, Sta. 2+47.58 to Sta. 3+79.88
 Install 132.30 LF 18" RCP

CL SWS Line No. 1, Sta. 3+79.88 (Lt.)
 Install 21.00 LF 15" RCP Stub.

CL SWS Line No. 1, Sta. 3+79.88 to Sta. 4+07.88
 Install 28.00 LF 15" RCP

- SPECIAL NOTES:**
- The Contractor shall use Best Management Practices to control erosion and sediment discharge in all disturbed areas of construction. The Contractor shall provide all necessary materials, and maintain temporary erosion and sediment controls during and after construction.
 - Unless otherwise noted all dimensions are measured center of structure to center of structure.
 - The Contractor shall field verify horizontal and vertical locations of existing buried utility lines prior to construction and report any discrepancies to the Engineer.

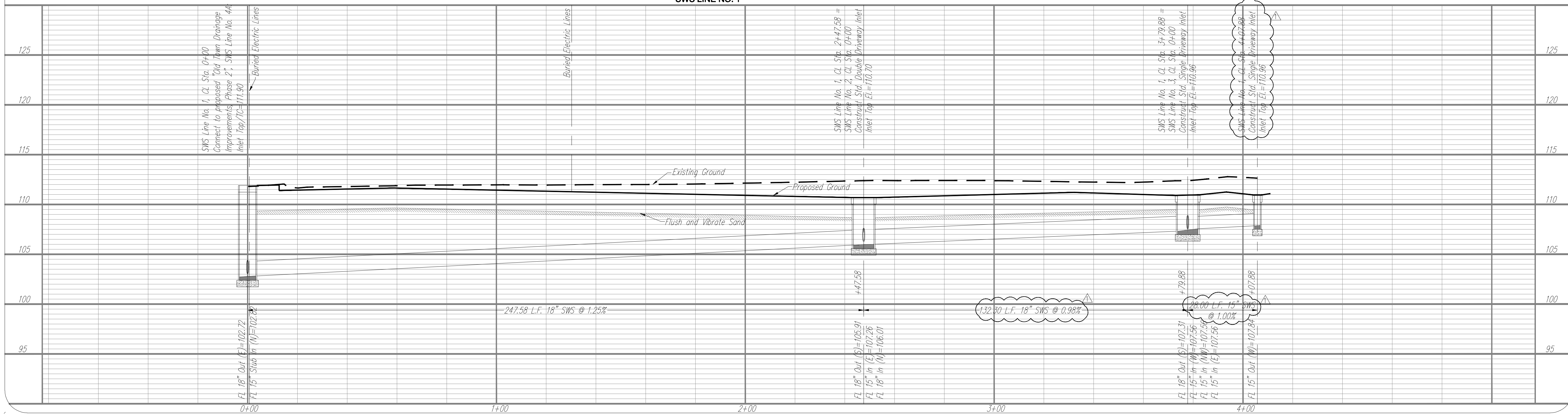

YOUNG & ASSOCIATES, P.A.
 Civil Engineering • Surveying • Land Development
 100 S. Georgia, Derby, KS 67037
 Tele: (316)788-2552, Fax: (316)788-4408, Email: engineering@yga.com
 Copyright 2002, by Young & Associates, P.A. All rights reserved. Prepared in the United States of America. This document, or parts thereof, or design concepts contained herein, are deemed confidential and proprietary information of Young & Associates, P.A. and may not be reproduced, stored in a retrieval system, or transmitted in any form or by any means, electronic, mechanical, photocopying, recording, or by any information storage and retrieval system, without the prior written permission of Young & Associates, P.A. The liability of the engineer or design professional does not constitute professional liability insurance.

SWS LINE NO. 1 - PLAN & PROFILE
 Street and Storm Sewer Improvements
 Mead Street, from Central to 3rd Street
 City of Wichita
 Sedgewick County, Kansas

scale: as noted
 drawn by: CAC
 checked by: CRY
 date: 9/9/08
 P/N: 07-246
 revisions:
 1/6/09