

GENERAL NOTES

1. Grate frame to be installed on thin mortar cushion to insure full support along brick walls. Concrete used for inlet construction shall be concrete pavement mix.
2. Inlet invert shall be shaped with 8 sack sand mix concrete to create flow channels and to increase hydraulic efficiency such that the inlet will be self cleaning between all inlet and/or outlet pipes.
3. The ends of all pipes installed in inlets shall be cut off flush with the inside face of the inlet wall.
4. Inlet Frame and Grate to be Deeter #2501-A of approved equal.

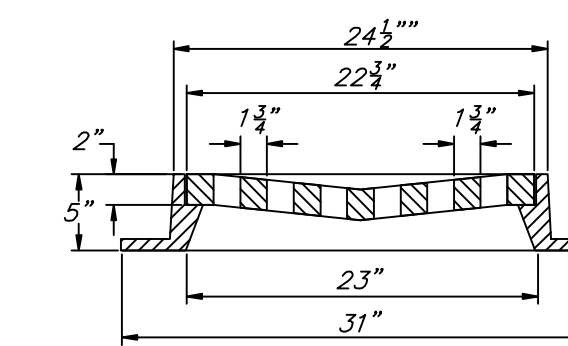

DEETER #2501-A FRAME & GRATE
TOTAL WEIGHT: 520 lbs.

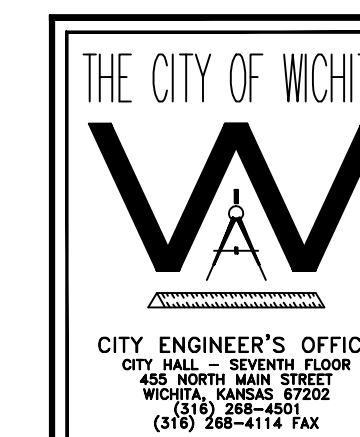

SPECIAL DRIVE
INLET - SINGLE

M. E. LINDEBAK P.E. - CITY ENGINEER

PROJECT NUMBER

472-84561

INDEX CODE

DATE

MAR 96

SHEET 15 of 30