

WATER DISTRIBUTION SYSTEM

68th Street South, Minnesota & Cider

PROJECT NO. 448-90397

O.C.A. NO. 735424

GENERAL NOTES

1. Contractor will be required to provide a minimum advance notice of seventy-two (72) hours to utility companies prior to starting any excavation as follows:

Kansas One-Call 811
The Contractor must notify the following in case of an emergency:

Cox Communications	262-4270
Kansas Gas Service	832-3126
Westar	383-8600
Peoples Natural Gas Company	1-800-303-0357
AT&T	1-800-286-8313
City of Wichita Water Department	262-6000
City of Wichita Sewer Maintenance	262-6000

2. Underground utility service lines and overhead utility pole lines are to be adjusted as necessary by others prior to construction unless the plans specifically call for their adjustment by the Contractor or unless the plans specifically identify a utility to be adjusted by its owner during construction. Existing utilities and their location, as shown on the plans, represent the best information obtainable for design. Location information has been obtained from the various utility companies and is either from company record drawings or company-provided field locations. The Contractor will be required to work around existing utilities within the right-of-way which do not conflict with proposed construction.

3. Rubble from the removal of miscellaneous structures and excess excavation which is to be wasted shall be disposed of on sites to be provided by the Contractor. These sites shall be approved by the Engineer as to suitability, appearance and site location. Locations that, in the opinion of the Engineer, will leave an unsightly appearance will not be approved.

4. All disposal sites must be approved by the Kansas Department of Health and Environment. Material either stockpiled or disposed of in a flood plain would require a Kansas State Board of Agriculture permit. Any material dumped in waters of the United States or wetlands is subject to U.S. Corps permitting regulations. Any material buried or stockpiled beyond approved of Engineers construction limits would require additional archeological investigations unless buried in a previously approved borrow location.

5. The Engineer shall take field ties to all quarter section corners. The Contractor shall set a City survey monument in the required location where such quarter section corners fall within the limits of pavement construction. Survey monuments will be furnished by the City. The Engineer will accurately locate and install the iron at the quarter section corner. This work will not be paid for directly, but shall be considered subsidiary to the other pay items of work in the contract.

6. The Contractor shall coordinate with WESTAR to perform work safely in the vicinity of WESTAR Transmission Lines.

7. The Contractor shall give all property owners and/or tenants of developed property directly abutting the construction of this project a minimum of ten (10) days advance notice prior to start of construction.

8. The Contractor shall Seed, Fertilize and Mulch all disturbed areas per City of Wichita Standard Specifications.

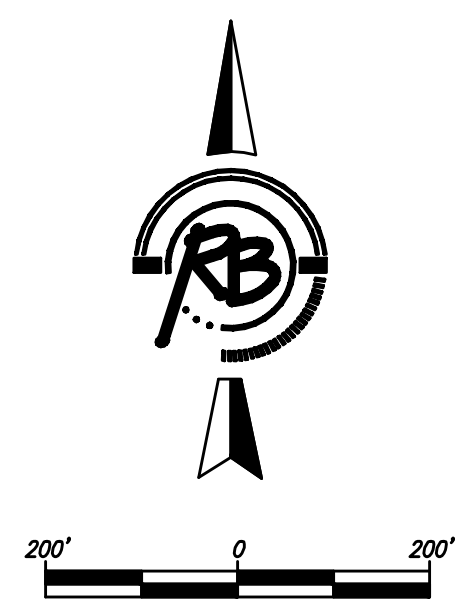
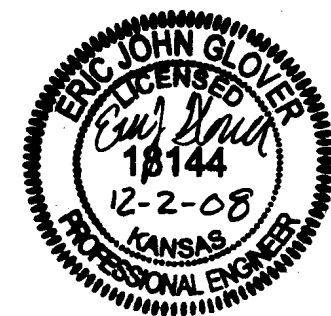
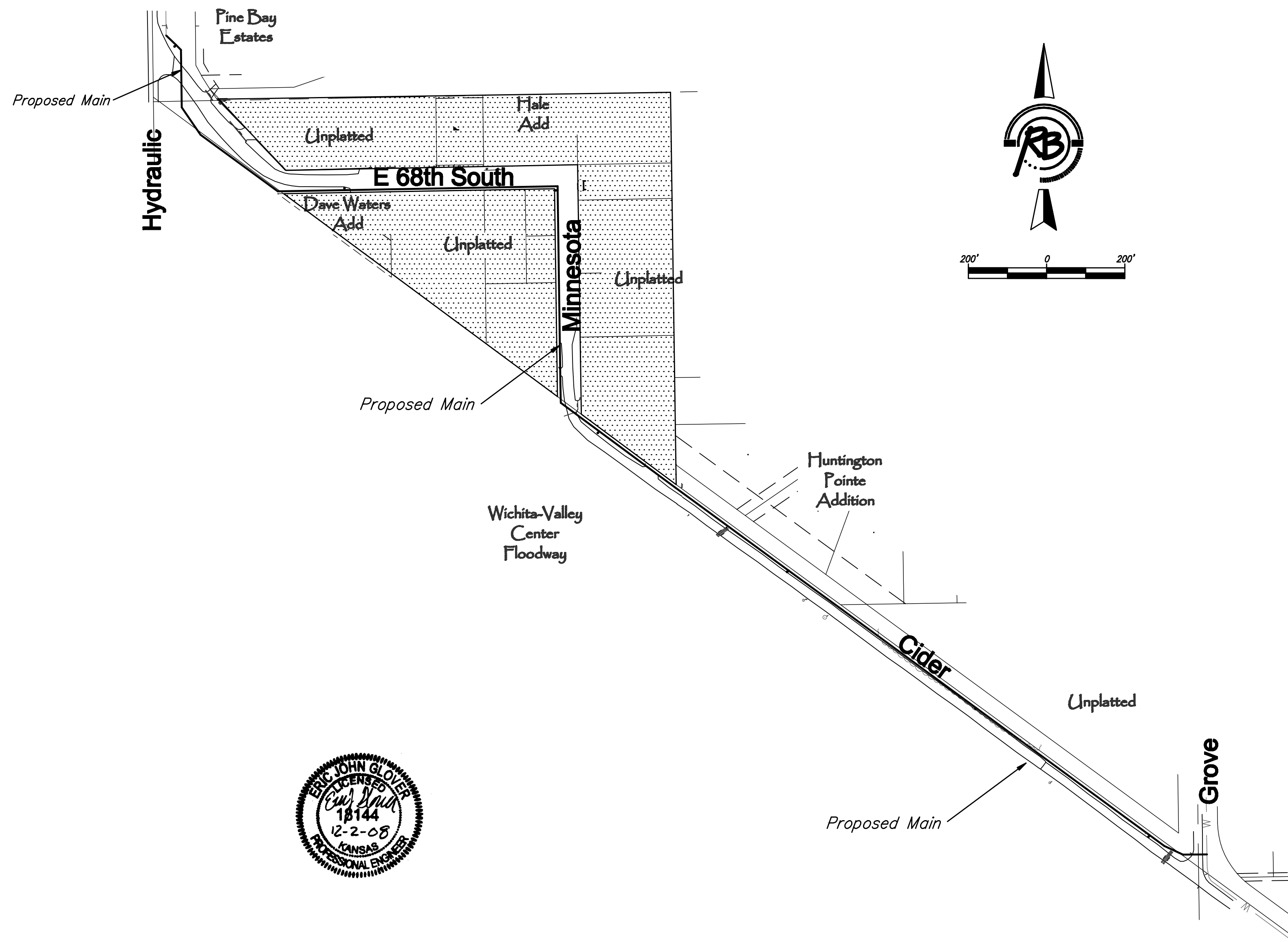

BENCH MARKS

BENCH MARK #1: Brass plate on Southeast corner of Bridge over Wichita-Valley Center Flood Control Ditch on Hydraulic Ave.
Elevation = 1268.74 (MSL)

BENCH MARK #2: RR Spike in highline pole along N ROW line of Wichita-Valley Center Floodway, 58.4' East-Southeast of int of ROW line with West line of SE 1/4 Sec 34, T28S, R1E
Elevation = 1256.19 (MSL)

SHEET INDEX

1. Title Sheet
2. Water Assembly Details
- 3-7. Water Main Plan and Profile
8. BMP Detail

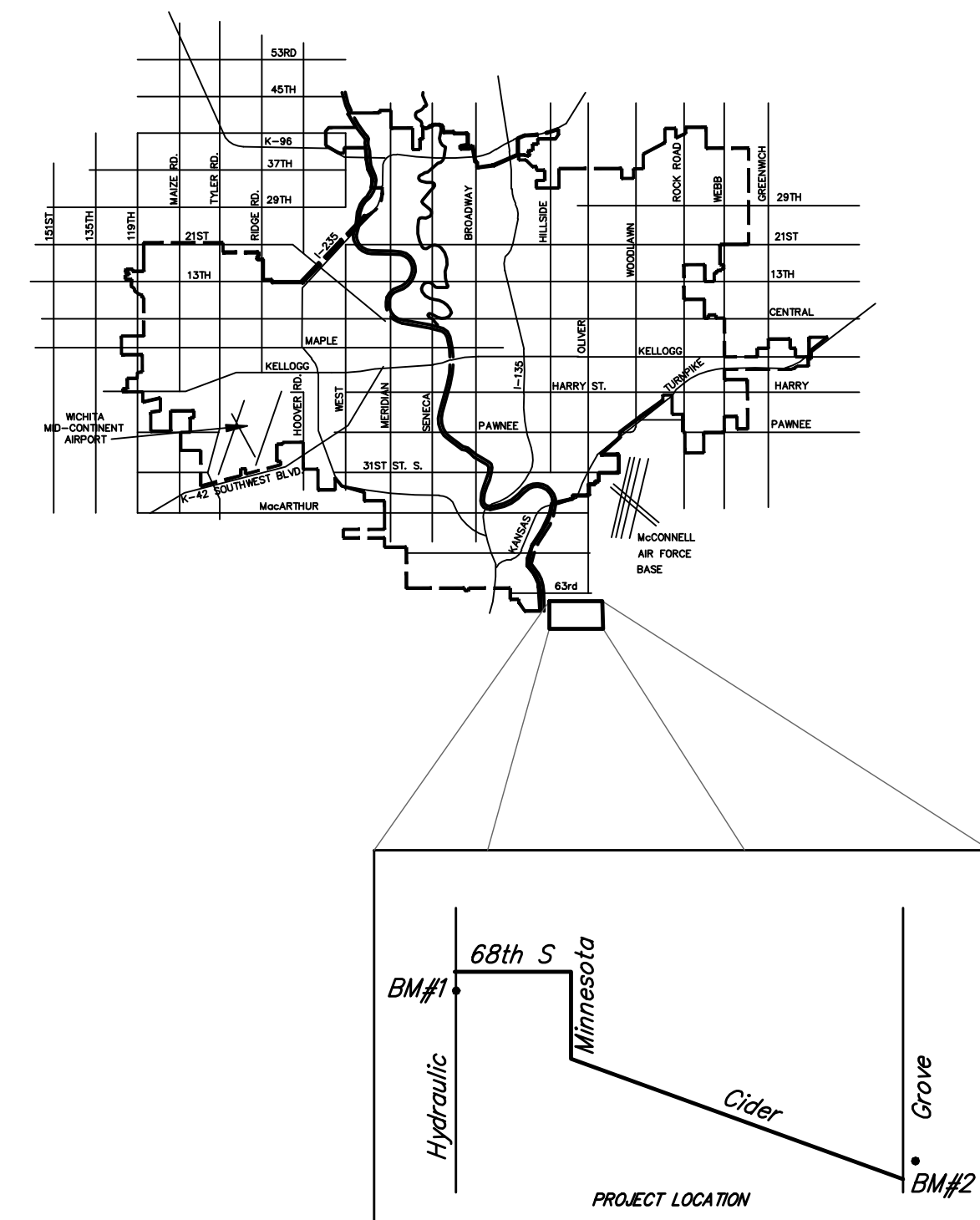

IMPROVEMENT DISTRICT

CITY OF WICHITA, KANSAS
JAMES ARMOUR, P.E. - CITY ENGINEER

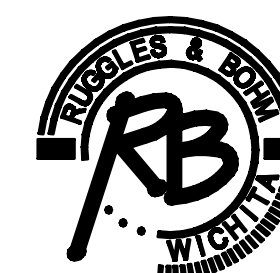

Ruggles & Bohm, P.A.
 Engineering, Surveying, Land Planning
 824 North Main (316) 264-8008
 Wichita, Kansas 67203 (316) 264-4821 fax
 www.rbkansas.com E-mail: info@rbkansas.com