

GENERAL NOTES

1. WATERLINES SHALL BE INSTALLED IN ACCORDANCE WITH CITY OF WICHITA STANDARD SPECIFICATIONS, FOR THE "INSTALLATION OF WATER DISTRIBUTION SYSTEMS", NO. 14533.
2. AT LEAST 24 HOURS PRIOR TO BEGINNING ANY EXCAVATION (EXCLUDING WEEKENDS AND HOLIDAYS), THE CONTRACTOR SHALL CONTACT THE KANSAS ONE-CALL SYSTEM, A UTILITY LOCATION SERVICE, AT (316) 687-2470 TO REQUEST THE LOCAL UTILITY COMPANIES TO LOCATE ANY EXISTING LINES WITHIN THE PROJECT AREA.
3. THE CONTRACTOR MUST NOTIFY THE FOLLOWING IN CASE OF AN EMERGENCY:

COX COMMUNICATIONS	262-4270 or 263-2061
KANSAS GAS SERVICE	1-888-482-4950
WESTAR	1-800-383-1183
SBC	1-800-870-8390
AQUILA	1-800-303-0752
CITY OF WICHITA WATER DEPARTMENT	268-4555
4. ANY EXCESS EXCAVATION WHICH IS TO BE WASTED, SHALL BE DISPOSED OF ON SITES PROVIDED BY THE CONTRACTOR. THESE SITES SHALL BE APPROVED BY THE ENGINEER AS TO SUITABILITY, APPEARANCE, AND SITE LOCATION, AND SHALL BE DISPOSED OF IN ACCORDANCE WITH THE PROVISIONS OF THE KANSAS SOLID WASTE MANAGEMENT STATUTES AND REGULATIONS (KSA 65-3401, KAR 28-29-1 ET SEQ.)
5. THE CONTRACTOR WILL BE REQUIRED TO WORK AROUND EXISTING UTILITIES WITHIN THE RIGHT-OF-WAY. THE CONTRACTOR WILL DELIVER REMOVED FIRE HYDRANTS TO WATER DISTRIBUTION, 1703 SIM PARK DRIVE.
6. CONTRACTOR TO MAINTAIN TRAFFIC USING BARRICADES AND FLAGPERSONS WHILE WORKING WITHIN STREET RIGHT OF WAY.
7. EXISTING UTILITIES AND THEIR LOCATION, AS SHOWN ON THE PLANS, REPRESENT THE BEST AVAILABLE INFORMATION. IT SHOULD BE NOTED THAT OTHER BURIED LINES AND CABLE MAY EXIST WHICH ARE NOT SHOWN ON THESE PLANS. THE CONTRACTOR SHALL EXERCISE EXTREME CAUTION DURING TRENCHING OPERATIONS TO AVOID DAMAGING THESE LINES AND CABLES. ANY UTILITIES DAMAGED SHALL BE REPLACED OR REPAIRED IMMEDIATELY AS DIRECTED BY THE ENGINEER AT THE CONTRACTOR'S EXPENSE. THE CONTRACTOR SHALL PROTECT FROM DAMAGE AND SUPPORT EXISTING UTILITIES THROUGH CONSTRUCTION AS APPROVED BY THE UTILITY OWNER AND THE ENGINEER AT THE CONTRACTOR'S EXPENSE.
8. THE CONTRACTOR SHALL BE RESPONSIBLE FOR PRESERVING EXISTING PROPERTY IRONS AND RIGHT-OF-WAY MONUMENTS. THE CONTRACTOR SHALL BE REQUIRED TO RE-ESTABLISH ANY PROPERTY IRONS OR RIGHT-OF-WAY MONUMENTS WHICH ARE DAMAGED OR DESTROYED BY HIS CONSTRUCTION OPERATIONS. SUCH IRONS OR MONUMENTS SHALL BE RE-ESTABLISHED BY A LICENSED LAND SURVEYOR IN ACCORDANCE WITH STATE LAWS.
9. THE CONTRACTOR SHALL VERIFY HORIZONTAL AND VERTICAL LOCATION, TYPE, SIZE, AND CLASS OF EXISTING WATERLINES PRIOR TO CONSTRUCTION. EXISTING WATERLINE LOCATIONS AS SHOWN ON THE PLANS ARE APPROXIMATE. THE CONTRACTOR SHALL MAKE ADJUSTMENTS AS REQUIRED AND APPROVED BY THE ENGINEER. PROVISIONS FOR AND INSTALLATION OF PIPE ADAPTORS, SHORT SECTIONS OF PIPE, AND COUPLERS SHALL BE SUBSIDIARY TO OTHER PAY ITEMS OF WORK.
10. THE CONTRACTOR SHALL NOT START WORK ON THE PROJECT UNTIL THE PROJECT INSPECTOR IS ASSIGNED TO THE PROJECT AND IS PRESENT ON THE SITE. ANY WORK PERFORMED WITHOUT INSPECTION IS SUBJECT TO BE UNCOVERED FOR INSPECTION.
11. OPENING AND CLOSING WATER VALVES SHALL BE DONE SLOWLY TO PREVENT DAMAGE TO THE WATER DISTRIBUTION SYSTEM FROM WATER HAMMER. ALL VALVES CLOSED BY THE CONTRACTOR MUST BE REOPENED AS NEW CONSTRUCTION PERMITS. PROJECT INSPECTOR MUST ASCERTAIN THAT ANY VALVE CLOSED BY THE CONTRACTOR IS REOPENED. CONTRACTOR WILL BE PERMITTED TO OPERATE WATER VALVES ONLY WHEN THE PROJECT INSPECTOR ASSIGNED TO THE PROJECT IS PRESENT.
12. THE CONTRACTOR SHALL GIVE ALL PROPERTY OWNERS AND/OR TENNANTS OF DEVELOPED PROPERTY DIRECTLY ADJUTING THE CONSTRUCTION OF THIS PROJECT A MINIMUM OF TEN (10) DAYS ADVANCE NOTICE PRIOR TO START OF CONSTRUCTION.
13. EACH BIDDER SHALL VISIT THE SITE OF THE PROJECT BEFORE SUBMITTING THE PROPOSAL FOR THIS WORK SO THAT HE WILL BE FULLY INFORMED OF THE EXISTING FIELD CONDITIONS AND THE OBSTACLES WHICH MIGHT BE ENCOUNTERED. UPON AWARD OF THE CONTRACT THE CONTRACTOR WILL NOT BE GRANTED ANY ADDITIONAL COMPENSATION WITH REGARDS TO TIME AND MONEY FOR CONDITIONS THAT MAY HAVE BEEN EVALUATED DURING ANY INSPECTION OF THE SITE.
14. ALL WATERLINES SHALL HAVE A MINIMUM DEPTH OF BURY OF 42 INCHES. THE WATER MAIN SHALL BE CONSTRUCTED ON THE ALIGNMENT SHOWN BY THE PLANS. THE COST FOR ANY NECESSARY TREE TRIMMING, CLEARING AND/OR GRUBBING SHALL BE INCLUDED IN THE PRICE BID FOR THE INSTALLED WATER MAIN PIPE. TREES AND SHRUBS IN PUBLIC RIGHT OF WAY WHICH ARE IN DIRECT CONFLICT WITH PROPOSED CONSTRUCTION SHALL BE REMOVED BY THE CONTRACTOR AND SHALL BE INCLUDED IN THE PRICE BID FOR THE INSTALLED WATER PIPE. TREES AND SHRUBS NOT IN DIRECT CONFLICT WITH PROPOSED CONSTRUCTION SHALL BE SAVED AND PROTECTED FROM DAMAGE.
15. INSPECTOR WILL NOTE ON AS BUILT PLAN LOCATIONS OF ALL FITTINGS AND VALVES. LOCATIONS WILL BE MEASURED FROM PROPERTY LINES, CURB LINES, AND/OR CENTER LINES. HYDRANT BRANCH LENGTH AND HYDRANT BURY LINE ELEVATION ARE TO MATCH FIELD CONDITIONS AND BE APPROVED BY THE ENGINEER.

WATER LINE IMPROVEMENTS

FOR RETAIL & OFFICE BLDG'S ON LOTS 3-7, WEST PARK GARDENS ADDITION, WICHITA, SEDGWICK COUNTY, KANSAS

COW PRIV. PROJ. NO. 1314 PPW (607853)
JAMES L. ARMOUR, P.E., CITY ENGINEER
JUNE 2007

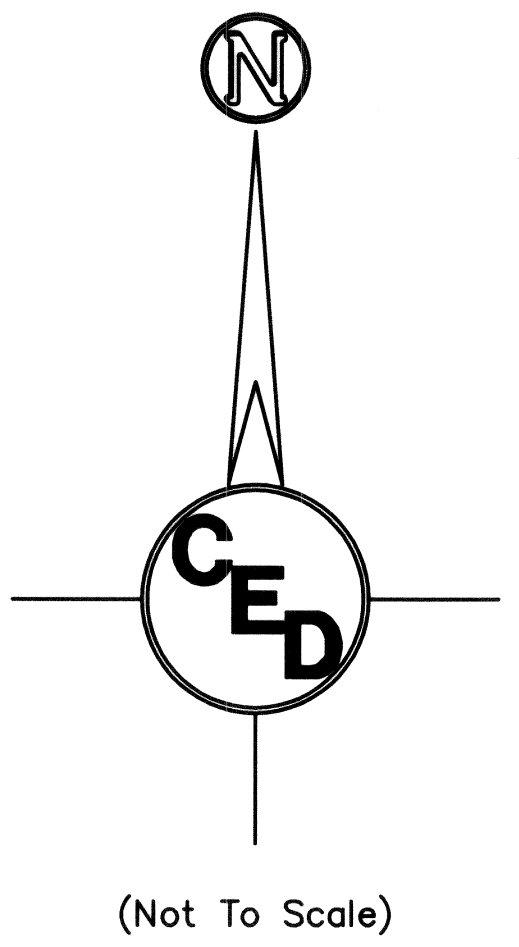

INDEX OF SHEETS

1. Title Sheet
2. Site Plan
3. Waterline Plan and Profile
4. Water Details
- 5.-9. BMP Detail Sheets

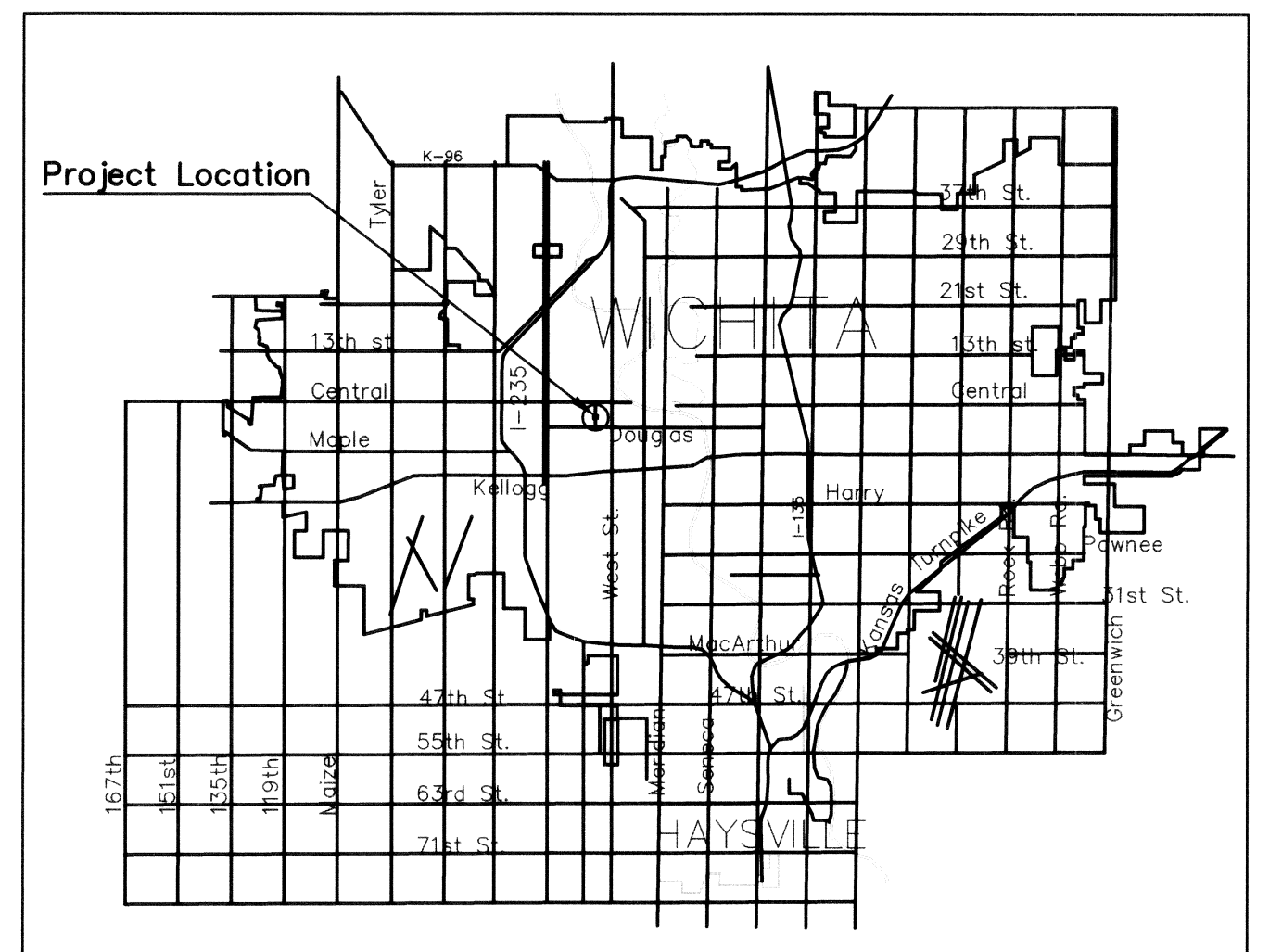
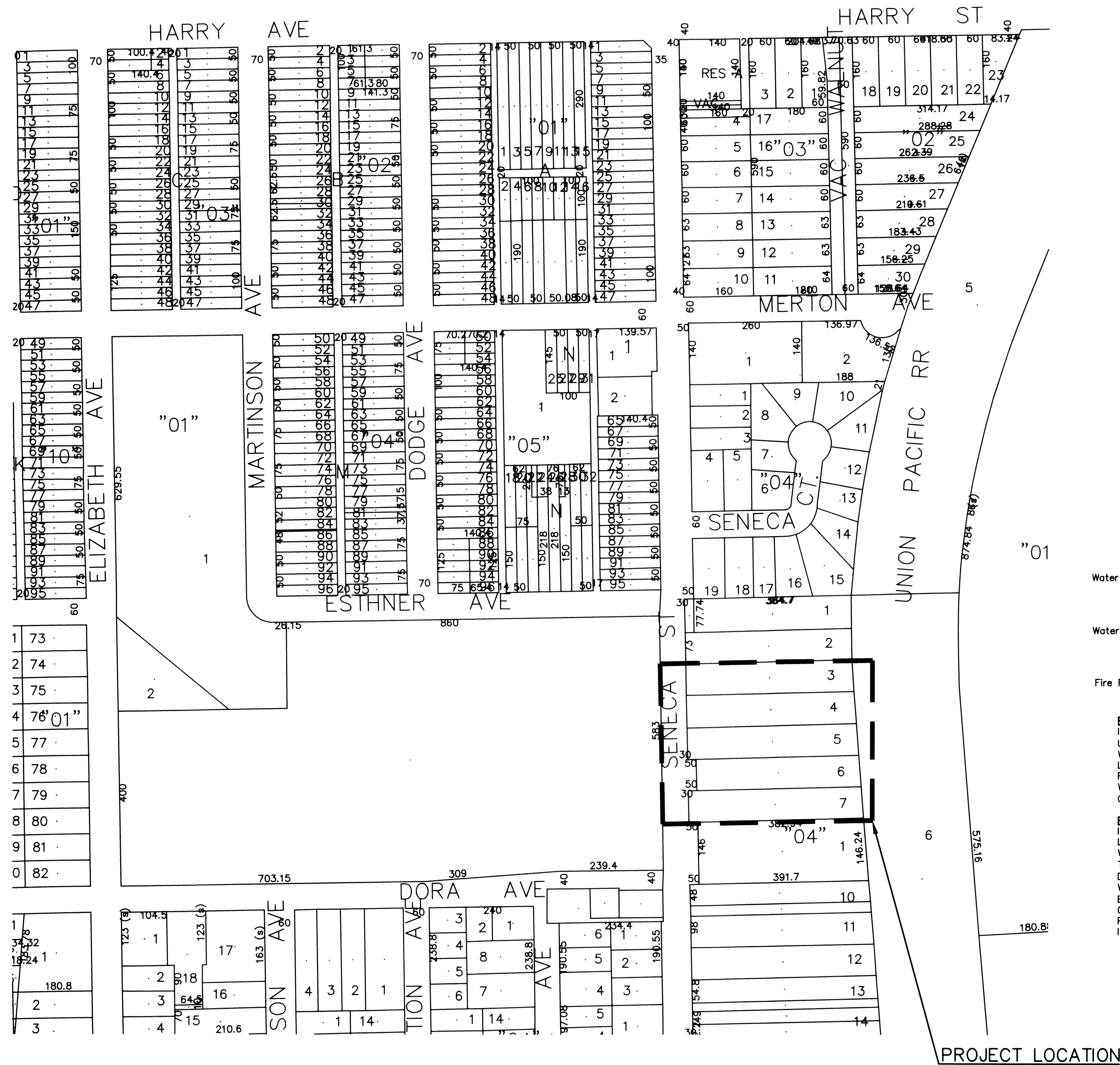

APPROVED AS NOTED
BY CITY ENGINEER OF WICHITA,
BY WICHITA WATER & SEWER DEPARTMENT
& WICHITA FIRE DEPARTMENT

Water Mains (Public Works) *JAR 7/12/07*

Water Mains (W & S) _____

Fire Protection Line *WJH 7/12/07*

NOTE TO CONTRACTORS

PUBLIC PROPERTY:
INSPECTION AND TESTING FOR THE WATERLINE IS TO BE PROVIDED BY A LICENSED CONSULTING ENGINEERING FIRM UNDER CONTRACT WITH THE OWNER/DEVELOPER. SAID INSPECTION TO BE IN ACCORDANCE WITH THE CITY OF WICHITA STANDARD CONSTRUCTION ENGINEERING PRACTICES AND CERTIFIED BY A PROFESSIONAL ENGINEER LICENSED IN THE STATE OF KANSAS. NO WORK SHALL BE PERFORMED IN DEDICATED EASEMENTS OR THE PUBLIC RIGHT-OF-WAY BY THE CONTRACTOR WITHOUT SUCH INSPECTION NOR SHALL ANY WORK BE COMMENCED WITHOUT WRITTEN AUTHORIZATION BY THE CITY ENGINEER. ALL CONSTRUCTION AND MATERIALS SHALL COMPLY WITH THE CITY OF WICHITA SPECIFICATIONS AND STANDARDS (ON FILE AND AVAILABLE IN THE CITY ENGINEER'S OFFICE).

PRIVATE PROPERTY:
INSTALLATION AND TESTING FOR THE FIRE PROTECTION LINE IS TO BE PERFORMED BY A CITY OF WICHITA LICENSED FIRE PROTECTION CONTRACTOR IN ACCORDANCE WITH THE FIRE CODES AS ADOPTED BY THE CITY OF WICHITA. ALL MATERIAL AND CONSTRUCTION PRACTICES FOR THE FIRE PROTECTION LINE SHALL COMPLY WITH THE FIRE CODES AS ADOPTED BY THE CITY OF WICHITA (AVAILABLE FROM THE CITY OF WICHITA FIRE DEPARTMENT). THE CONTRACTOR SHALL NOT COMMENCE WORK WITHOUT NOTIFICATION AND APPROVAL OF THE WICHITA FIRE DEPARTMENT. INSPECTION OF THE FIRE PROTECTION LINE IS TO BE PROVIDED BY A LICENSED ENGINEERING FIRM UNDER CONTRACT WITH THE OWNER/DEVELOPER AND THE FIRE DEPARTMENT. THE CONTRACTOR SHALL NOT START WORK UNTIL THE PROJECT INSPECTOR IS ASSIGNED TO THE PROJECT AND PRESENT ON THE SITE. ANY WORK DONE WITHOUT INSPECTION WILL BE REQUIRED TO BE UNCOVERED FOR INSPECTION.

AS-BUILTS:
Contractor: C+K Construction
Inspector: Pat Hayes (CEO)
pdf by: JOT (CEO) 4-3-08

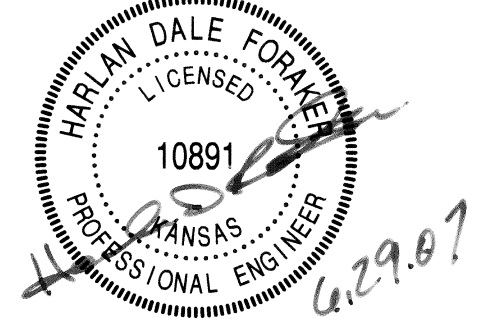

PROJECT LOCATED IN THE
NW 1/4, SEC. 32, T27S, R1E
WICHITA, SEDGWICK COUNTY, KANSAS

COW PROJ. NO'S: 1314PPW(607853)	
CERTIFIED ENGINEERING DESIGN, P.A.	
CED	810 WEST DOUGLAS, SUITE C WICHITA, KANSAS 67203 PH: (316) 262-8808 FAX: (316) 262-1669
SHEET	1
TOTAL 9	