

**BENCHMARK:**  
 "□" CUT ON TRAFFIC SIGNAL  
 LIGHT POLE BASE, NW CORNER OF  
 KELLOGG & 143RD STREET EAST.

ELEV. = 1318.61 NGVD  
 ELEV. = 131.21 CITY DATUM

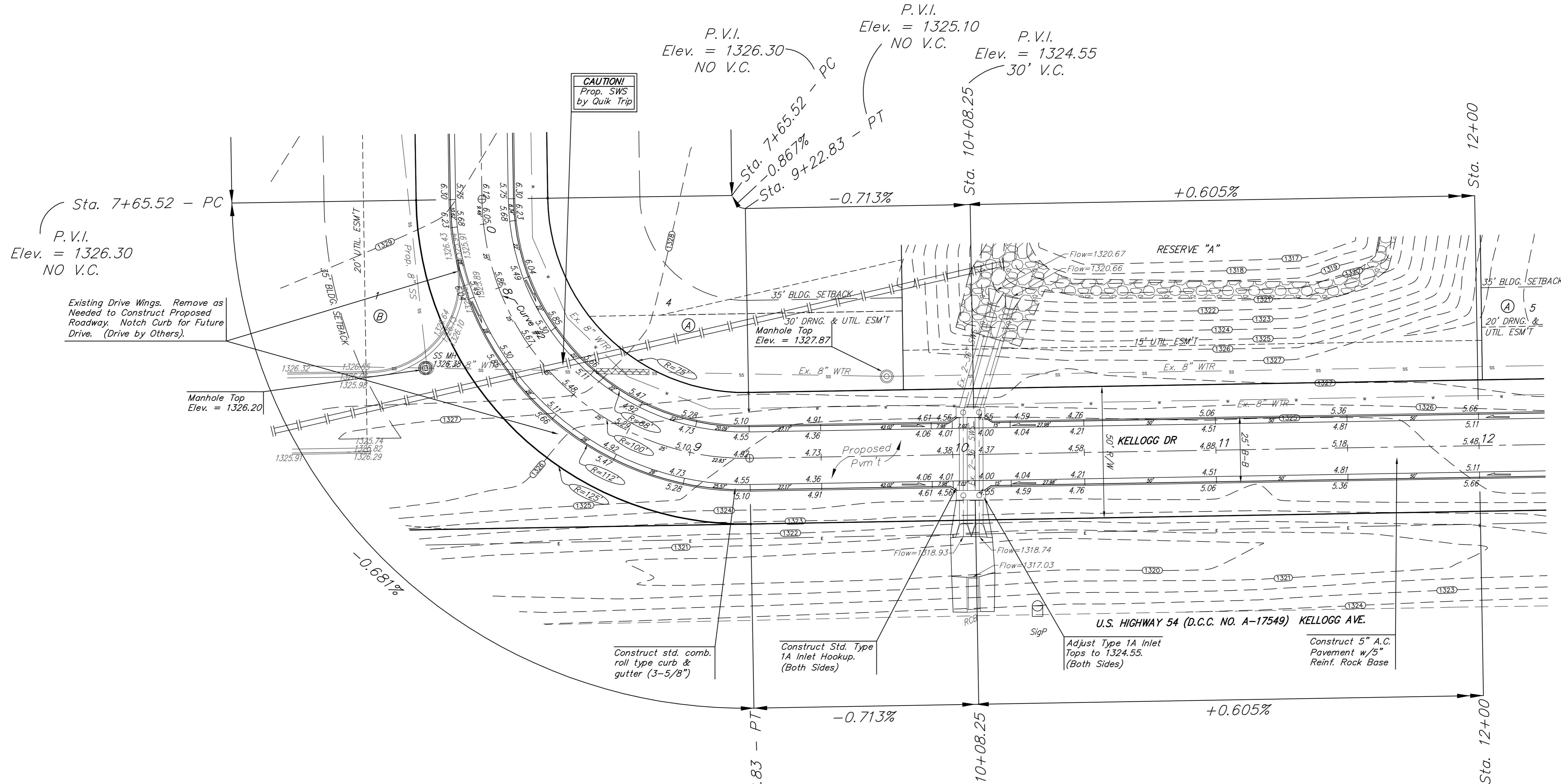
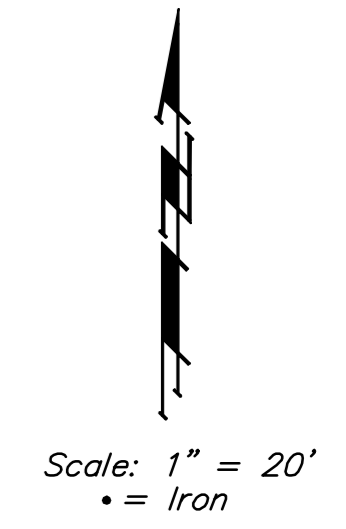

Curve #2  
 Curve Data Based on Centerline  
 Rad. = 100' Delta = 90°07'46" Tangent = 100.23'  
 Arc = 157.31' L.C. = 141.58' Def./Ft. = 17.18825 Min.

Station	Arc	Face Chord Lengths		Defl.	Total Defl.
		8' Left	8' Right		
7+65.52	-	-	-	0°00'00"	0°00'00"
7+75.00	9.48'	7.58'	11.37'	2°42'57"	2°42'57"
8+00.00	25.00'	19.95'	29.92'	7°09'42"	9°52'39"
8+25.00	25.00'	19.95'	29.92'	7°09'42"	17°02'21"
8+50.00	25.00'	19.95'	29.92'	7°09'43"	24°12'04"
8+75.00	25.00'	19.95'	29.92'	7°09'42"	31°21'46"
9+00.00	25.00'	19.95'	29.92'	7°09'43"	38°31'29"
9+22.83	22.83'	18.22'	27.34'	6°32'24"	45°03'53"

P.V.I.  
 Elev. = 1325.10  
 NO V.C.

P.V.I.  
 Elev. = 1324.55  
 30' V.C.

P.V.I.  
 Elev. = 1325.10  
 NO V.C.

NOTE:  
 ROLL TYPE CURB & GUTTER TO  
 BE CONSTRUCTED ON THE  
 PAVEMENT SHOWN ON THIS SHEET.  
 TOP OF CURB ELEVATIONS ARE  
 GIVEN FOR FULL HEIGHT CURB.

**Baughman** Prairie Pond Plaza 2nd Addition  
**KELLOGG DRIVE**  
 Sta. 7+65.52 to 12+00

Baughman Company, P.A. 315 Ellis St. Wichita, KS 67211 P 316262-7271 F 316262-0149  
 ENGINEERING | SURVEYING | PLANNING | LANDSCAPE ARCHITECTURE

PROJECT NUMBER 472-84686	DESIGN MWS	DRAWN JRW
REVISIONS:	APPROVED MWS	DATE 5-09-08
SCALE Noted		SHEET 7 OF 21

E:\Prairie Pond Plaza\Street & Water\05-08\_Str.dwg 05-05-E249