

Q CURVE DATA
 A=89°40'0"R D=60' 18" 40.9" R=95.00' L=148.67' T=94.45' F=38.96'
 CURVE DATA BASED ON Q radius Δ/2= 44° 50' 0"

Q STATION	Q ARC LENGTH	FACE CURB LENGTH		CHORD LENGTH		DEFLECTION ANGLE	Q TOTAL DEFLECTION
		LEFT CURB	RIGHT CURB	8' OFF LEFT FACE CURB	8' OFF RIGHT FACE CURB		
32+95.48						0°00'00.0"	0°00'00.0"
33+00.00	4.52'	5.00'	4.04'	5.38'	3.66'	01°21'46.9"	01°21'46.9"
33+25.00	25.00'	27.63'	22.37'	29.65'	20.20'	07°32'20.1"	08°54'07.1"
33+46.88	21.88'	24.18'	19.58'	25.97'	17.70'	06°35'53.0"	15°30'1.1"
33+50.00	3.12'	3.45'	2.79'	3.71'	2.53'	00°56'27.1"	16°26'27.2"
33+75.00	25.00'	27.63'	22.37'	29.65'	20.20'	07°32'20.1"	23°58'47.3"
34+00.00	25.00'	27.63'	22.37'	29.65'	20.20'	07°32'20.1"	31°31'07.5"
34+25.00	25.00'	27.63'	22.37'	29.65'	20.20'	07°32'20.1"	39°03'27.6"
34+44.15	19.15'	21.17'	17.14'	22.74'	15.50'	05°46'29.3"	44°50'1.1"
TOTAL	148.67'	164.32'	133.02'				

Defl./ft. = 18.093404 min.

Q CURVE DATA
 A=90°20'0"R D=60' 18" 40.9" R=95.00' L=148.78' T=95.55' F=39.74'
 CURVE DATA BASED ON Q radius Δ/2= 45° 9' 60"

Q STATION	Q ARC LENGTH	FACE CURB LENGTH		CHORD LENGTH		DEFLECTION ANGLE	Q TOTAL DEFLECTION
		LEFT CURB	RIGHT CURB	8' OFF LEFT FACE CURB	8' OFF RIGHT FACE CURB		
62+94.37						0°00'00.0"	0°00'00.0"
63+00.00	5.63'	5.04'	6.22'	4.56'	6.70'	01°41'52.0"	01°41'52.0"
63+25.00	25.00'	22.37'	27.63'	20.20'	29.65'	07°32'20.1"	09°14'12.1"
63+46.88	21.88'	19.58'	24.18'	17.70'	25.97'	06°35'53.0"	15°50'05.1"
63+50.00	3.12'	2.79'	3.45'	2.53'	3.71'	00°56'27.1"	16°46'32.2"
63+75.00	25.00'	22.37'	27.63'	20.20'	29.65'	07°32'20.1"	24°18'52.3"
64+00.00	25.00'	22.37'	27.63'	20.20'	29.65'	07°32'20.1"	31°51'12.5"
64+25.00	25.00'	22.37'	27.63'	20.20'	29.65'	07°32'20.1"	39°23'32.6"
64+44.15	19.15'	17.13'	21.16'	15.49'	22.74'	05°46'29.3"	45°10'1.1"
TOTAL	149.78'	134.01'	165.54'				

Defl./ft. = 18.093404 min.

WATER VALVE BOX ELEVATIONS

STREET	STATION	OFFSET	PROPOSED ELEVATION
JARDINE DRIVE (LOOP)	81+45.88	24"LL	129.9
JARDINE DRIVE (LOOP)	81+48.56	21.3"LL	129.9

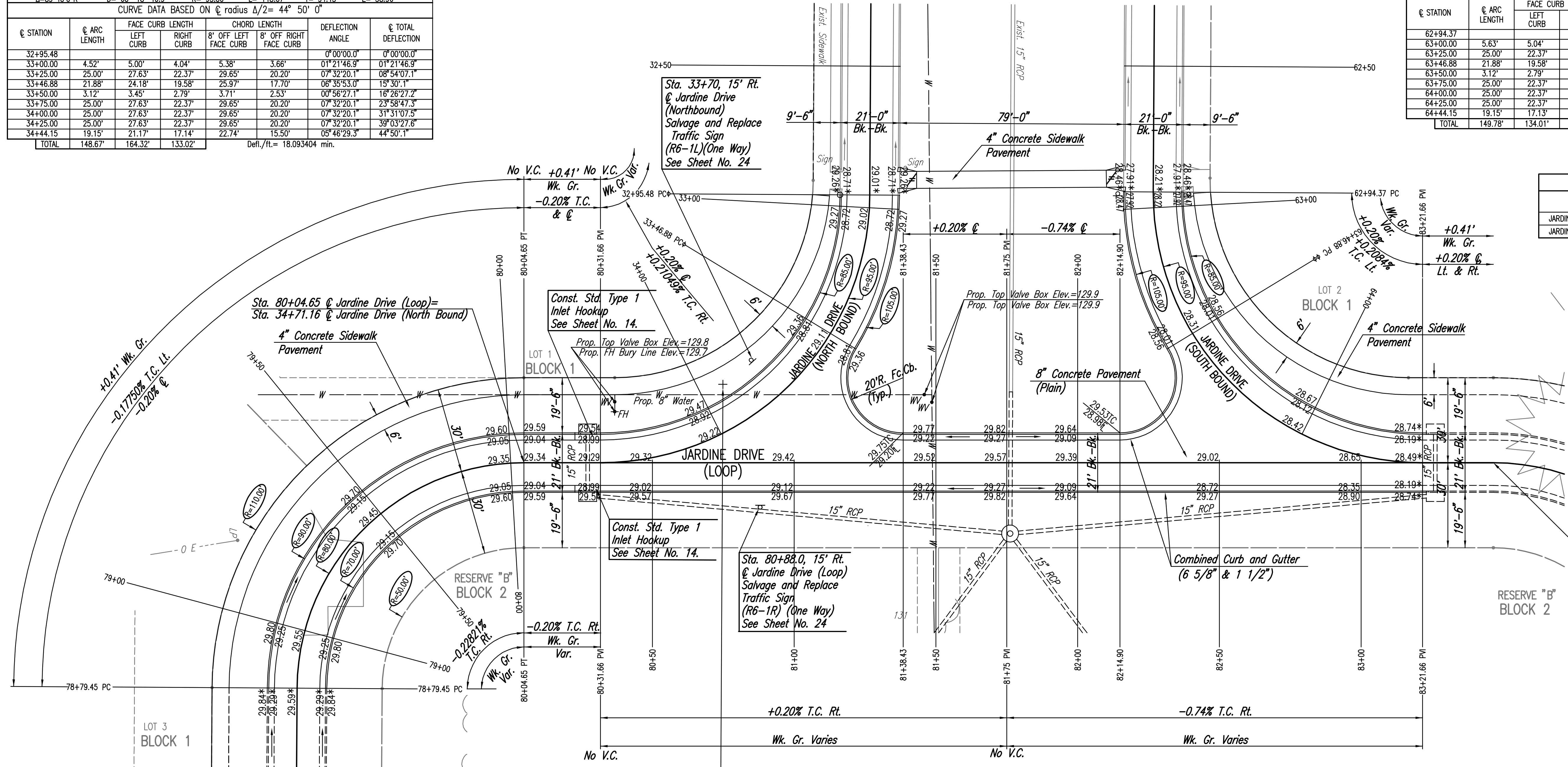

Q CURVE DATA
 A=89°40'0"R D=71° 37' 11" R=80.00' L=125.2' T=79.54' F=32.81'
 CURVE DATA BASED ON Q radius Δ/2= 44° 50' 0"

Q STATION	Q ARC LENGTH	FACE CURB LENGTH		CHORD LENGTH		DEFLECTION ANGLE	Q TOTAL DEFLECTION
		LEFT CURB	RIGHT CURB	8' OFF LEFT FACE CURB	8' OFF RIGHT FACE CURB		
78+79.45						0°00'00.0"	0°00'00.0"
79+00.00	20.55'	23.12'	17.98'	25.10'	15.88'	07°21'32.2"	07°21'32.2"
79+25.00	25.00'	28.12'	21.88'	30.50'	19.30'	08°57'08.9"	16°18'41.1"
79+50.00	25.00'	28.12'	21.88'	30.50'	19.30'	08°57'08.9"	25°15'50.0"
79+75.00	25.00'	28.12'	21.88'	30.50'	19.30'	08°57'08.9"	34°12'58.9"
80+00.00	25.00'	28.12'	21.88'	30.50'	19.30'	08°57'08.9"	43°10'07.8"
80+04.65	4.65'	5.23'	4.07'	5.69'	3.60'	01°39'54.6"	44°50'1.1"
TOTAL	125.2'	140.85'	109.55'				

Defl./ft. = 21.485918 min.

◆ RIGHT STA. NORTHBOUND
 ◆ LEFT STA. SOUTHBOUND
 * Match Existing
 ≠ Construct Wheelchair Ramp
 See Sheet No. 7 for Jointing Layout

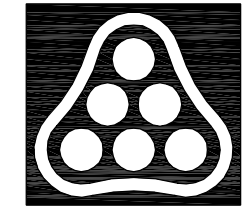

Revision By Date

21ST STREET KIDS AND FAMILY EMPOWERMENT
 JARDINE DRIVE-PHASE 2
JARDINE DRIVE
 STA. 78+79.45 TO STA. 83+21.66 (LOOP)
 JAMES L. ARMOUR, P.E.- CITY ENGINEER
 CITY OF WICHITA PROJECT NO. 472-84282

Professional Engineering Consultants, P.A.
 303 S. TOPKA • WICHITA, KANSAS 67202
 316-262-2691 • FAX 316-262-3003

Designed by BDB, BMM Job No. 35-05416-004 Sheet 6 of 32
 Drawn by BJS, TAT Date October 2005

Saved: 02-21-2007 10:36:32 AM by: BJS
 Plot: Scale: 1:20 02-21-2007 4:37:32 PM by: BJS
 J:\SENTOUT\2005\05416\004\2007-02-21 to City\DWG\05-PAVING PLAN-JARDINE DR