

PARKING BAY (NORTH)

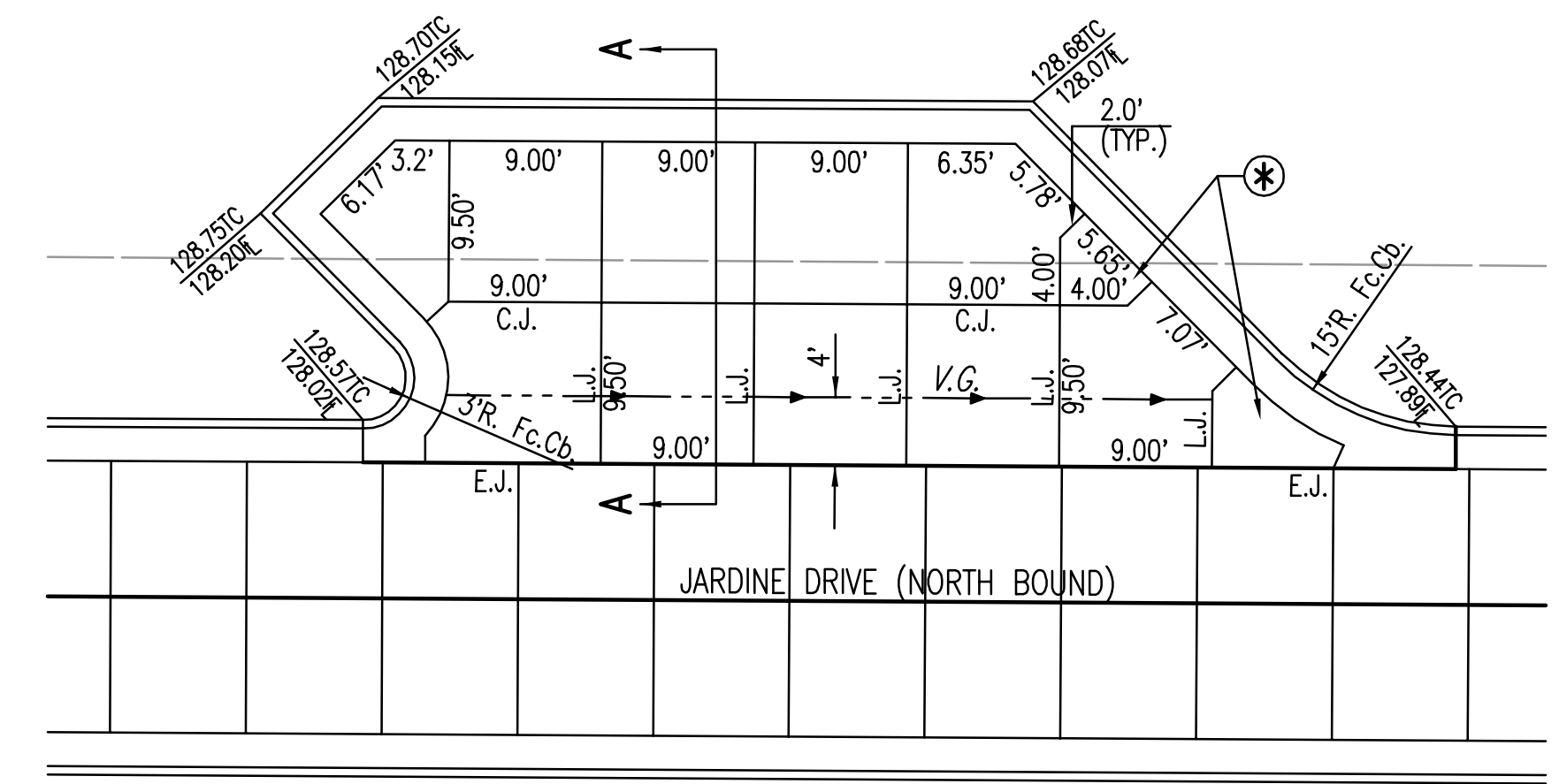

PARKING BAY (SOUTH)

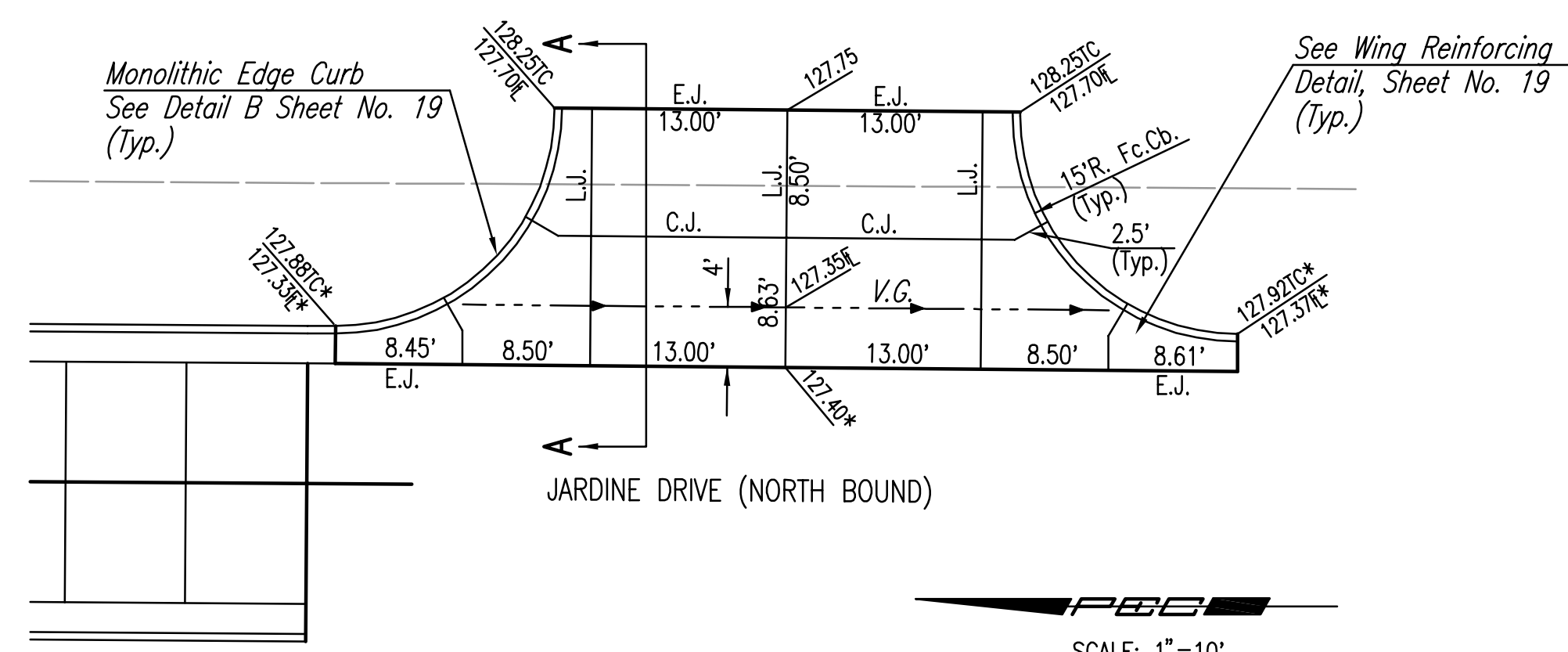

ENTRANCE (SOUTH)



SCALE: 1"=10'

LEGEND

- E.J. EXPANSION JOINT
 - L.J. LONGITUDINAL JOINT (TIED)
 - C.J. CONTRACTION JOINT
 - C.J.* CONTRACTION JOINT (TIED)
 - ▲ 6' TRANSITION TO NO CURB
- SEE SHEET NO. 19 FOR JOINT DETAILS.

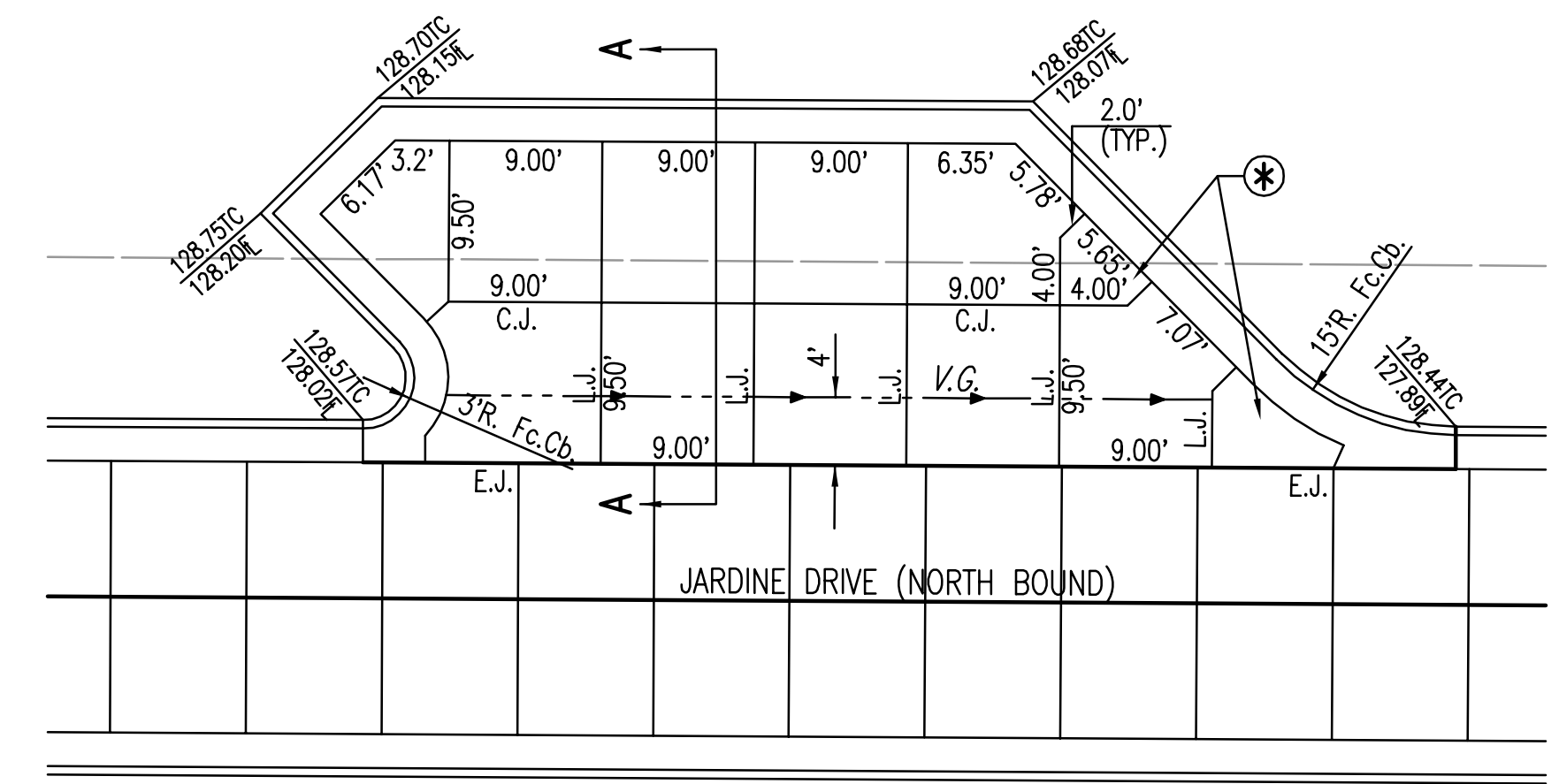

PARKING BAY (SOUTH)



SCALE: 1"=10'

See Sheet No. 19 for Section A-A.
 * Indicated Panel to be Reinforced with 6x6, W4xW4 Welded Wire Fabric.
 Reinforcement of the indicated panels shall be subsidiary to "Concrete Pavement (8)".

Sowed 12-20-2005 1:40:52 PM by BBS
 Plot Scale 1:10 12-21-2005 8:07:06 AM by GSG
 J:\SENTOUT\2005\05416\2005-12-20 to City\ paving and Drain\DWG\18-PARKING BAY JOINTING PLANS

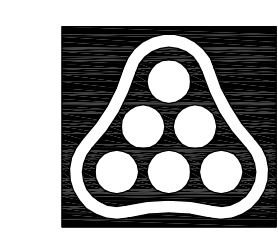

No.	Revision	By	Date
21ST STREET KIDS AND FAMILY EMPOWERMENT PARKING BAY AND SOUTH ENTRANCE JOINTING PLANS JAMES L. ARMOUR, P.E.—CITY ENGINEER CITY OF WICHITA PROJECT NO. 472-84282 Professional Engineering Consultants, P.A. 303 S. TOPEKA • WICHITA, KANSAS 67202 316-262-2691 • FAX 316-262-3003			
Designed by	BLB, BDB	Job No.	35-05416-000
Drawn by	SAW	Date	OCTOBER 2005