

WATER VALVE BOX ELEVATIONS			
STREET	STATION	OFFSET	PROPOSED ELEVATION
RUTGERS	15+42.73	26.0' Lt.	175.2
RUTGERS	15+45.53	23.0' Lt.	175.0

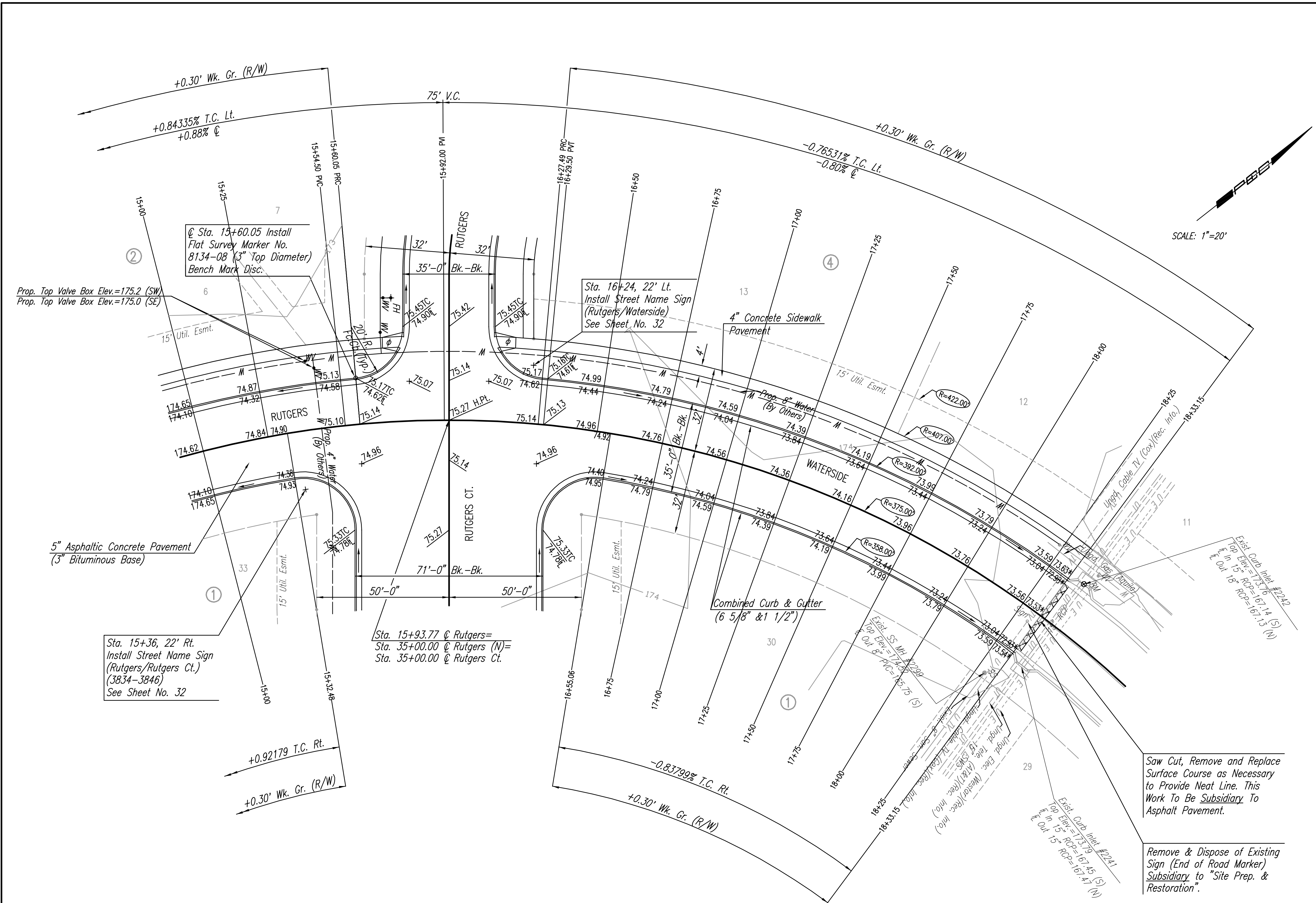

© CURVE DATA
 $d=117^{\circ}22'53''R$ $D=15^{\circ}16'43.9''$ $R=375.00'$ $L=768.26'$ $T=616.54'$ $E=346.63'$
 CURVE DATA BASED ON ϕ radius $d/2=56^{\circ}41'26.5''$

STATION	ARC LENGTH	FACE CURB LENGTH		CHORD LENGTH		DEFLECTION ANGLE	TOTAL DEFLECTION
		LEFT CURB	RIGHT CURB	B' OFF LEFT FACE CURB	B' OFF RIGHT FACE CURB		
13+42.45	7.55'	7.89'	7.21'	8.05'	7.05'	0°00'00.0"	0°00'00.0"
13+50.00	25.00'	26.13'	23.87'	26.66'	23.33'	01°54'35.5"	02°34'36.4"
13+75.00	25.00'	26.13'	23.87'	26.66'	23.33'	01°54'35.5"	04°23'47.4"
14+00.00	25.00'	26.13'	23.87'	26.66'	23.33'	01°54'35.5"	06°18'22.9"
14+25.00	25.00'	26.13'	23.87'	26.66'	23.33'	01°54'35.5"	08°12'58.4"
14+50.00	25.00'	26.13'	23.87'	26.66'	23.33'	01°54'35.5"	10°07'33.9"
14+75.00	25.00'	26.13'	23.87'	26.66'	23.33'	01°54'35.5"	12°02'09.4"
15+00.00	25.00'	26.13'	23.87'	26.66'	23.33'	01°54'35.5"	13°56'44.9"
15+25.00	25.00'	26.13'	23.87'	26.66'	23.33'	01°54'35.5"	15°51'20.4"
15+50.00	25.00'	26.13'	23.87'	26.66'	23.33'	01°54'35.5"	17°45'55.9"
15+75.00	25.00'	26.13'	23.87'	26.66'	23.33'	01°54'35.5"	19°40'31.4"
16+00.00	25.00'	26.13'	23.87'	26.66'	23.33'	01°54'35.5"	21°35'06.9"
16+25.00	25.00'	26.13'	23.87'	26.66'	23.33'	01°54'35.5"	23°29'42.4"
16+50.00	25.00'	26.13'	23.87'	26.66'	23.33'	01°54'35.5"	25°24'17.9"
16+75.00	25.00'	26.13'	23.87'	26.66'	23.33'	01°54'35.5"	27°18'53.4"
17+00.00	25.00'	26.13'	23.87'	26.66'	23.33'	01°54'35.5"	29°13'28.9"
17+25.00	25.00'	26.13'	23.87'	26.66'	23.33'	01°54'35.5"	31°08'04.4"
17+50.00	25.00'	26.13'	23.87'	26.66'	23.33'	01°54'35.5"	33°02'39.9"
17+75.00	25.00'	26.13'	23.87'	26.66'	23.33'	01°54'35.5"	34°57'15.4"
18+00.00	25.00'	26.13'	23.87'	26.66'	23.33'	01°54'35.5"	36°51'50.9"
18+25.00	25.00'	26.13'	23.87'	26.66'	23.33'	01°54'35.5"	37°46'26.4"
18+50.00	25.00'	26.13'	23.87'	26.66'	23.33'	01°54'35.5"	38°41'01.9"
18+75.00	25.00'	26.13'	23.87'	26.66'	23.33'	01°54'35.5"	39°35'37.4"
19+00.00	25.00'	26.13'	23.87'	26.66'	23.33'	01°54'35.5"	40°30'12.9"
19+25.00	25.00'	26.13'	23.87'	26.66'	23.33'	01°54'35.5"	41°24'48.4"
19+50.00	25.00'	26.13'	23.87'	26.66'	23.33'	01°54'35.5"	42°19'23.9"
19+75.00	25.00'	26.13'	23.87'	26.66'	23.33'	01°54'35.5"	43°13'59.4"
20+00.00	25.00'	26.13'	23.87'	26.66'	23.33'	01°54'35.5"	44°08'34.9"
20+25.00	25.00'	26.13'	23.87'	26.66'	23.33'	01°54'35.5"	45°03'10.4"
20+50.00	25.00'	26.13'	23.87'	26.66'	23.33'	01°54'35.5"	45°57'45.9"
20+75.00	25.00'	26.13'	23.87'	26.66'	23.33'	01°54'35.5"	46°52'21.4"
21+00.00	25.00'	26.13'	23.87'	26.66'	23.33'	01°54'35.5"	47°46'56.9"
21+10.71	10.71'	11.11'	10.31'	10.88'	9.71'	00°49'05.5"	58°41'26.7"
TOTAL	768.26'	442.40'	351.48'				Defl./ft. = 4.583662 min.

Saw Cut, Remove and Replace Surface Course as Necessary to Provide Neat Line. This Work to Be Subsidiary To Asphalt Pavement.

Remove & Dispose of Existing Sign (End of Road Marker) Subsidiary to "Site Prep. & Restoration".

* Match Existing
 φ Construct Std. Wheelchair Ramp

Sowed 05-01-2007 6:07:56 PM by BEJ
 Plot Scale 1:20 05-02-2007 12:17:23 PM by BEJ
 J:\SENTOU\2006\06563\2007-05-01 to City\Street\DWG\10-STR RUTGERS-WATERSIDE

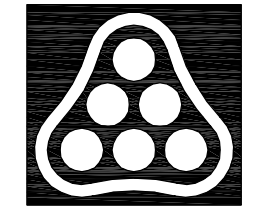

No.	Revision	By	Date
PRAIRIE POINTE-PHASE 3 RUTGERS/WATERSIDE STA. 15+00.00 TO STA. 18+33.15 JAMES L. ARMOUR, P.E.-CITY ENGINEER CITY OF WICHITA PROJECT NO. 472-84043 Professional Engineering Consultants, P.A. 303 S. TOPEKA • WICHITA, KANSAS 67202 316-262-2691 • FAX 316-262-3003			
Designed by	BDB, BMM	Job No.	35-06563-000
Drawn by	BJS, TAT	Date	October 2006
			Sheet 10 of 56