

**PAVING AND INCIDENTAL DRAINAGE PLANS
FOX RIDGE ADDITION
CONNECTOR PHASE - PART 2**

CURVE TABLE C5					
$\Delta = 42^{\circ}56'01''$ R = 224.00' T = 88.09' L = 167.85' LC = 163.95'					
CURVE DATA BASED ON CENTERLINE $\Delta / 2 = 21^{\circ}28'01''$					
STATION	ARC	CHORD LENGTH		DEFLECTION	TOTAL DEFLECTION
		8' Off LtCb	8' Off RtCb		
10+00.00	-	-	-	00°00'00"	00°00'00"
10+25.00	25.00'	23.09'	-	03°11'50"	03°11'50"
10+50.00	25.00'	23.09'	-	03°11'50"	06°23'41"
10+75.00	25.00'	23.09'	-	03°11'50"	09°35'31"
11+00.00	25.00'	23.09'	-	03°11'50"	12°47'21"
11+25.00	25.00'	23.09'	26.88'	03°11'50"	15°59'12"
11+50.00	25.00'	23.09'	26.88'	03°11'50"	19°11'02"
11+67.85	17.85'	16.49'	19.20'	02°16'59"	21°28'01"

Def/Ft = 7.67354 Min.

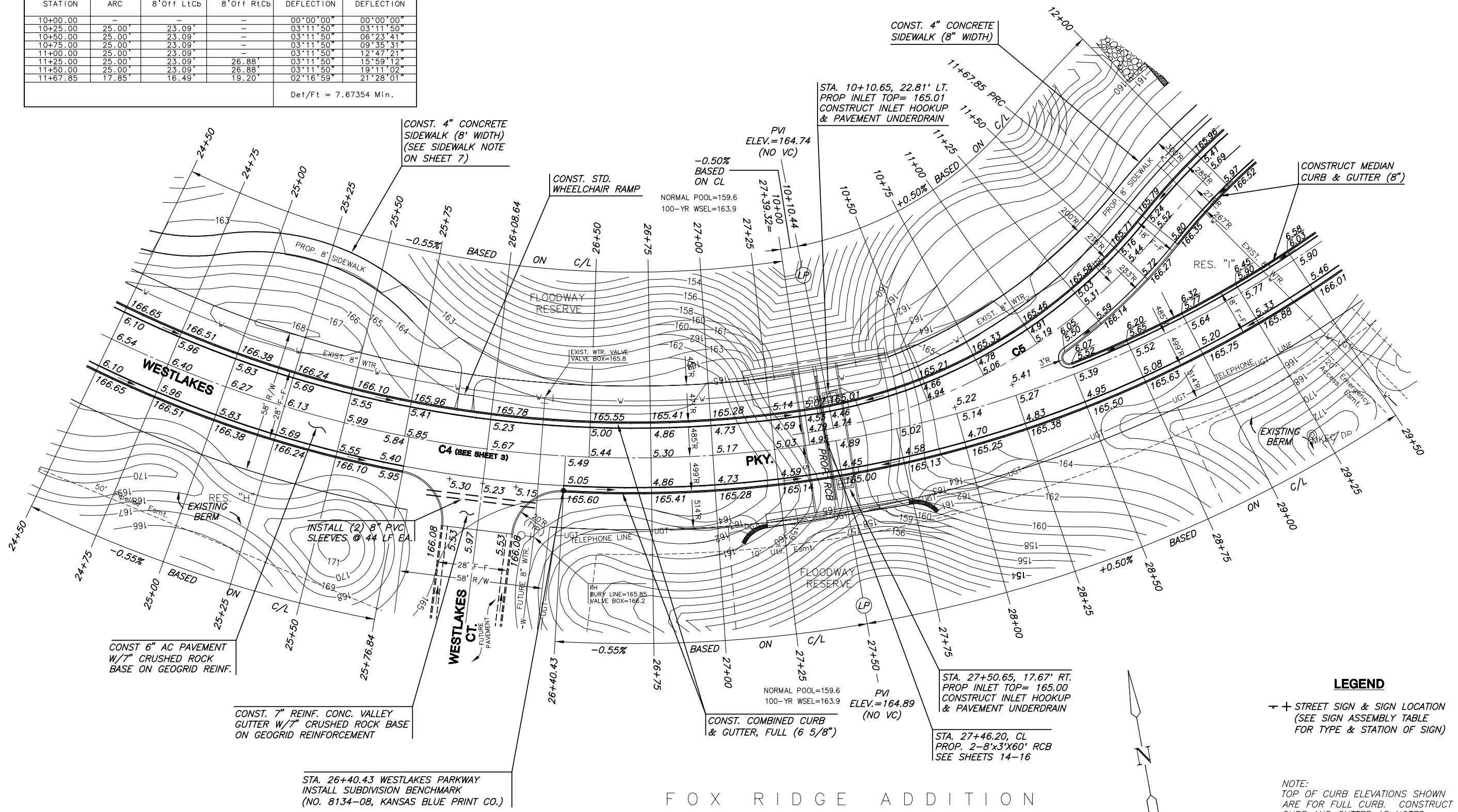

LEGEND
 + + STREET SIGN & SIGN LOCATION
 (SEE SIGN ASSEMBLY TABLE FOR TYPE & STATION OF SIGN)

NOTE:
 TOP OF CURB ELEVATIONS SHOWN ARE FOR FULL CURB. CONSTRUCT CURB AND GUTTER AS NOTED.

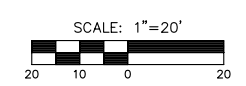

FOX RIDGE ADDITION

WESTLAKES PKY
 SHEET TITLE
 472-84421
 PROJECT NUMBER

DFL
 DESIGN BY
 MKEC
 DRAWN BY
 GJA
 CHECKED BY

ISSUED
 September 2006

REVISIONS

SHEET NO.
 9 of 31