

MAPLE
WEST STREET

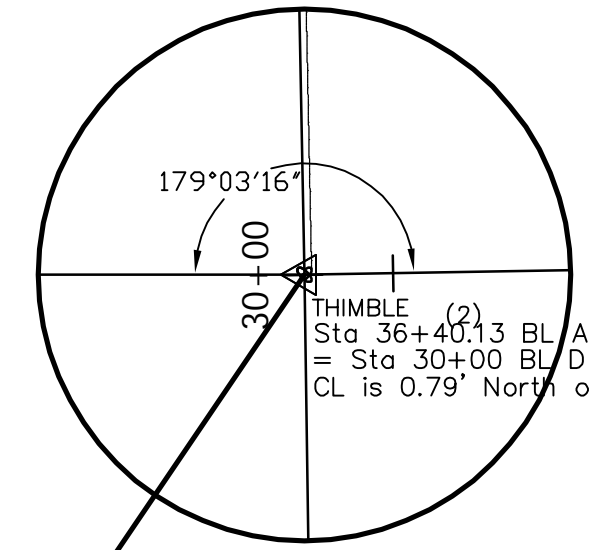

2nd STREET
WEST STREET

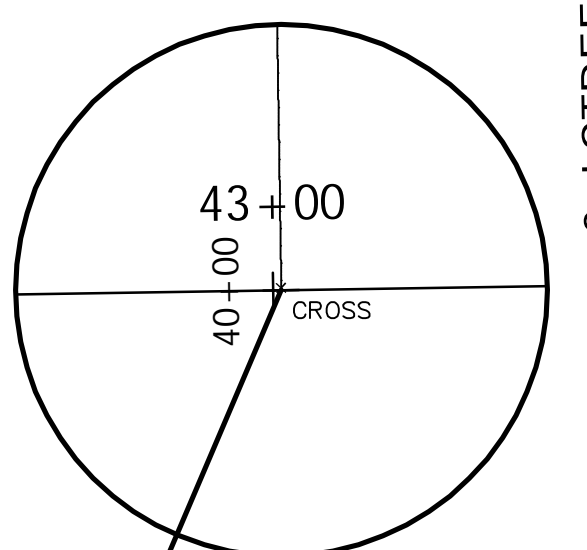

3rd STREET
WEST STREET

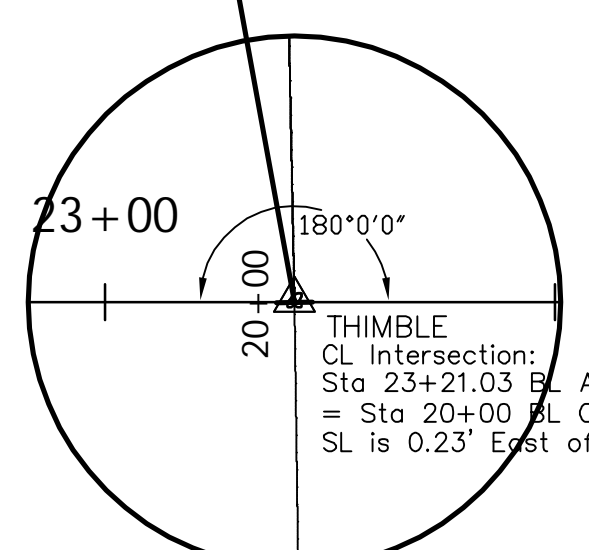

DOUGLAS
WEST STREET

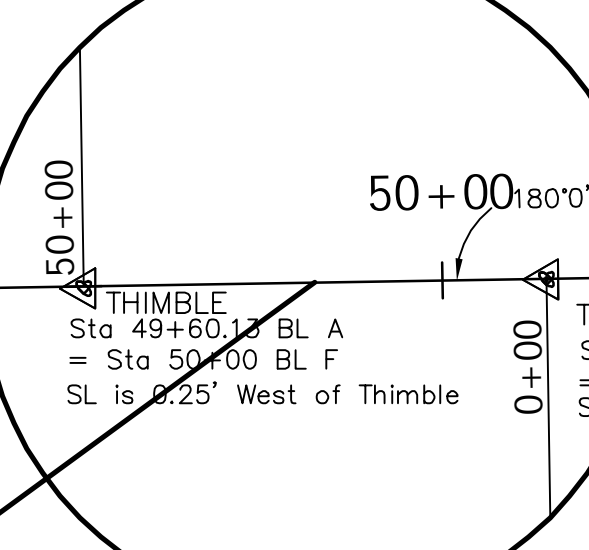

ST. LOUIS
WEST STREET

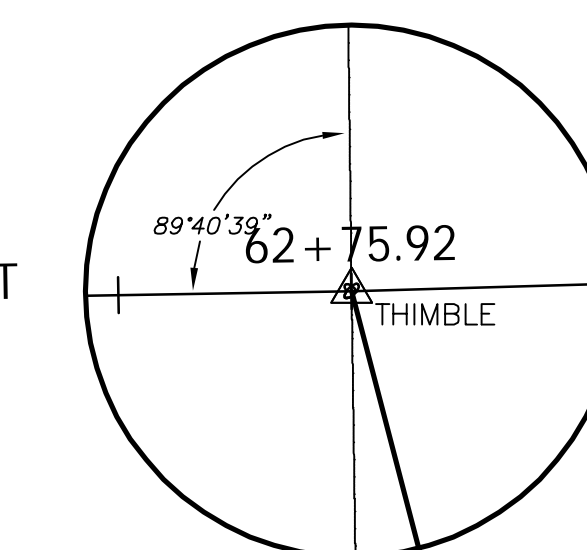

CENTRAL
WEST STREET

- BENCHMARKS:**
 BM#1 - Top of B-Rebar in Concrete 490' S and 60' W of CL Maple and West
 BM#2 - Small RR Spike in P.P. S face, 500± W and 35± N of CL Maple and West
 BM#3 - "□" Top of Concrete Retaining Wall SE Corner at NW Corner Maple
 BM#4 - West Street and Maple City of Wichita District SW Corner on Traffic Signal Light Base in Turn Island Elev. = 117.02'
 BM#5 - "□" on W End of Median 6.0' S and 44.0' E of CL of Both Maple and West Street Elev. = 117.65' City Datum

- BM#6 - "□" on Top Parking Island 7.0' N and 24.0' W of the NW Corner Bldg. #220 (West Street) Elev. = 120.44' City Datum
 BM#7 - "□" on Top of 0.8' Curb at SW Corner Lot 4, Black and Towns Addition, 156± E and 40± N of CL of Both Douglas and West Street Elev. = 118.76' City Datum
 BM#8 - "□" on Concrete Next to Walk 10.0' E of the SE Corner Bldg. #215, Bosley Tire (West Street) Elev. = 118.95' City Datum
 BM#9 - City Disc 34.0' W and 18.0' S of CL of Both 2nd Street and West Street Elev. = 118.87' City Datum

- BM#10 - "□" on Concrete Walk 2.0' E of the NE Step at the SE Corner Bldg. #341 (West Street) Elev. = 121.40' City Datum
 BM#11 - "□" on Top of Walk 8.0' W of the NE Corner Bldg. #540 (West Street) Elev. = 121.78' City Datum
 BM#12 - "□" on Top of Retaining Wall 50.0' N and 50.0' W of CL of Both Central and West Street Elev. = 122.53' City Datum
 BM#13 - "+" Top of Bolt SW Corner of W Sign Pole Base Hest and Central Intersection

Drawing File: E:/eng/West Street Paving New/Details/SH 02 West St keysheet.dwg
 Design: T. Aziere
 Drawn: Sonny
 Approved: J. F. Bradley
 Scale: 1:10
 Project No. 04-04-EB59 CAPITAL IMPROVEMENT PROJECT
WEST STREET PAVING
KEYSHEET
 PAVEMENT, STORM WATER SEWER, TRAFFIC CONTROL IMPROVEMENTS

Baughman **Baughman Company, P.A.**
 315 Ellis St. Wichita, KS 67211 P 316-262-7271 F 316-262-0149
 ENGINEERING | SURVEYING | PLANNING | LANDSCAPE ARCHITECTURE