

Remove Exstg Manhole, Inlets, and Pipe as shown. Abandon Exstg SWS Pipe N & S in Place & Plug

See Sht 48
LINE 2C Profile

Sta 0+69.13 LINE 2C =
Sta 43+99.50, 33.67' Lt BL A
Construct Type 1A Inlet (Double)
(11'4" x 4'4")
Elev= 118.02Top

Sta 44+11.50, 33.67' Lt BL A
Construct Type 1A Inlet (Double)
(11'4" x 4'4")
Elev= 118.09Top

CAUTION!
OH ELEC
12" GAS
24" SWS (Aband)
Crosses

Sta 0+67.33 LINE 2D =
Sta 46+52.00, 33.67' Lt BL A
Construct Type 1A Inlet (Single)
(6'4" x 4'4")
Elev= 119.33Top

See Sht 48
LINE 2D Profile

CAUTION!
WSL
OH ELEC
UG AT&T
Crosses

Sta 13+85.27 LINE 2
= Sta 43+77.00, 34.67' Rt BL A
Construct Type 1A Inlet (Double)
(11'4" x 6'4") per Dtl Sheet
Elev= 118.10Top

Sta 13+97.27 LINE 2
= Sta 43+89.00, 34.67' Rt BL A
= Sta 0+00 LINE 2C
Construct Type 1A Inlet (Double)
(11'4" x 6'4") per Dtl Sheet
Elev= 118.02Top

CAUTION!
WSL
OH ELECx2
4" GAS
12" WIR (Aband)
8" GAS
AT&T DUCT
WSL
GSL
Crosses

CAUTION!
OH ELEC
GSLx2
WSL
Crosses

Sta 16+60.28 LINE 2
= Sta 46+52.00, 34.17' Rt BL A
= Sta 0+00 LINE 2D
Construct Type 1A Inlet (Single)
(6'4" x 5'4") per Dtl Sheet
Elev= 119.33Top

CAUTION!
AT&T DUCT
8" GAS
12" WIR (Aband)
OH ELEC
4" GAS
OH ELEC
GSL
WSL
Crosses

NOTE: Contractor to use caution during excavation on this Project. Multiple Underground Utilities parallel and cross New Construction. Underground Utilities are shown located according to the best information available at the time of drawing. Contractor to FIELD VERIFY exact locations and depths PRIOR TO Construction on this Project.

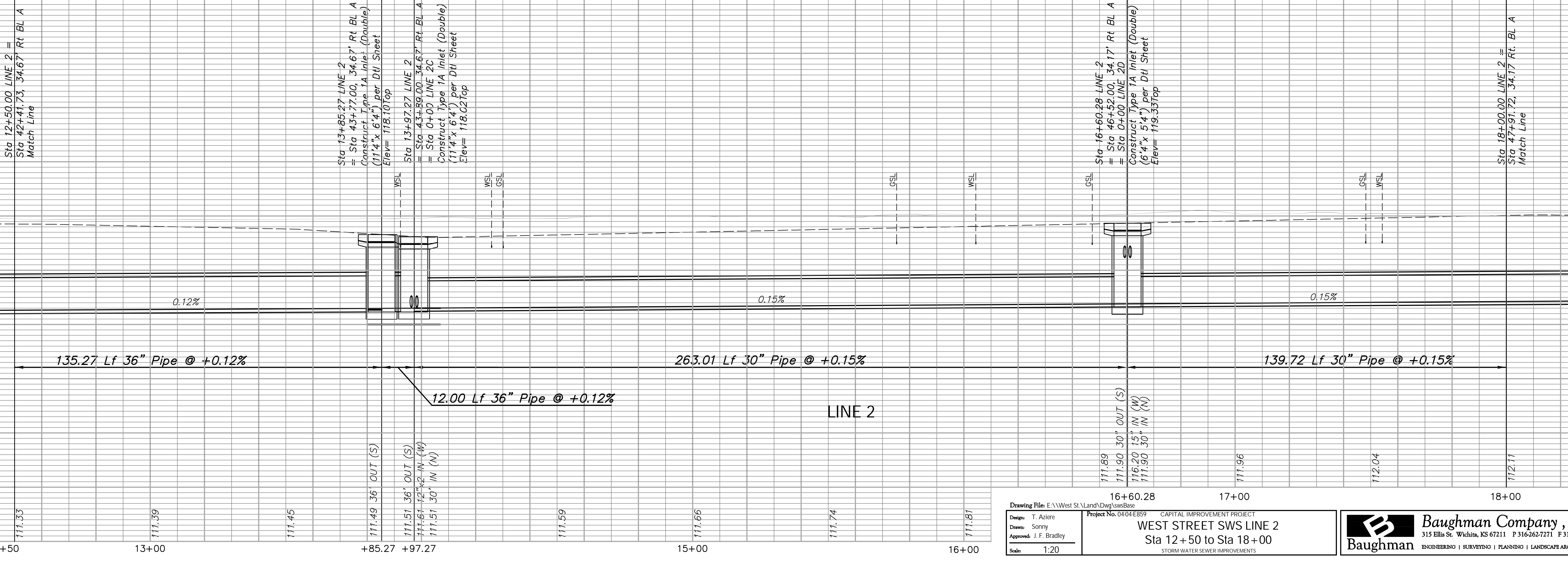

Sta 12+50.00 LINE 2 =
Sta 42+41.73, 34.67' Rt BL A
Match Line

Sta 13+85.27 LINE 2
= Sta 43+77.00, 34.67' Rt BL A
Construct Type 1A Inlet (Double)
(11'4" x 6'4") per Dtl Sheet
Elev= 118.10Top

Sta 13+97.27 LINE 2
= Sta 43+89.00, 34.67' Rt BL A
= Sta 0+00 LINE 2C
Construct Type 1A Inlet (Double)
(11'4" x 6'4") per Dtl Sheet
Elev= 118.02Top

Sta 16+60.28 LINE 2
= Sta 46+52.00, 34.17' Rt BL A
= Sta 0+00 LINE 2D
Construct Type 1A Inlet (Double)
(6'4" x 5'4") per Dtl Sheet
Elev= 119.33Top

Sta 18+00.00 LINE 2 =
Sta 47+91.72, 34.17' Rt. BL A
Match Line