

FHWA REGION NO.	STATE	PROJECT NO.	FISCAL YEAR	SHEET NO.	TOTAL SHEETS
7	KANSAS	87N-0459-01	2009	2	32

Fed. Aid # HSIP-N045(901)

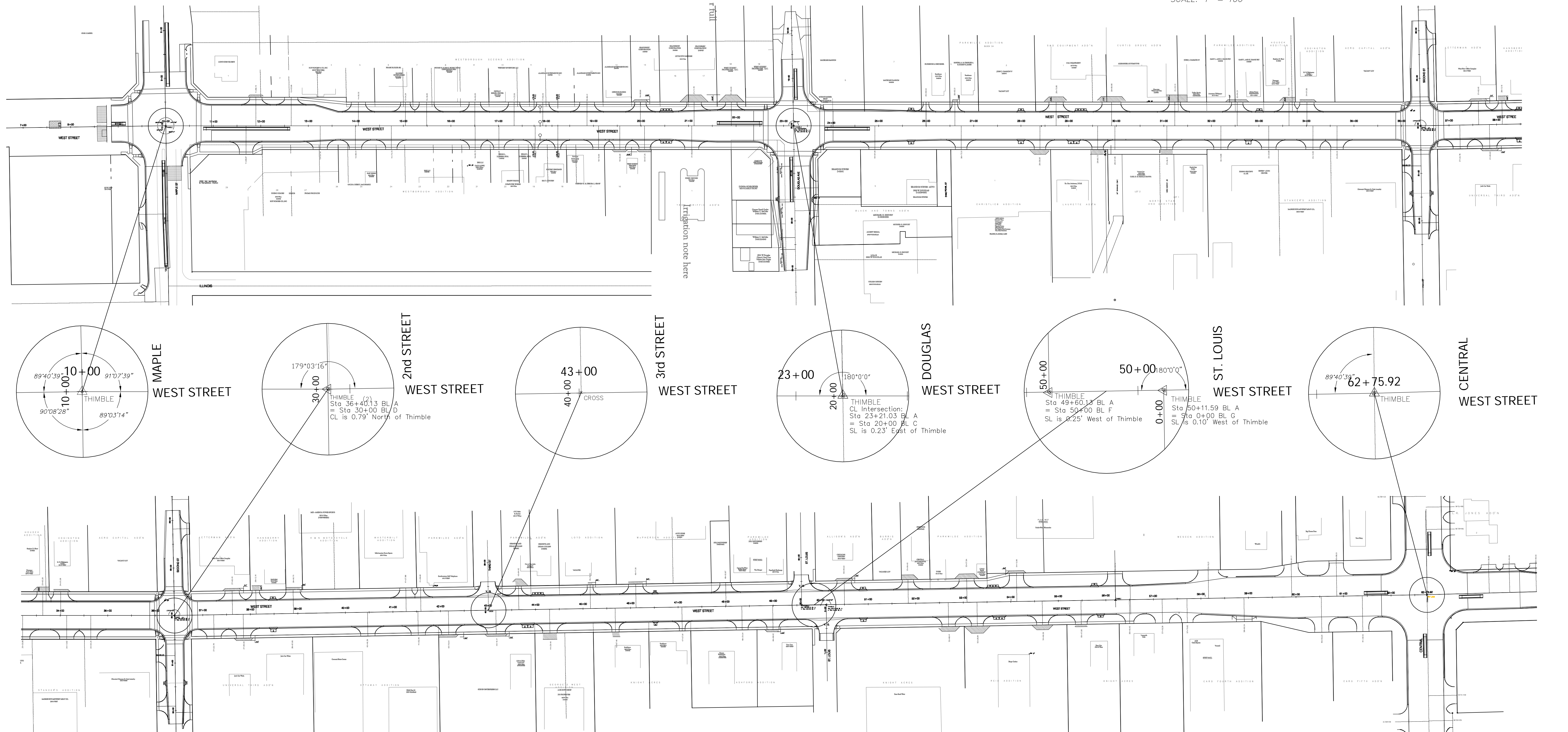
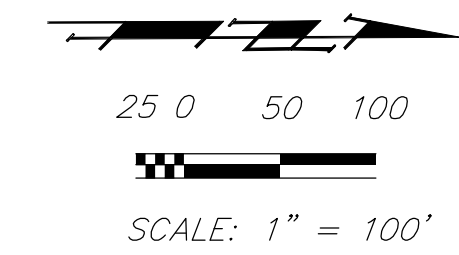

- BENCHMARKS:**
- BM#1 - Top of B-Rebar in Concrete 490' S and 60' W of CL Maple and West
 - BM#2 - Small RR Spike in P.P. S face, 500± W and 35± N of CL Maple and West
 - BM#3 - "□" Top of Concrete Retaining Wall SE Corner at NW Corner Maple
 - BM#4 - West Street and Maple City of Wichita District SW Corner on Traffic Signal Light Base in Turn Island Elev. = 117.02'
 - BM#5 - "□" on W End of Median 6.0' S and 44.0' E of CL of Both Maple and West Street Elev. = 117.65' City Datum

- BM#6 - "□" on Top Parking Island 7.0' N and 24.0' W of the NW Corner Bldg. #220 (West Street) Elev. = 120.44' City Datum
- BM#7 - "□" on Top of 0.8' Curb at SW Corner Lot 4, Black and Towns Addition, 156± E and 40± N of CL of Both Douglas and West Street Elev. = 118.76' City Datum
- BM#8 - "□" on Concrete Next to Walk 10.0' E of the SE Corner Bldg. #215, Bosley Tire (West Street) Elev. = 118.95' City Datum
- BM#9 - City Disc 34.0' W and 18.0' S of CL of Both 2nd Street and West Street Elev. = 118.87' City Datum

- BM#10 - "□" on Concrete Walk 2.0' E of the NE Step at the SE Corner Bldg. #341 (West Street) Elev. = 121.40' City Datum
- BM#11 - "□" on Top of Walk 8.0' W of the NE Corner Bldg. #540 (West Street) Elev. = 121.78' City Datum
- BM#12 - "□" on Top of Retaining Wall 50.0' N and 50.0' W of CL of Both Central and West Street Elev. = 122.53' City Datum
- BM#13 - "±" Top of Bolt SW Corner of W Sign Pole Base Hest and Central Intersection

Drawing File: E:\eng\West Street Paving New\Details\KDOT West and 2nd\SH 02 2nd St Keysheet.dwg

Design: T. Azlere	Project No: 04-04-E859	CAPITAL IMPROVEMENT PROJECT
Drawn: Sorin	WEST STREET PAVING	
Approved: J. F. Bradley	KEYSHEET	
Scale: 1:10	PAVEMENT, STORM WATER/SEWER, TRAFFIC CONTROL IMPROVEMENTS	

November 2008

Baughman Company, P.A.
315 Ellis St. Wichita, KS 67211 P 316-262-1271 F 316-262-0149

SHEET 2 OF 32