

FLUME DETAIL

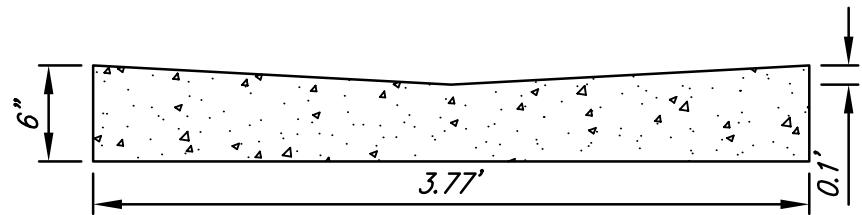

NOTE: 5" AC PAVEMENT (3" BIT. BASE) TO BE USED IN ALL "REMOVE/REPLACE ASPHALT" AREAS

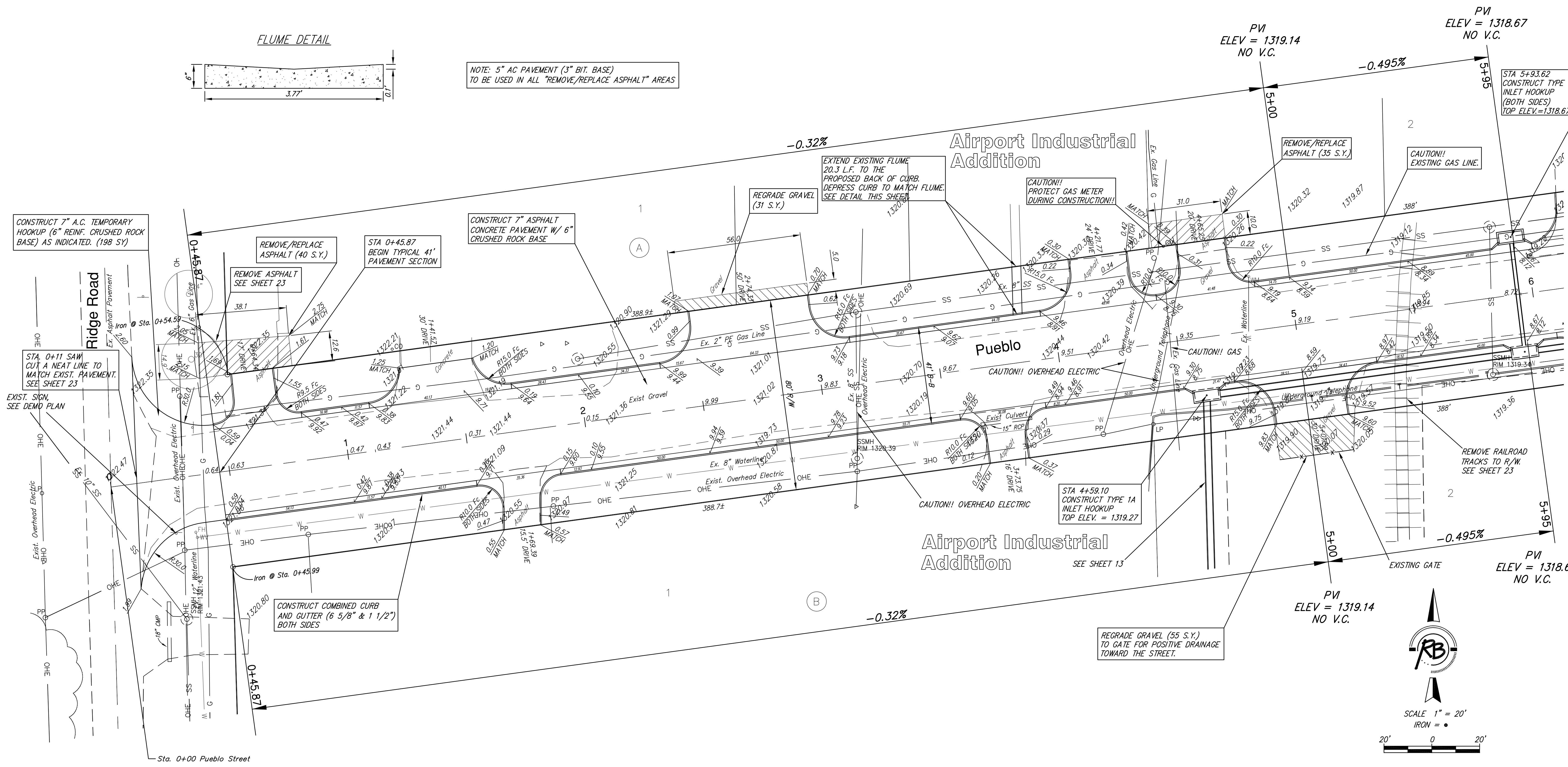

NOTE: EXISTING SANITARY SEWER MANHOLE TOP ADJUSTMENTS AND GRAVEL/ASPHALT/CONCRETE REMOVAL QUANTITY DETAILS ON DEMO PLAN SHEET SEE SHEET 23.



SCALE 1" = 20'
IRON = ●

Airport Industrial Addition PUEBLO WICHITA, KANSAS	
 Ruggles & Bohm, P.A. Engineering, Surveying, Land Planning	
924 North Main Wichita, Kansas 67203 www.rbkansas.com	(316) 264-8008 (316) 264-4621 fax E-mail: info@rbkansas.com
DESIGN: KWL DRAWN: RLS REVIEW: [blank] UTILITY: [blank]	SHEET: 5 OF 33 DATE: Sept 24, 2008
DRAWING FILE: paving {PUEBLO-1} PROJECT NUMBER: 472-84648	[blank]