

# CITY OF WICHITA - PUBLIC WORKS ENGINEERING DIVISION

## SEDGWICK COUNTY ARAPAHO AND 8TH STREET SANITARY SEWER IMPROVEMENT

Project No.: 468-84239

OCA NO.: 744200

SEC. 15 TWP. 27 S R. 01 W.

DONDLINGER & SONS - CONTRACTOR  
M. SHOLANDER - CITY OF WICHITA, INSPECTOR  
AS-BUILT  
RELEASE DATE: 05/28/2009  
PDF: APR 07/20/2009

### INDEX OF SHEETS

SHEET NO.	TITLE
C-1	TITLE SHEET
C-2	SANITARY PLAN AND PROFILE
C-3	BACK OF CURB PROTECTION DETAILS
C-4	SILT FENCE DETAILS
C-5	STRAW BALE DETAILS
C-6	STANDARD MANHOLE DETAILS
C-7	STREET IMPROVEMENT DETAIL
C-8	SUBDIVISION DEVELOPMENT PROCESS

### GENERAL NOTES

UNLESS SHOWN OR STATED OTHERWISE ON THESE DRAWINGS, MATERIALS AND CONSTRUCTION SHALL BE IN ACCORDANCE WITH CITY OF WICHITA STANDARD SPECIFICATIONS.

CONTRACTOR WILL BE REQUIRED TO PROVIDE A MINIMUM ADVANCE NOTICE OF SEVENTY-TWO (72) HOURS TO UTILITY COMPANIES PRIOR TO STARTING ANY EXCAVATION AS FOLLOWS:

KANSAS ONE-CALL 1-800-344-7233  
OR 687-2470 (LOCAL WICHITA)

THE CONTRACTOR MUST NOTIFY THE FOLLOWING IN CASE OF AN EMERGENCY:

SEC (TELEPHONE) 900-870-8390  
COX COMMUNICATIONS (CABLE) 262-0661  
WESTAR (ELECTRIC) 383-8600  
KANSAS GAS SERVICE (GAS) 832-3101  
CITY OF WICHITA WATER & SEWER MAINT. 262-6000  
AQUILA 946-0096

- THE CONTRACTOR SHALL BE RESPONSIBLE FOR PRESERVING PROPERTY IRONS. THE CONTRACTOR WILL BE REQUIRED TO RE-ESTABLISH ANY PROPERTY IRONS WHICH ARE DAMAGED OR DESTROYED BY HIS CONSTRUCTION OPERATIONS. SUCH IRONS SHALL BE RE-ESTABLISHED BY A LICENSED LAND SURVEYOR IN ACCORDANCE WITH STATE LAWS.
- EXISTING UTILITIES AND THEIR LOCATIONS, AS SHOWN ON THE PLANS REPRESENT THE BEST INFORMATION OBTAINABLE FOR DESIGN. LOCATION INFORMATION HAS BEEN OBTAINED FROM THE VARIOUS UTILITY COMPANIES AND IS EITHER FROM COMPANY RECORD DRAWINGS OR COMPANY PROVIDED FIELD LOCATIONS. THE PLAN LOCATIONS SHOWN ARE NOT GUARANTEED. ADDITIONAL EXISTING UTILITIES MAY ALSO BE ENCOUNTERED.
- RUBBLE FROM THE REMOVAL OF MISCELLANEOUS STRUCTURES AND EXCESS EXCAVATION WHICH IS TO BE WASTED SHALL BE DISPOSED OF ON SITES TO BE PROVIDED BY THE CONTRACTOR. THESE SITES SHALL BE APPROVED BY THE ENGINEER AS TO SUITABILITY, APPEARANCE AND SITE LOCATION. LOCATIONS THAT, IN THE OPINION OF THE ENGINEER, WILL LEAVE AN UNSIGHTLY APPEARANCE WILL NOT BE APPROVED. ALL DISPOSAL SITES MUST BE APPROVED BY THE KANSAS DEPARTMENT OF HEALTH AND ENVIRONMENT. MATERIAL EITHER STOCKPILED OR DISPOSED OF IN A FLOOD PLAIN WOULD REQUIRE A KANSAS STATE BOARD OF AGRICULTURE PERMIT. ANY MATERIAL DUMPED IN WATERS OF THE UNITED STATES OR WETLANDS IS SUBJECT TO U.S. CORPS OR ENGINEERS PERMITTING REGULATIONS. ANY MATERIAL BURIED OR STOCKPILED BEYOND APPROVED CONSTRUCTION LIMITS WOULD REQUIRE ADDITIONAL ARCHAEOLOGICAL INVESTIGATIONS UNLESS BURIED IN A PREVIOUSLY APPROVED BORROW LOCATION.
- A SAW CUT OF AT LEAST ONE-HALF THE DEPTH OF THE EXISTING SURFACE COURSES OR ONE-FOURTH THE DEPTH OF THE EXISTING TOTAL PAVEMENT THICKNESS SHALL BE PROVIDED AT LOCATIONS WHERE PROPOSED CONSTRUCTION ABUTS AN EXISTING SURFACE OR PAVEMENT FOR WHICH PARTIAL REMOVAL OF THAT SURFACE OR PAVEMENT IS REQUIRED. SAW JOINT TO FACILITATE REMOVAL WITHIN THREE (3) FEET OF EXISTING JOINTS WILL NOT BE PERMITTED AND FOR SUCH INSTANCES THE LIMITS OF REMOVAL SHALL EXTEND THE EXISTING JOINT. SUCH SAW CUTS WILL NOT BE PAID FOR DIRECTLY AND THIS COST SHALL BE CONSIDERED AS SUBSIDIARY TO THE REMOVAL OF SURFACE OR PAVEMENT.
- CONTRACTOR SHALL SEED AND MULCH ALL DISTURBED AREAS. COST SHALL BE CONSIDERED SUBSIDIARY TO SITE RESTORATION.
- CONNECTION OF EXISTING STORM SEWERS, SANITARY SEWERS OR DRAINAGE STRUCTURES TO PROPOSED CONDUITS AND/OR STRUCTURES SHALL INCLUDE ALL MATERIAL, EQUIPMENT AND LABOR. THESE CONNECTIONS SHALL NOT BE PAID FOR DIRECTLY, BUT SHALL BE CONSIDERED SUBSIDIARY TO THE VARIOUS PROPOSED CONDUITS OR STRUCTURES. THIS WORK SHALL BE AS DIRECTED BY THE ENGINEER AND SHALL BE SUBSIDIARY TO THE SPECIFIC STRUCTURE BID ITEMS.
- ELEVATIONS ARE IN CITY OF WICHITA DATUM.
- SELECT SOIL (TOPSOIL) SHALL BE PLACED AT A MINIMUM DEPTH OF 6" OR AS SPECIFIED AT ALL LOCATIONS WITHIN THE RIGHT-OF-WAY OUTSIDE OF PAVEMENT. THE FINISHED GRADE INDICATES THE SURFACE ELEVATION AFTER THE PRESCRIBED SELECT SOIL (TOPSOIL) THICKNESS HAS BEEN PLACED.
- ALL GRAVEL OR OTHER SIMILAR DEBRIS LARGER THAN 1/2 INCH IN DIAMETER SHALL BE RAKED UP AND REMOVED DURING FINAL GRADE PREPARATION.
- REMOVAL AND REPLACEMENT OF SIDEWALKS AND APPURTENANT RAMPS AS REQUIRED TO COMPLETE THE WORK DESCRIBED SHALL INCLUDE ALL MATERIAL, EQUIPMENT, AND LABOR. SIDEWALK AND RAMP REMOVAL/REPLACEMENT SHALL NOT BE PAID DIRECTLY, BUT SHALL BE CONSIDERED SUBSIDIARY TO THE VARIOUS COMPONENTS OF THE WORK.
- ANY TREES IN CONFLICT WITH SANITARY SEWER EXTENSION SHALL BE PRESERVED AND PROTECTED IF POSSIBLE. ANY TREES THAT MUST BE REMOVED SHALL BE SUBSIDIARY TO SITE CLEARING & RESTORATION.
- THE EXISTING FENCE SHALL BE REMOVED AND REPLACED AS NECESSARY. FENCE REMOVAL AND REPLACEMENT SHALL BE SUBSIDIARY TO SITE CLEARING & RESTORATION.

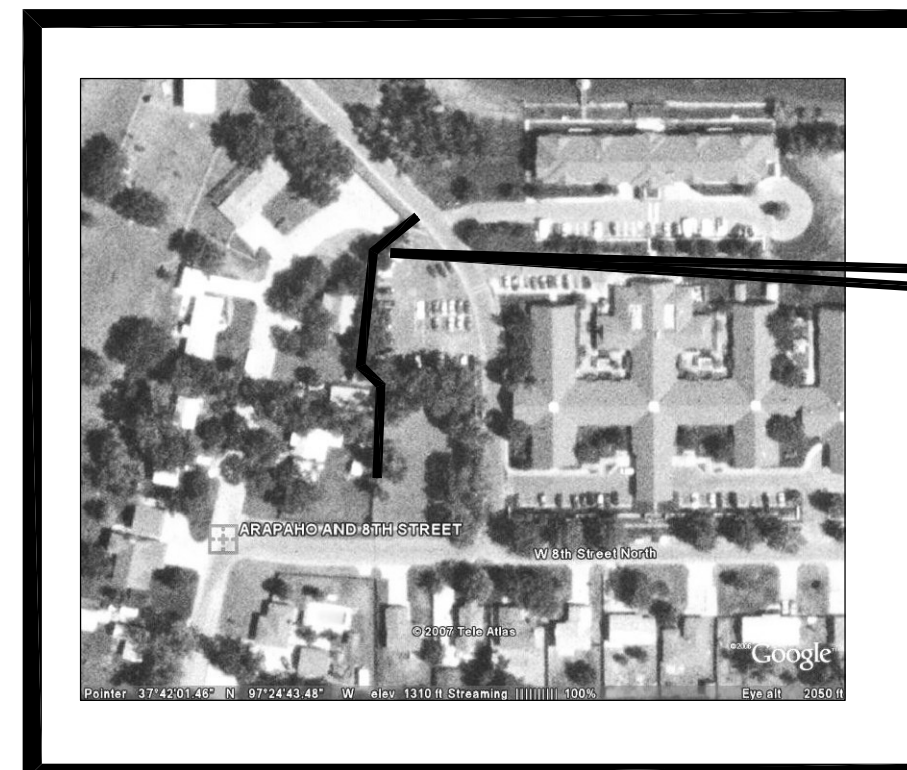

ALIGNMENT  
LOCATION



LOCATION MAP  
NOT TO SCALE

PROJECT  
LOCATION

SUMMARY OF QUANTITIES			
No.	ITEM OF WORK	QUANTITY	UNIT
1	SANITARY SEWER, 8" PVC/SDR26	270	L.F.
2	MANHOLES: 4 FT. DIA.	4	E.A.
3	CLEANOUT: 8" DOUBLE Y	1	E.A.
4	C-1 CURB REMOVE & REPLACE	8	L.F.
5	ASPHALT STREET REMOVE & REPLACE	21	L.F.
6	FLOWABLE FILL	23	L.F.
7	SITE CLEARING & RESTORATION	1	LS
8			
9			
10			
11			
12			
13			
14			
15			
16			
17			
18			

LEGEND			
⊙	CONTROL POINT	⊚	TELEPHONE
△	BENCH MARK	⊞	TELEPHONE RISER
▲	PROPERTY CORNER	⊙	STREET SIGN
⊙	SOIL BORING	⊞	MAILBOX
⊙	POWER POLE	⊙	GAS YARD LIGHT
⊙	LIGHT POLE	—OHP—	OVERHEAD POWER
⊙	TRAFFIC SIGNAL	—UGP—	UNDERGROUND POWER
⊙	GUY WIRE	—OHT—	OVERHEAD TELEPHONE
⊙	MANHOLE	—UGT—	UNDERGROUND TELEPHONE
⊙	LAMP HOLE	—CATV—	OVERHEAD CABLE TV
⊙	GRATE INLET (SIZE VARIES)	—UGTV—	UNDERGROUND CABLE TV
⊙	CURB INLET (SIZE VARIES)	—8" S—	SANITARY SEWER LINE
⊙	FIELD INLET (SIZE VARIES)	—15" SS—	STORM SEWER LINE
⊙	POWER MANHOLE	—12" ST—	STEAM LINE
⊙	TRAFFIC CONTROL BOX	—2" G—	GAS LINE
⊙	ELECTRIC METER	—2" W—	WATER LINE
⊙	WATER METER PIT	—E—	PROPERTY LINE
⊙	WATER METER	—X—	CHAIN LINK FENCE
⊙	WATER VALVE	—□—	WROUGHT IRON FENCE
⊙	FIRE HYDRANT	—B—	WOVEN WIRE FENCE
⊙	GAS METER	—	LINE CONTINUES (BREAK)
⊙	GAS VALVE	⊙	TREE TO BE REMOVED
⊙	GAS TEST		
⊙	GAS REGULATOR		

PROJECT CONTACT PERSON  
MICHAEL RUSSELL, PROJ. ENG.  
WILLIE BLOCKER, TECHNICIAN  
DUBOIS CONSULTANTS INC.  
TEL: (316)660-6737

CITY OF WICHITA CONTACT  
PERSON  
SHAWN MELLIES, I.E.  
PUBLIC WORKS DEPARTMENT  
TEL(316)268-4545

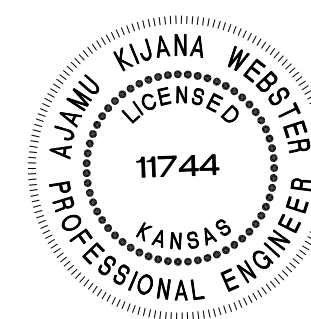

PREPARED BY:

**DuBOIS CONSULTANTS**  
CIVIL & STRUCTURAL ENGINEERING  
www.dubois.com

(HOME OFFICE)  
5737 Swope Parkway  
Kansas City, Missouri 64130  
Phone: (816) 333-7700  
FAX: (816) 333-7722

(KANSAS OFFICE)  
354 N. Riverview St. Suite 520  
Wichita, KS 67203  
Phone: (316) 660-8735  
FAX: (316) 660-6725