

NOTE: Contractor shall Construct 2x4 Grated Inlet with Inlet Box Sized as required to accomodate 24\"/>

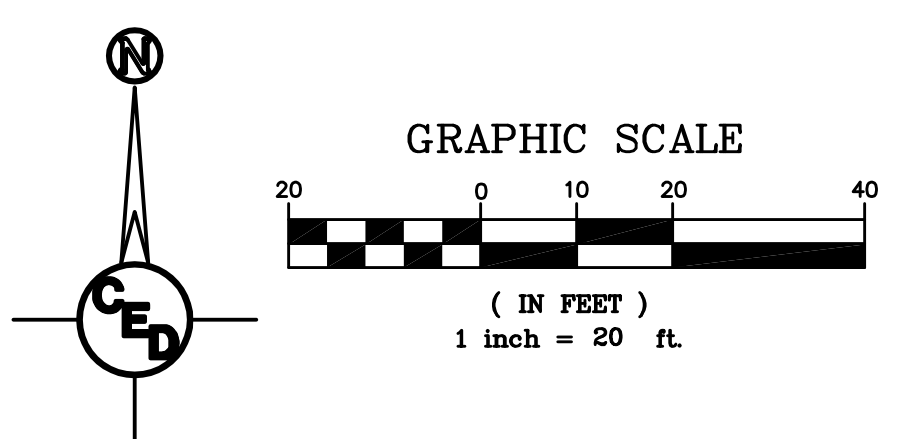

SWS LINE 1

Revised 9-10-09

NOTE
SEE SHEET 2 FOR LEGEND

SURVEY DISCLAIMER
TOPOGRAPHIC SURVEY AND CONTOUR MAP USED IN PREPARING PLANS WAS PROVIDED BY SAVOY COMPANY, P.A., 535 S. EMPORIA, SUITE 104, WICHITA, KS. ENGINEER DOES NOT GUARANTEE SURVEY ELEVATIONS FOR ACCURACY. CONTRACTOR SHALL VERIFY ELEVATIONS AND NOTIFY ENGINEER OF ANY DISCREPANCIES.

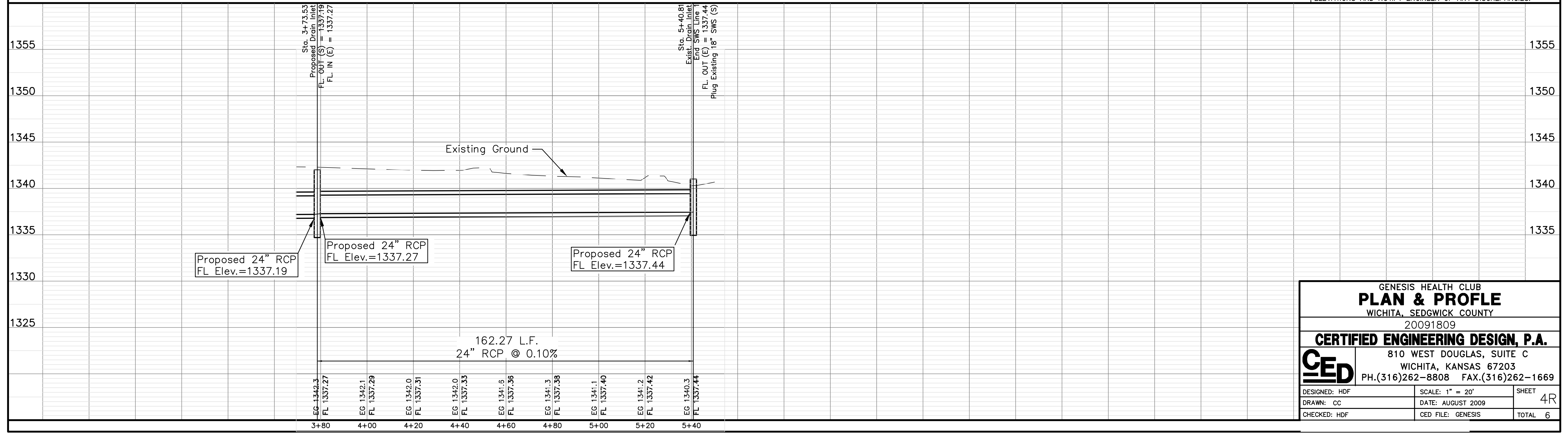

GENESIS HEALTH CLUB
PLAN & PROFILE
 WICHITA, SEDGWICK COUNTY
 20091809
CERTIFIED ENGINEERING DESIGN, P.A.
 810 WEST DOUGLAS, SUITE C
 WICHITA, KANSAS 67203
 PH.(316)262-8808 FAX.(316)262-1669

DESIGNED: HDF	SCALE: 1" = 20'	SHEET
DRAWN: CC	DATE: AUGUST 2009	4R
CHECKED: HDF	CD FILE: GENESIS	TOTAL 6