

BENCHMARK:
 BM #17 - City of Wichita Disc on the North Hubguard of the
 RCB in the Northwest Corner of the Intersection of
 Meridian and 31st Street North
 Sta. 206+50, 40' Lt.
 Elev. = 1284.28 MSL

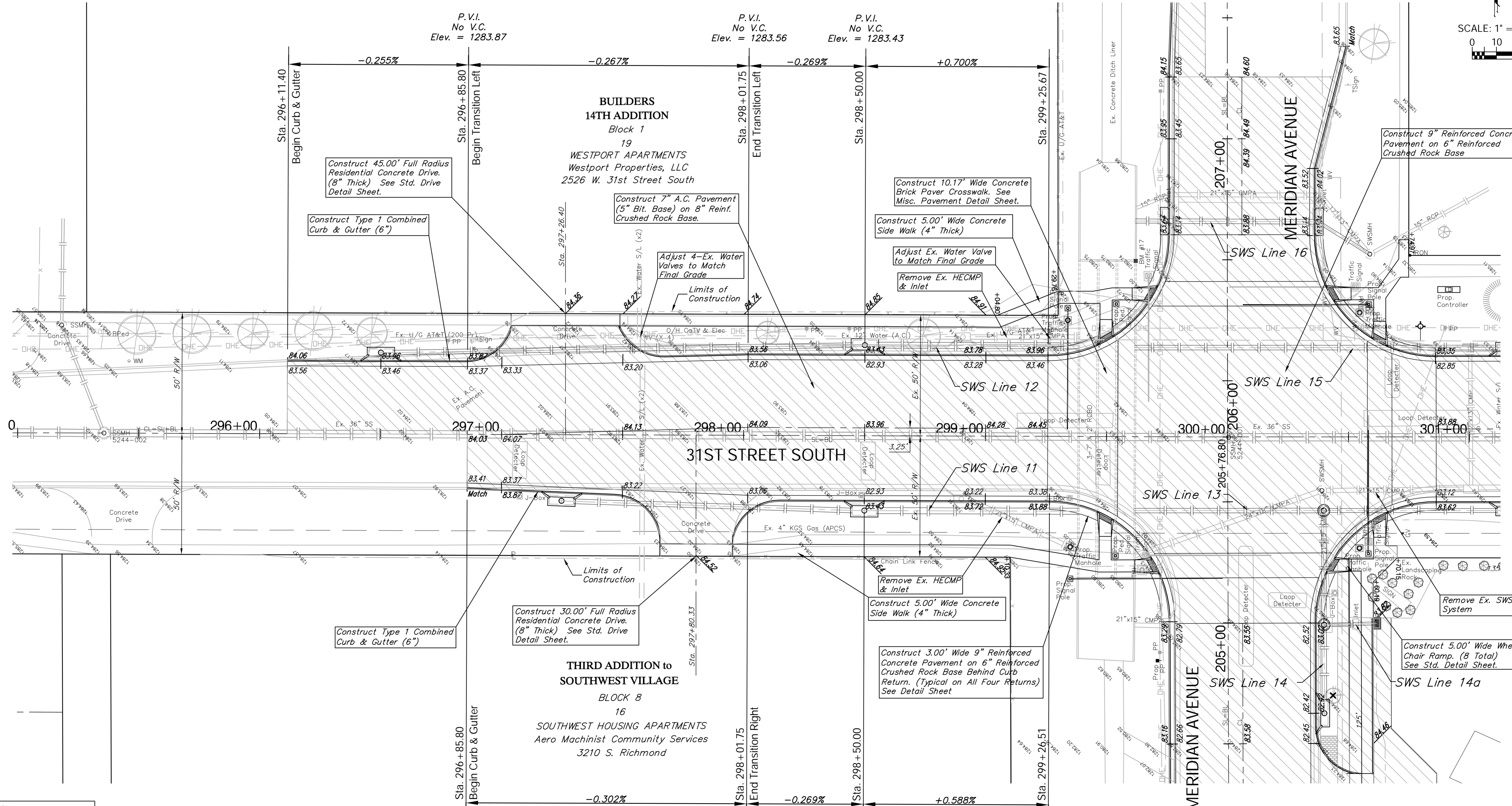
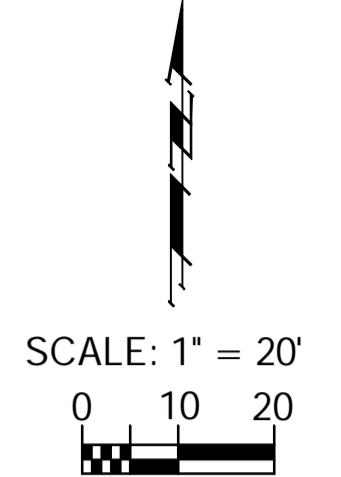

Note:
 Pavement, Sidewalks, and
 Etc. To Be Removed Are
 Indicated By:

P.V.I.
 No V.C.
 Elev. = 1283.56

P.V.I.
 No V.C.
 Elev. = 1283.43

Drawing File: E:\eng\Meridian_47th to 31st\Land\dwg\Base.dwg (Pav20)
 Project No. 0510E396 CAPITAL IMPROVEMENT PROJECT
 31ST STREET SOUTH PAVNG
 Sta. 295+50.00 to Sta. 301+00.00
 MERIDIAN AVENUE - 47TH STREET SOUTH to 31ST STREET SOUTH

B Baughman Company, P.A.
 315 Ellis St., Wichita, KS 67211 P 316-262-0149 F 316-262-0149
 ENDSERVING | SURVEYING | PLANNING | LANDSCAPE ARCHITECTURE

September 2009
 SHEET
 37
 OF
 187