

BENCHMARK:  
 BM #4 - "C" Chiseled in the Back of Curb in the South  
 Curb Line of 44th Street South  
 Sta. 118+12, 80' Lt.  
 Elev. = 1280.96 MSL

The Existing 6" Kansas Gas Line Running  
 Parallel to the Proposed SWS System is to  
 Remain in Place During Construction. The  
 Contractor Shall Contact Jim Coe with KGS at  
 832-3126 to Coordinate Bracing, Support, etc.

SCALE:  
 HORIZONTAL: 1" = 20'  
 VERTICAL: 1" = 5'

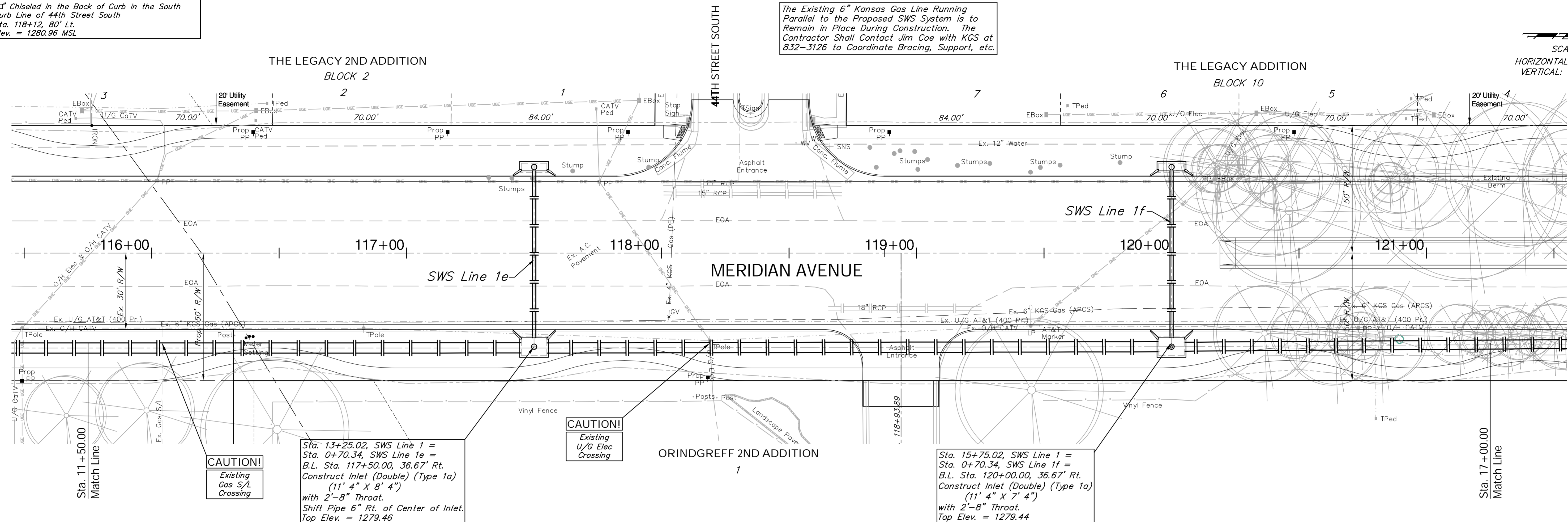

Sta. 13+25.02, SWS Line 1 =  
 Sta. 0+70.34, SWS Line 1e =  
 B.L. Sta. 117+50.00, 36.67' Rt.  
 Construct Inlet (Double) (Type 1a)  
 (11' 4" X 8' 4")  
 with 2'-8" Throat.  
 Shift Pipe 6" Rt. of Center of Inlet.  
 Top Elev. = 1279.46

Sta. 15+75.02, SWS Line 1 =  
 Sta. 0+70.34, SWS Line 1f =  
 B.L. Sta. 120+00.00, 36.67' Rt.  
 Construct Inlet (Double) (Type 1a)  
 (11' 4" X 7' 4")  
 with 2'-8" Throat.  
 Top Elev. = 1279.44

