

BENCHMARK:
 BM #11 - "C" Chiseled in the Top of the Curb on the South Side of Median at Church Entrance
 Sta. 166+69, 56' Lt.
 Elev. = 1285.34 MSL

SCALE:
 HORIZONTAL: 1" = 20'
 VERTICAL: 1" = 5'

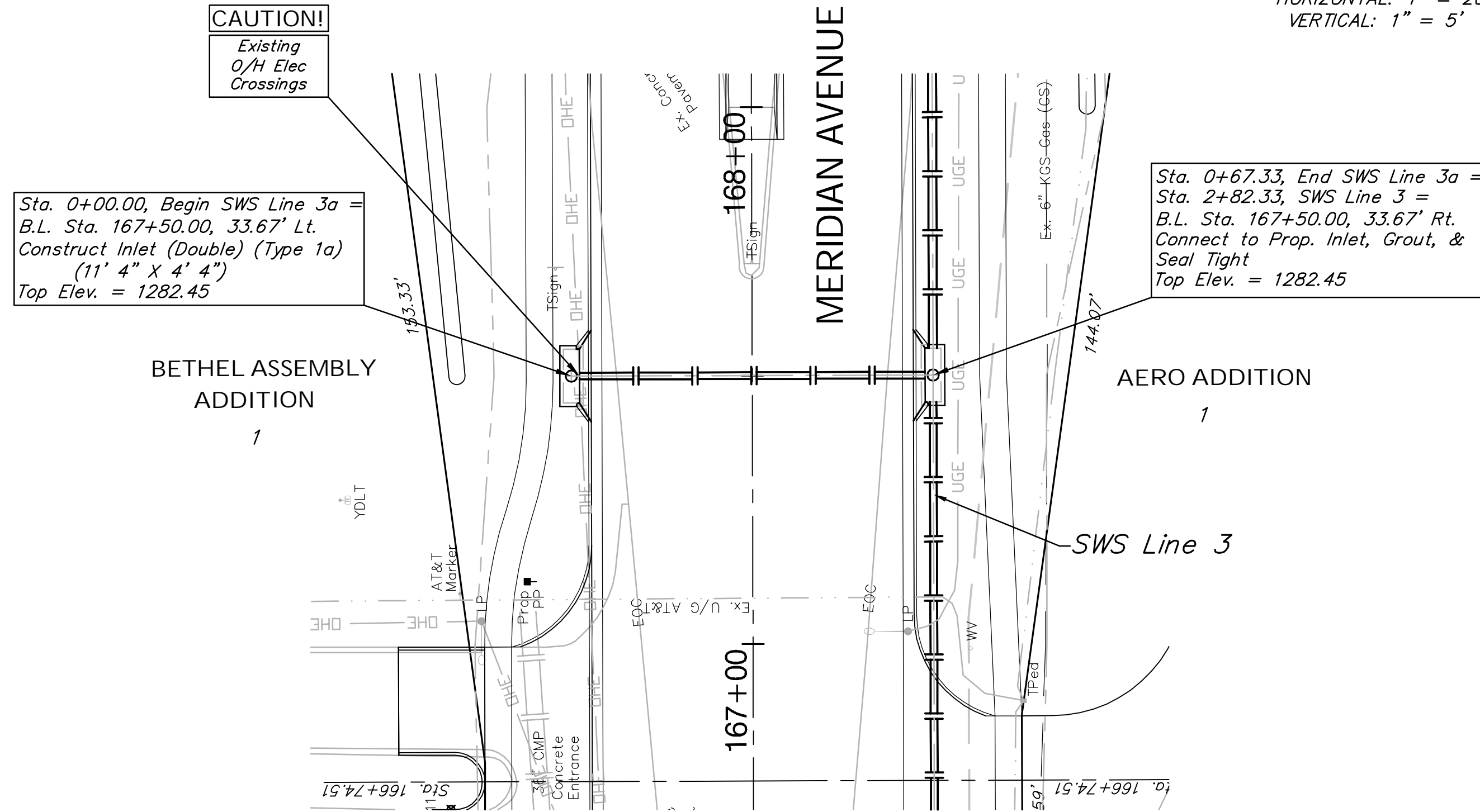

BENCHMARK:
 BM #12 - "C" Chiseled in the Top of the Median Curb South of the Interstate 235 Overpass
 Sta. 173+26, 7' Rt.
 Elev. = 1285.07 MSL

SCALE:
 HORIZONTAL: 1" = 20'
 VERTICAL: 1" = 5'

