

MERIDIAN AVENUE - 47TH STREET SOUTH to 31ST STREET SOUTH

I-235 EXIT RAMP CLOSURE DETOUR PLAN

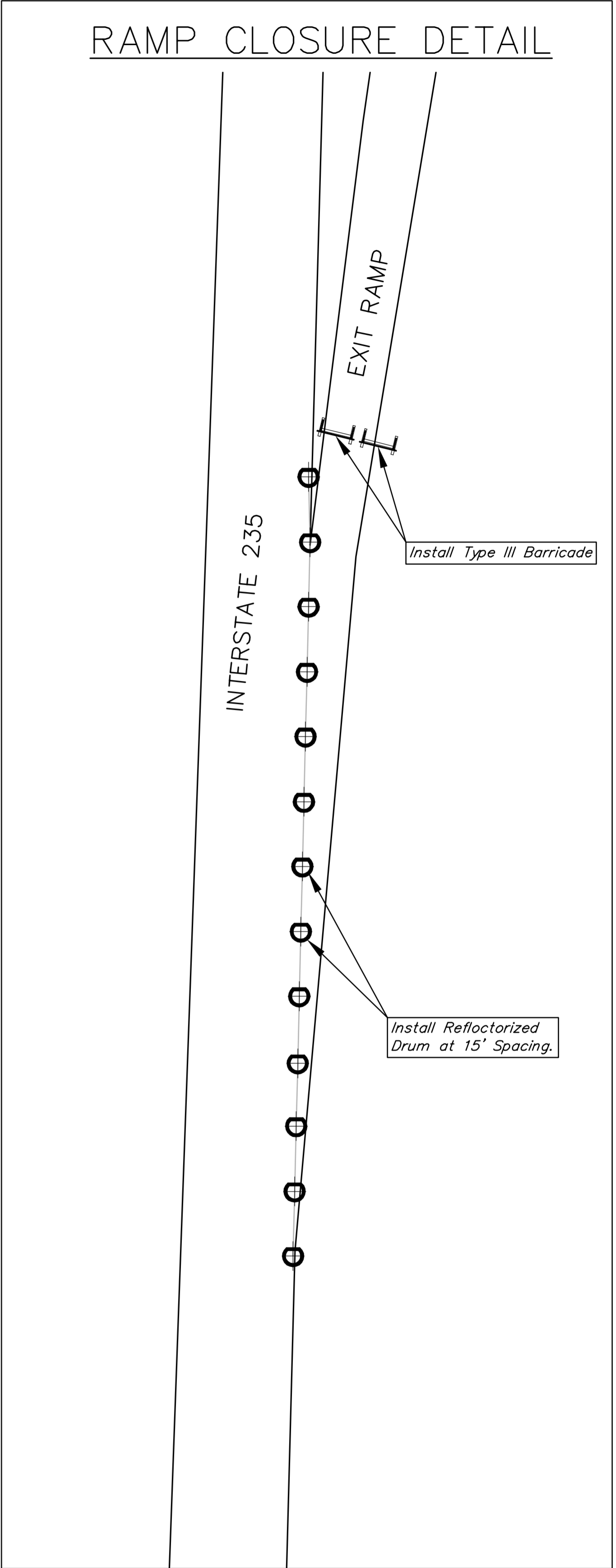
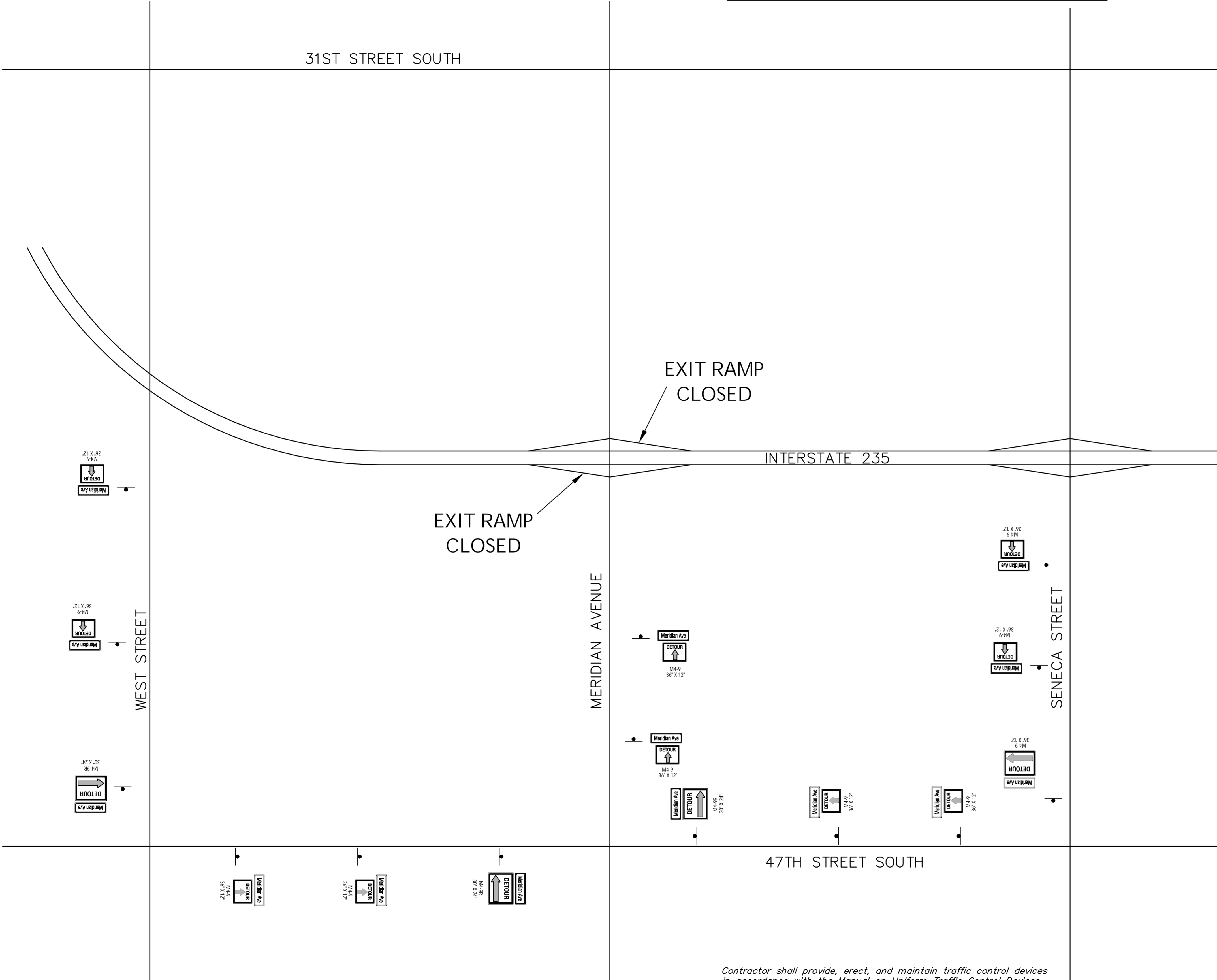

Contractor shall provide, erect, and maintain traffic control devices in accordance with the Manual on Uniform Traffic Control Devices (M.U.T.C.D.) as shown on the Traffic Control plans and subject to the Engineer's approval.

Drawing File: E:\eng\Meridian47th to 31st\Traffic\ConSeq Base.dwg (Exit Detour)

Design: TPV
 Drawn: TPV
 Approved: TPV
 Scale: None

Project No. 0510E396 CAPITAL IMPROVEMENT PROJECT
 DETOUR PLANS for MERIDIAN AVENUE
 EXIT RAMP CLOSURES
 MERIDIAN AVENUE - 47TH STREET SOUTH to 31ST STREET SOUTH

Baughman Company, P.A.
 315 Ellis St., Wichita, KS 67211 P 316-262-7171 F 316-262-0149
 Baughman ENGINEERING | SURVEYING | PLANNING | LANDSCAPE ARCHITECTURE

September 2009
 SHEET
 123
 OF
 187