

BENCHMARK:
 BM #11 - "C" Chiseled in the Top of the Curb on the South
 Side of Median at Church Entrance
 Sta. 166+69, 56' Lt.
 Elev. = 1285.34 MSL

SCALE: 1" = 20'
 0 10 20

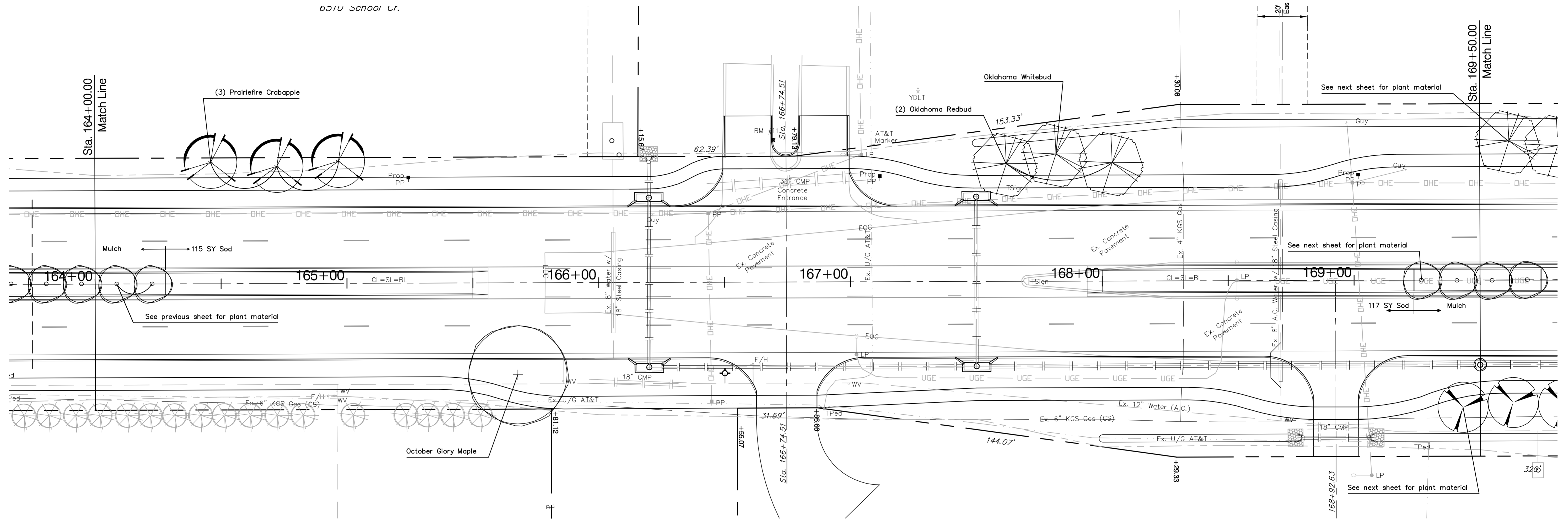

Plant List - This Sheet					
Quantity	SCIENTIFIC	COMMON	SIZE	METHOD	NOTE
1	Acer rubrum 'October Glory'	October Glory	2" Cal	B&B	Full & Healthy
3	Malus 'Prairiefire'	Prairiefire Crabapple	2" Cal	B&B	Full & Healthy
2	Cercis canadensis ssp. texensis 'Oklahoma'	Oklahoma Redbud	2" Cal	B&B	Full & Healthy
1	Cercis canadensis ssp. texensis 'Oklahoma Whitebud'	Oklahoma Whitebud	2" Cal	B&B	Full & Healthy

Median Turf - This Sheet					
Quantity	SCIENTIFIC	COMMON	SIZE	METHOD	NOTE
232		Buffalo 'Prestige'		Sod	Full & Healthy

Drawing File: E:\eng\Meridian_47th to 31st\Landscape.dwg

Design: BKB
 Drawn: BKB
 Approved: PJM
 Scale: 1"=20'

Project No. 0510E396 CAPITAL IMPROVEMENT PROJECT
 MERIDIAN AVENUE LANDSCAPE
 Sta. 164+00.00 to Sta. 169+50.00
 MERIDIAN AVENUE - 47TH STREET SOUTH to 31ST STREET SOUTH

Baughman Company, P.A.
 315 Ellis St. Wichita, KS 67211 P 316-262-7271 F 316-262-0149
 ENGINEERING | SURVEYING | PLANNING | LANDSCAPE ARCHITECTURE

September 2009
 SHEET
 OF 150
 187