

FHWA REGION NO.	STATE	PROJECT NO.	FISCAL YEAR	SHEET NO.	TOTAL SHEETS
7	KANSAS	87N-0503-01	2009	4	101

FEDERAL Project No. ARRA-N050(301)

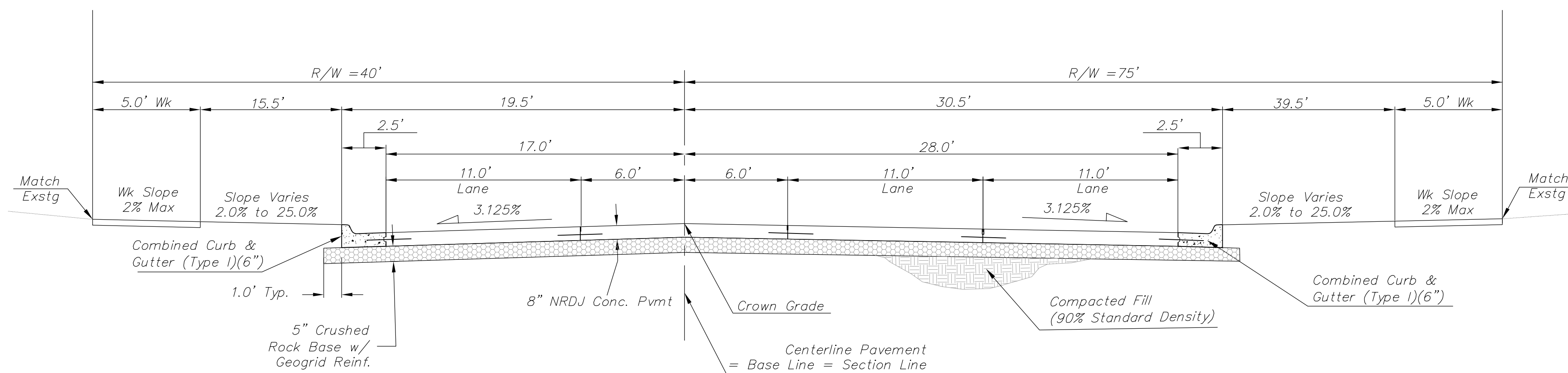

TYPICAL SECTION HYDRAULIC STREET

Sta. 8+00.00 to Sta 9+00.00

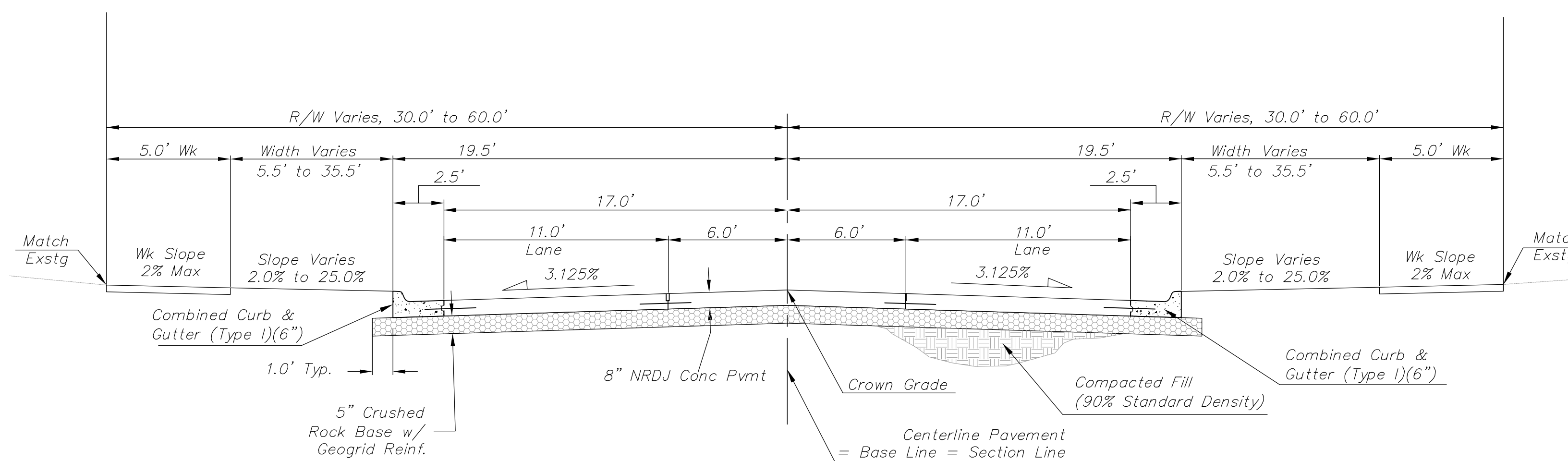

TYPICAL SECTION HYDRAULIC STREET

Sta. 11+00.00 to Sta 35+60.00
Sta. 37+55.00 to Sta 58+81.56

General Notes

FABRIC BASE REINFORCEMENT SHALL BE B X 1100 BY TENSAR CORPORATION OR LBO201 BY TENAX CORPORATION OR APPROVED EQUAL. FABRIC BASE REINFORCEMENT SHALL BE INSTALLED IN ACCORDANCE WITH MANUFACTURER'S RECOMMENDATIONS.

ROCK BASE IS TO BE COMPACTED AND SMOOTHED WITH A STEEL FACED ROLLER PRIOR TO PLACEMENT OF CONCRETE.

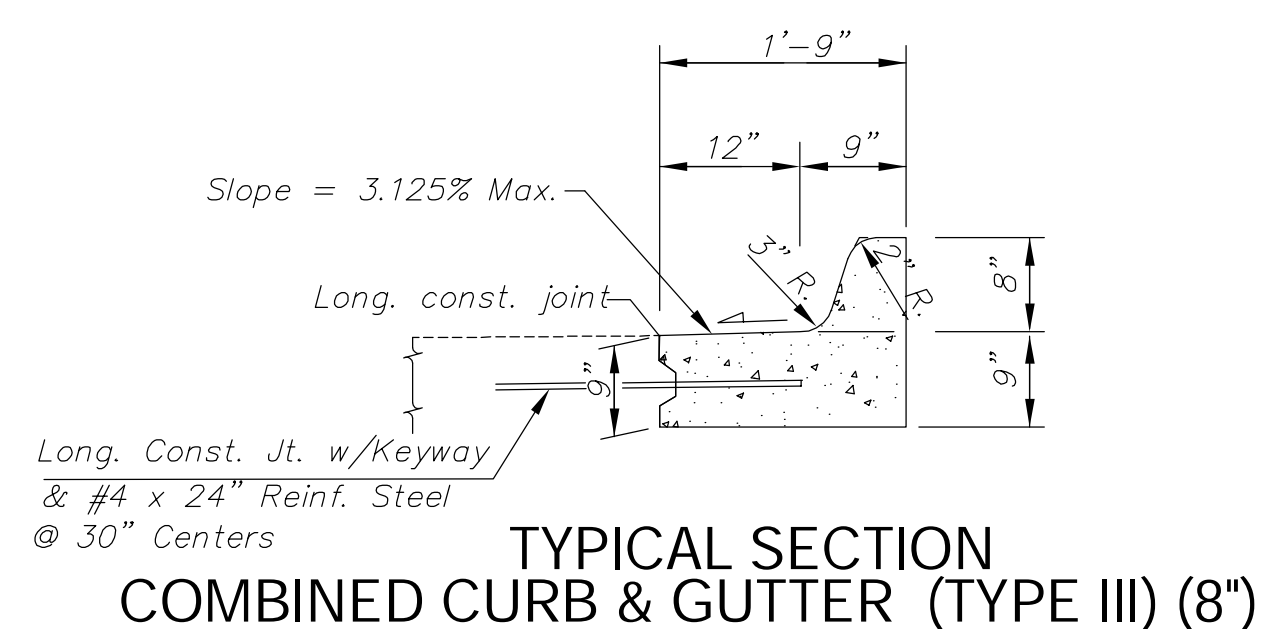

TYPICAL SECTION COMBINED CURB & GUTTER (TYPE III) (8")

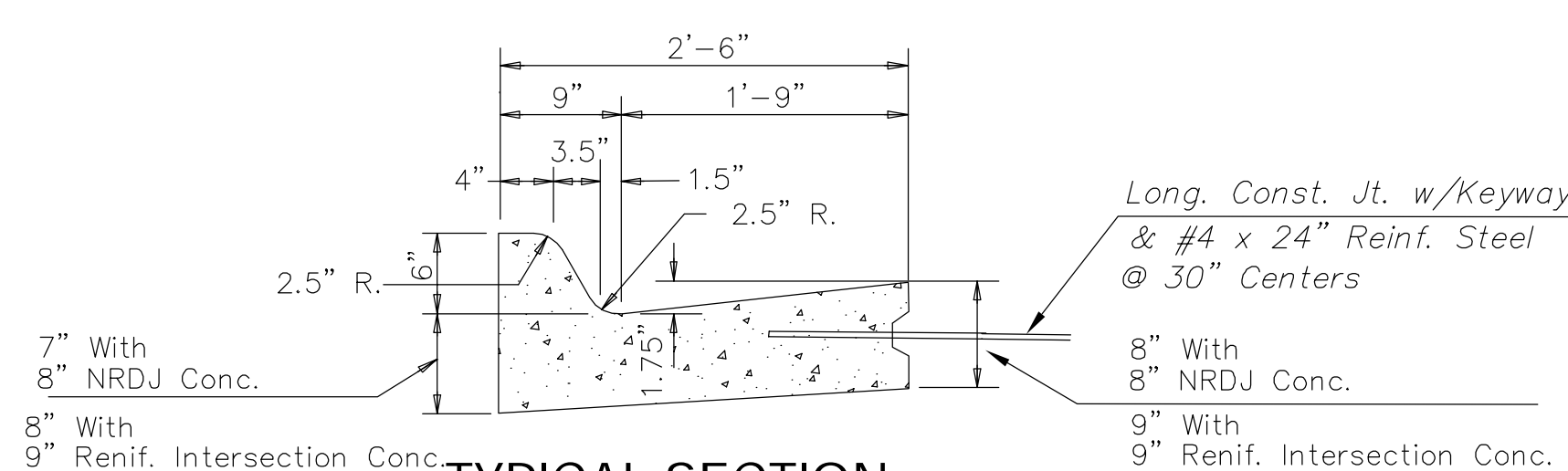

TYPICAL SECTION COMBINED CURB & GUTTER (TYPE I) (6")

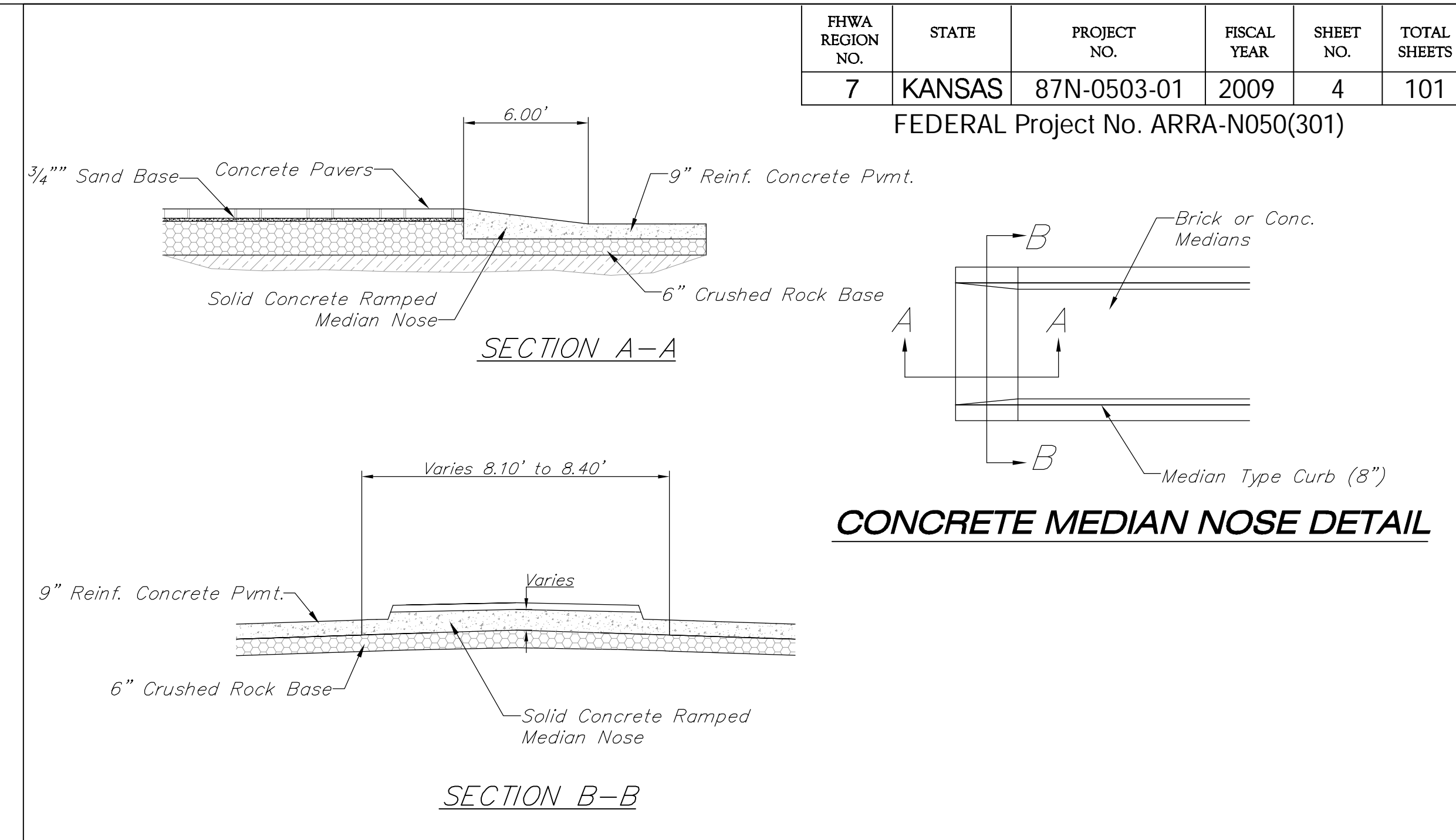

CONCRETE MEDIAN NOSE DETAIL

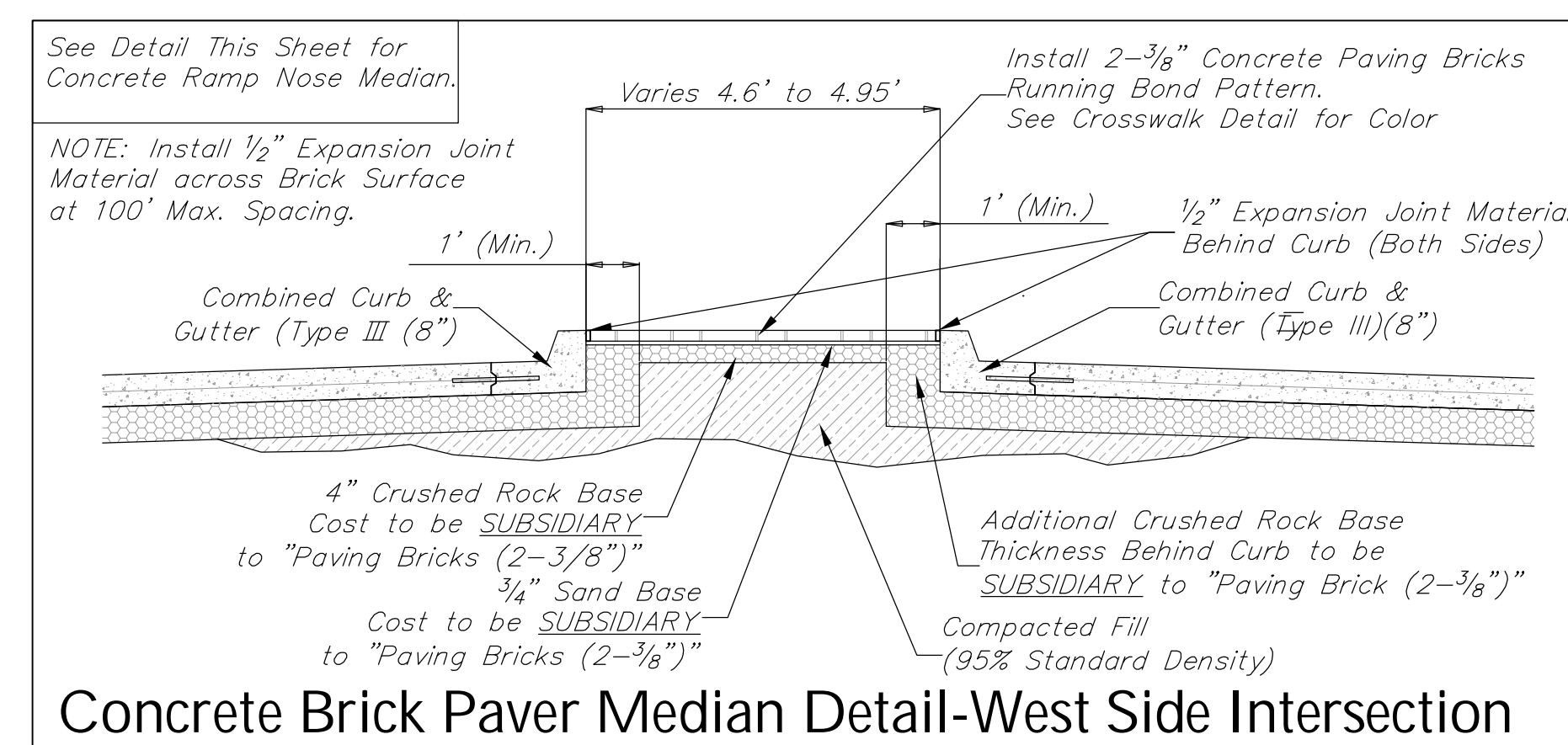

Concrete Brick Paver Median Detail-West Side Intersection

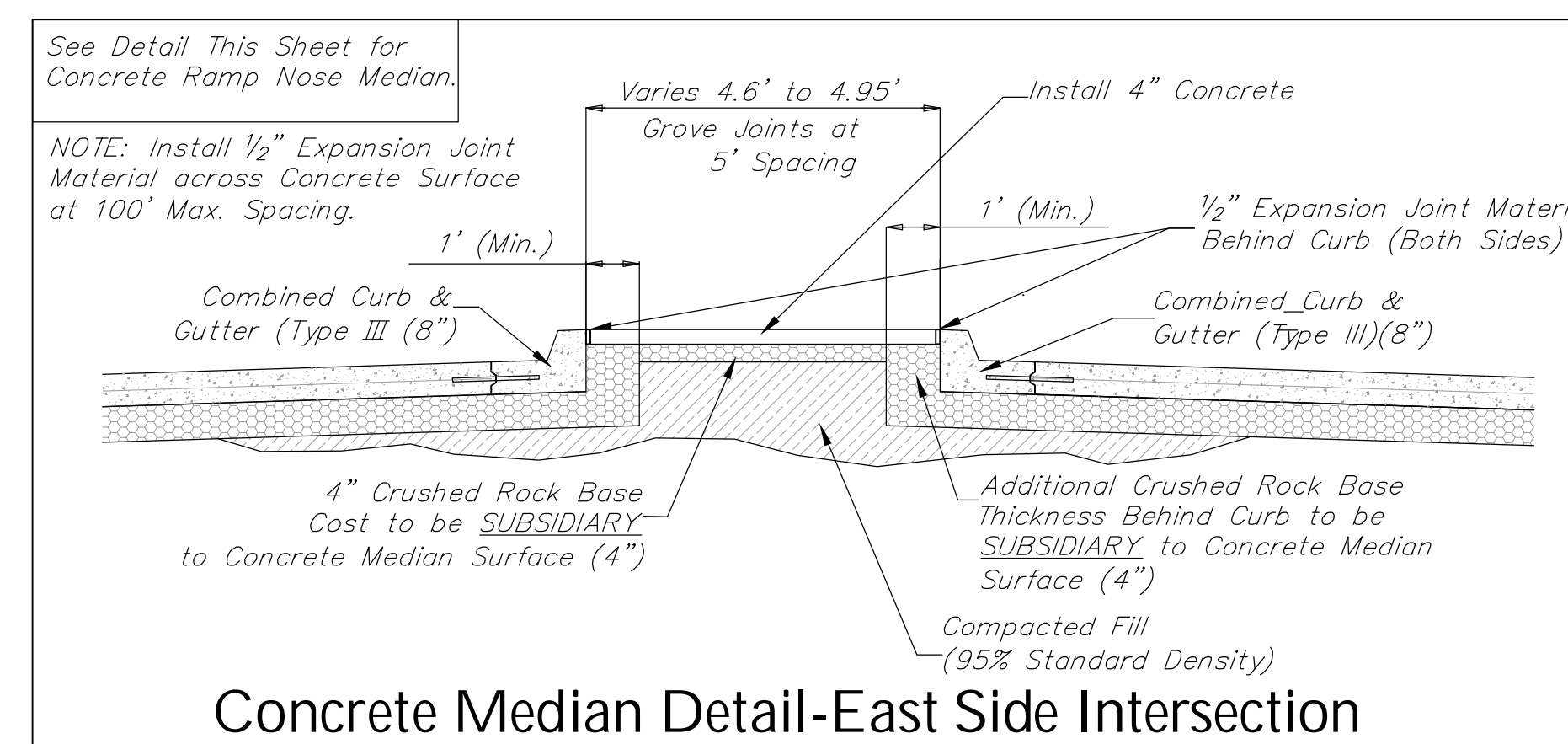

Concrete Median Detail-East Side Intersection