

FHWA REGION NO.	STATE	PROJECT NO.	FISCAL YEAR	SHEET NO.	TOTAL SHEETS
7	KANSAS	87N-0503-01	2009	23	101

FEDERAL Project No. ARRA-N050(301)

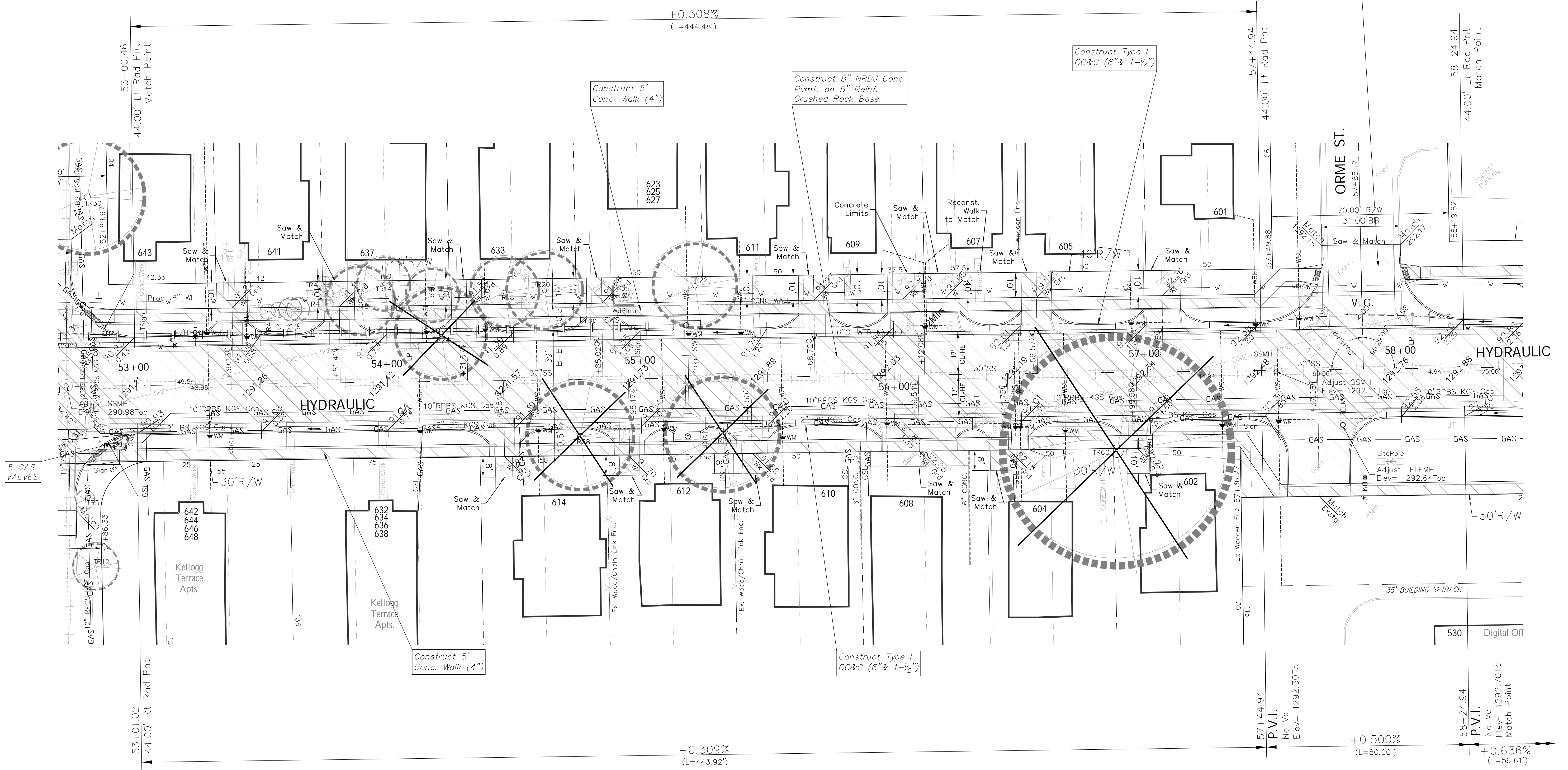
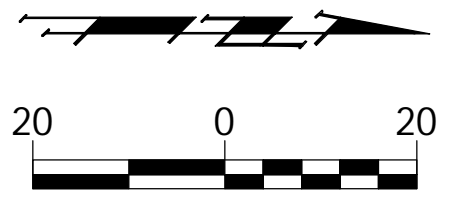

Construct 8" Reinf. Conc. V.G.
Pvmt. on 5" Reinf. Crushed Rock
Base W/Mono Edge Curb (6").

Construct 5'
Conc. Walk (4")

Construct 8" NRDJ Conc.
Pvmt. on 5" Reinf.
Crushed Rock Base.

Construct Type I
CC&G (6" & 1-1/2")

Construct 5'
Conc. Walk (4")

Construct Type I
CC&G (6" & 1-1/2")

Note:
Trees/Shrubs to be
removed are marked thus:

Note:
Pavement, Sidewalks, and
Etc. To Be Removed Are
Indicated By:

Drawing File: E:\eng\Hydraulic_Kellogg to Harry Pav\Land\dwg\ACADBase.dwg
Project No. 0710 E 968 CAPITAL IMPROVEMENT PROJECT
Design: KK
Drawn: Staff
Approved: JFB
Scale: NOTED

HYDRAULIC AVENUE from
HARRY to KELLOGG
STA 53+00 to STA 57+50

Baughman **Baughman Company, P.A.**
315 Ellis St. Wichita, KS 67211 P 316-262-7271 F 316-262-0149
ENGINEERING | SURVEYING | PLANNING | LANDSCAPE ARCHITECTURE

September 2009
SHEET
OF
23
101