

FHWA REG. NO.	STATE	PROJECT NO.:	YEAR	SHEET NUMBER	TOTAL SHEETS
7	KANSAS	87 N-0502-01	2009	102	226
A.R.R.A-N050(201)					

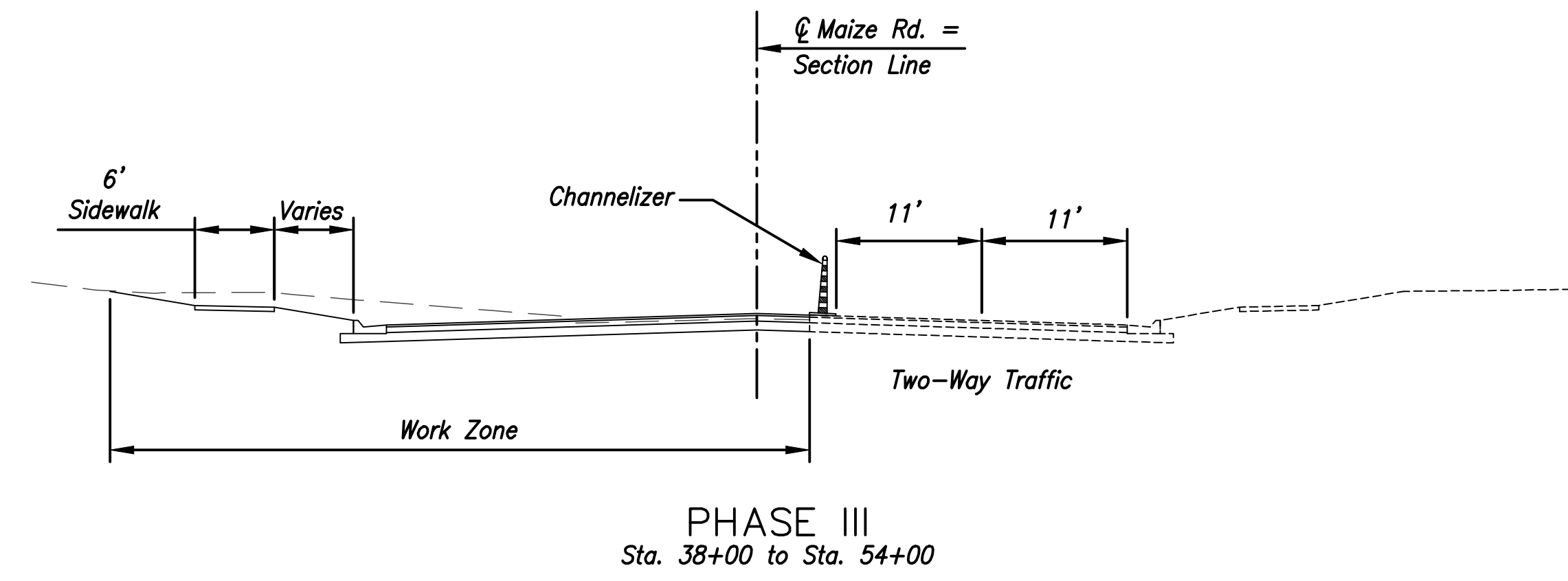
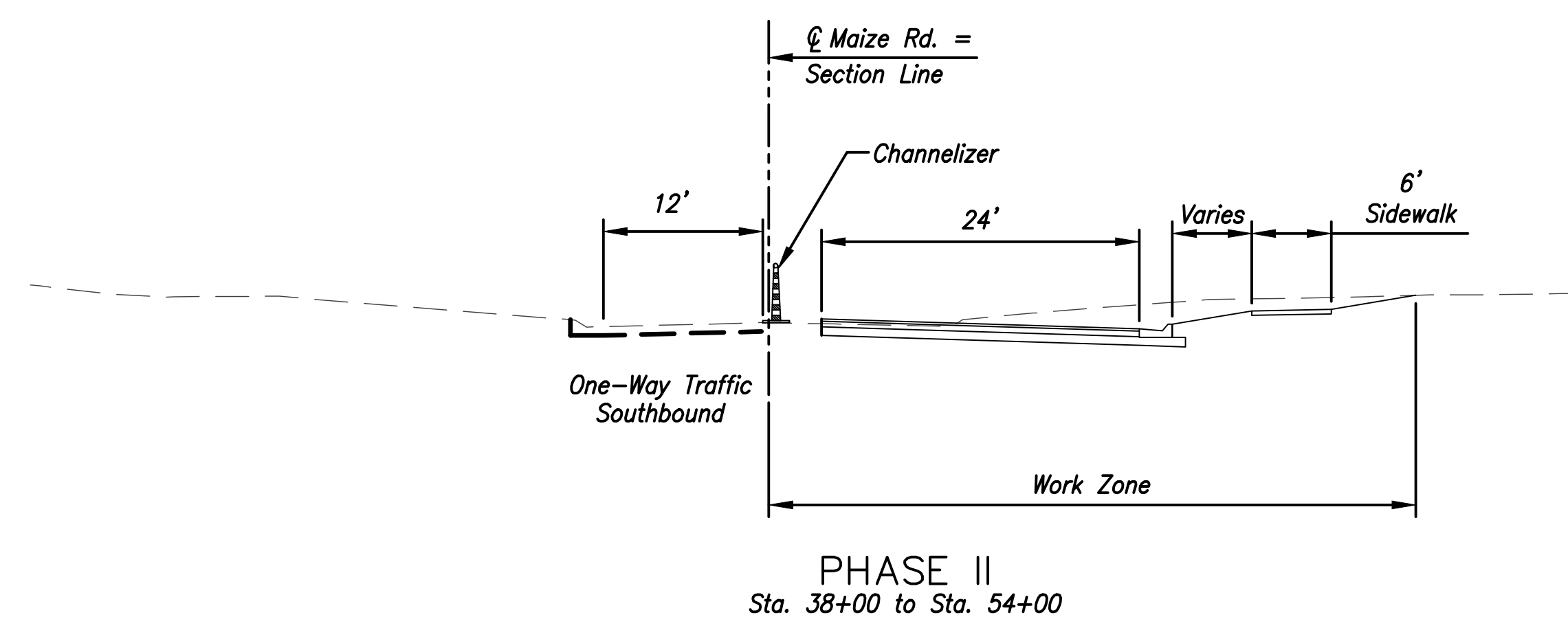
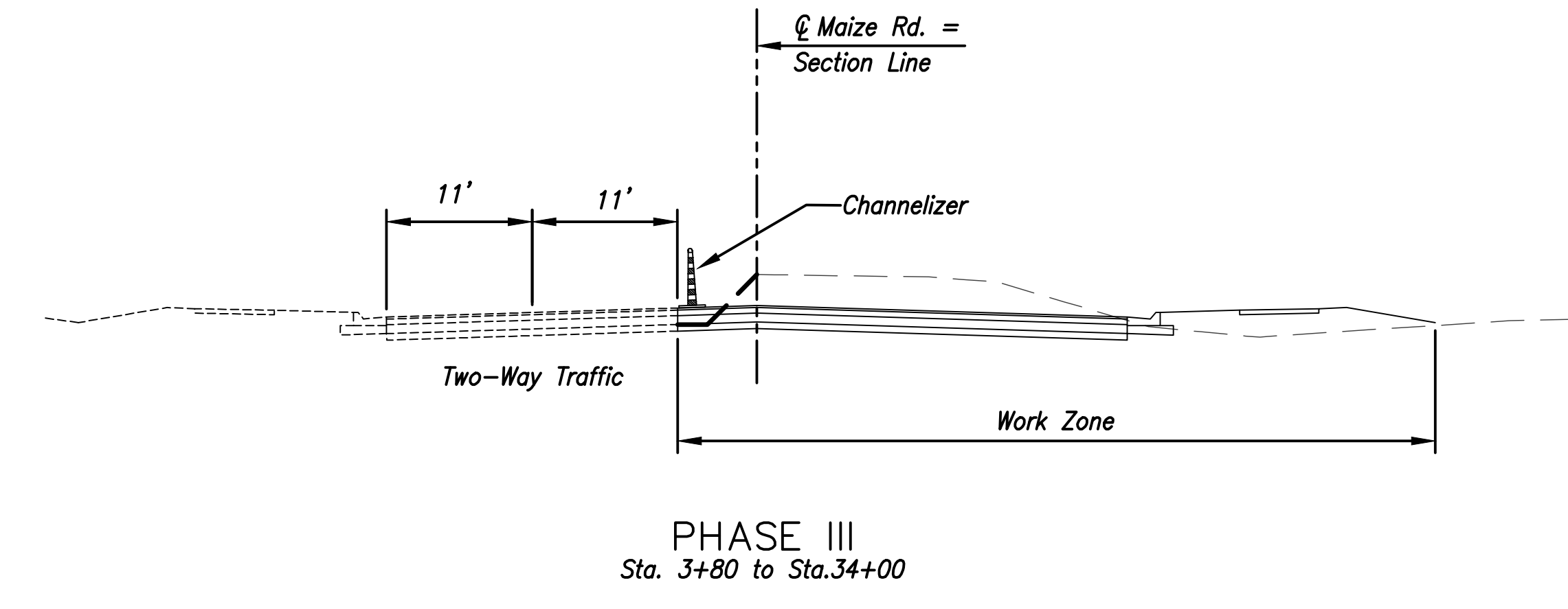
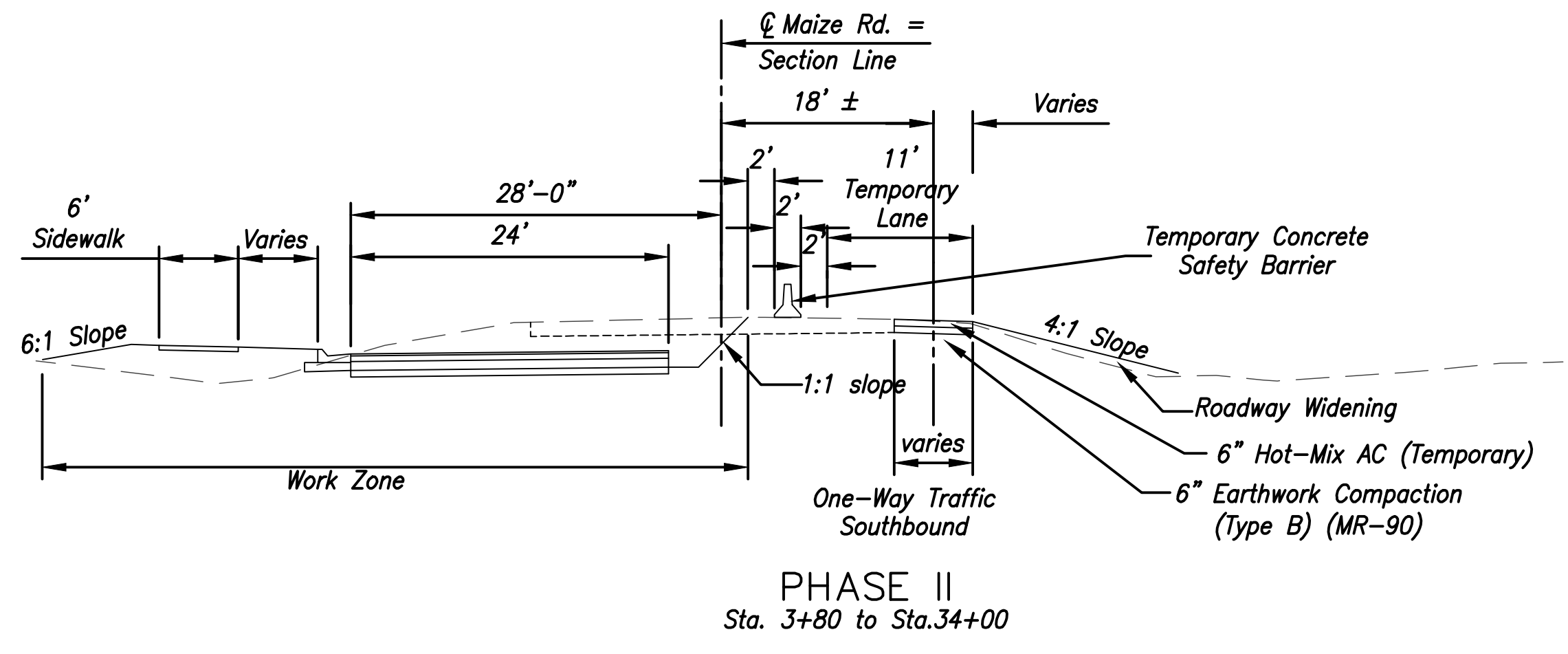

PROJECT PHASING

PHASE I

1. Construct crossroad RCB extensions. Close Maize Road to thru traffic from south of May Street to north of Rita Street. Maize Road closure shall be limited to 7 days.
2. Construct water main adjustments.
3. Construct storm sewers. Close northbound traffic from north of Pawnee Street to the Kellogg Frontage Road. Construct crossroad pipes routing southbound traffic around half of street under construction. Patch all pavement cuts with 6" Hot-Mix AC (Temporary).

PHASE II

1. Construct temporary road widening and surfacing along east side of Maize Road from south of Pawnee Street to south of May Street.
2. Set temporary concrete safety barrier. Close Stafford, Haskell, and Rita Streets, and 2 church entrances on west side of Maize Road.
3. Construct west half of Maize Road from south of Pawnee Street to May Street, and east half of Maize Road from May Street to Kellogg. Construct west half of Maize and Pawnee intersection, maintaining traffic.
4. Construct May Dora, Esthner, and Carr Street intersections, maintaining traffic.

PHASE III

1. Open Maize Road to 2-way traffic on new pavement. Open Stafford, Haskell, and Rita Streets, and 2 church entrances on west side of Maize Road.
2. Construct east half of Maize Road from south of Pawnee Street to May Street, and west half of Maize Road from May Street to Kellogg. Construct east half of Denene, Pawnee, Stafford, Haskell, Lotus, and Rita Street intersections, maintaining traffic.
3. Construct final surface course. Route traffic around surfacing operations.

CONSTRUCTION SEQUENCING - GENERAL INFORMATION

1. Set message boards on Maize Road north of Carr Street and south of Pawnee. Activate Maize Road Closing message 2 weeks prior to 7 day closing of Maize Road.
2. Sign detour route and advance construction signs.
3. The intention of these drawings for construction traffic control is to provide the contractor a scheme for organizing the work while maintaining through traffic and access to property along the project. The objective of the scheme is the safe, expeditious movement of traffic and safety of the work force. This scheme is not intended to be complete and will require additional detail to be provided by the contractor which may include, but not limited to, additional signing, barricades, markings, temporary surfacing, and detours. All traffic controls for street construction, maintenance, utility, and emergency operations shall conform to the manual on uniform traffic control devices.
 - 3.1. The sequence shown is intended as a guide for major items only. The contractor will be responsible for the coordination of all major items. Variations to the sequence shown may be used as approved by the engineer. Regardless of sequence used, construction traffic shall be essentially in accordance with that shown. Part of the work shown for a specific phase may be accomplished in other phases. Major work not constructed within the indicated phase shall be approved by the engineer.
4. All signs and pavement markings conflicting with this traffic control shall be covered or removed as directed by the engineer.
5. During Phase I, the Contractor may have to take special precautions regarding the installation of crossroad pipes and structures associated with the construction of the proposed storm sewer system and removal of the existing structures. Contractor shall comply with all safety requirements of the City of Wichita and the Occupational Safety & Health Administration (OSHA), especially with respect to depths of excavation, shoring requirements, and the treatment of slopes associated with trench excavations.

No.	Date	By	Approved	Revision

MAIZE ROAD
WEST KELLOGG AVE. TO PAWNEE AVE.
CITY OF WICHITA, KANSAS
CONSTRUCTION SEQUENCE

POE & ASSOCIATES, INC.
CONSULTING ENGINEERS
5940 E. Central, Suite 200 ■ Wichita, KS 67208-4242
Phone: 316/685-4114 ■ FAX: 316/685-4444

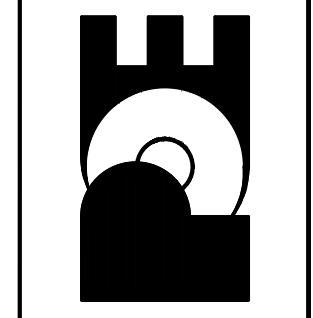

FINAL

Engineer: P. FERGUSON
Designer: K. WARREN
KDOT Job No.: 87 N-0502-01, Poe Job No.: 1935
Date: SEPTEMBER 2009