

FHWA RES. NO.	STATE	PROJECT NO.:	YEAR	SHEET NUMBER	TOTAL SHEETS
7	KANSAS	87 N-0502-01	2009	106	226
A.R.R.A-N050(201)					

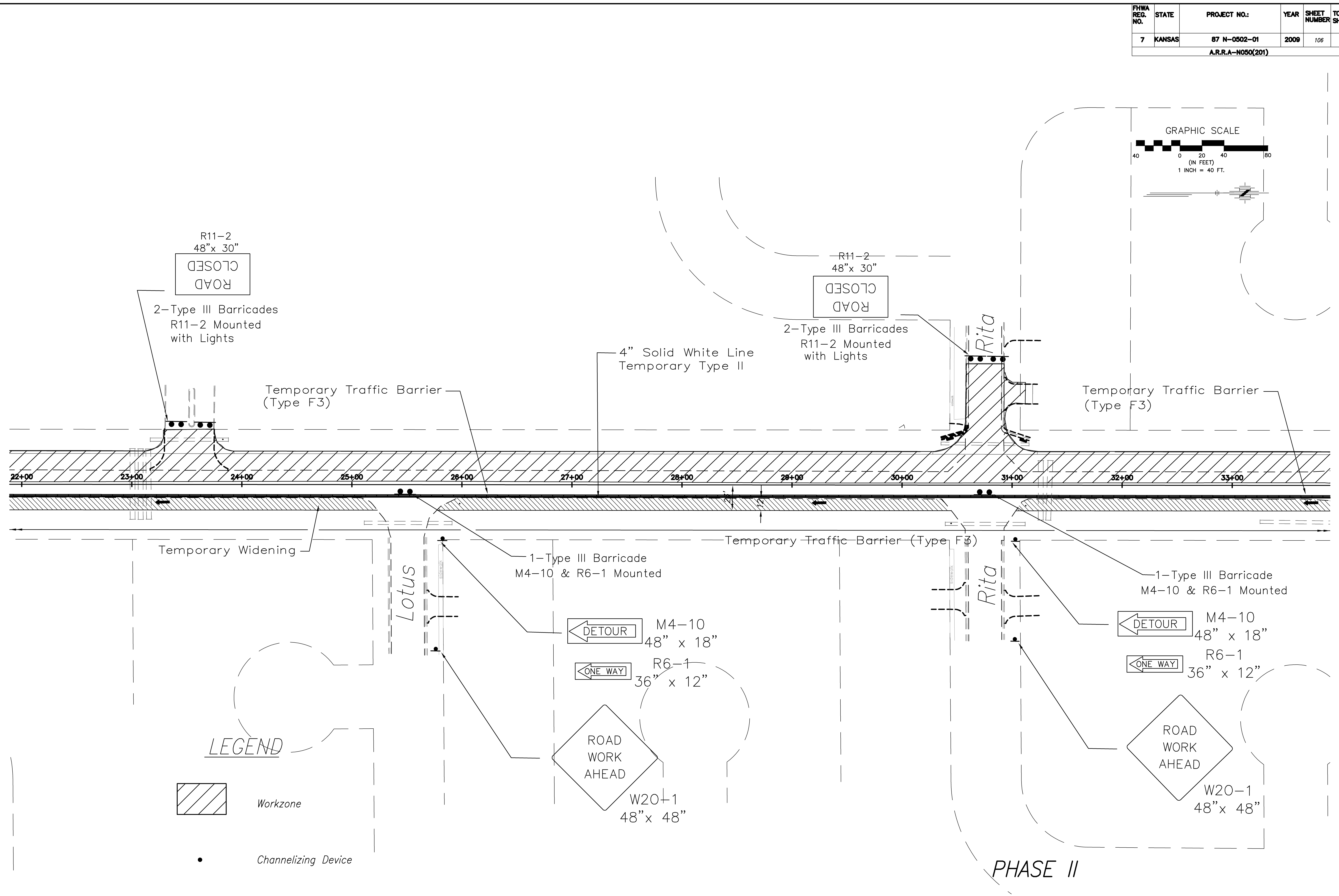
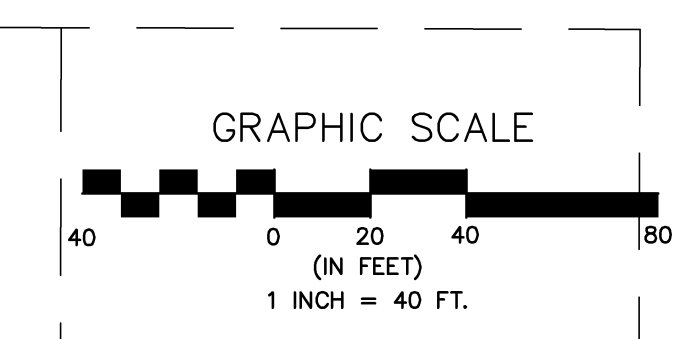

LEGEND

- Workzone
- Channelizing Device

PHASE II

No.	Date	By	Approved	Revision
<p>MAZE ROAD WEST KELLOGG AVE. TO PANNEE AVE. CITY OF WICHITA, KANSAS PHASE II - TRAFFIC CONTROL</p>				
<p>POE & ASSOCIATES, INC. CONSULTING ENGINEERS 5940 E. Central, Suite 200 • Wichita, KS 67208-9242 Phone 316/685-4114 • FAX 316/685-4444</p>				
<p>FINAL</p>				
<p>Engineer: M. THOMPSON Designer: P. FERGUSON KDOT Job No.: 87 N-0502-01 Poe Job No.: 1935 Date: SEPT 2009</p>				
<p>Sheet 106 of 226</p>				