

REFER TO STD. TE710 FOR ADDITIONAL INFORMATION ON TEMPORARY TRAFFIC CONTROL SIGNS AND SIGN SPACING.
 REFER TO STD. TE704 FOR TYPE III BARRICADES.
 REFER TO STD. TE702 FOR INFORMATION ON TAPERS AND CHANNELIZING DEVICES.
 REFER TO STD. TE700 FOR LENGTH OF BUFFER SPACE.

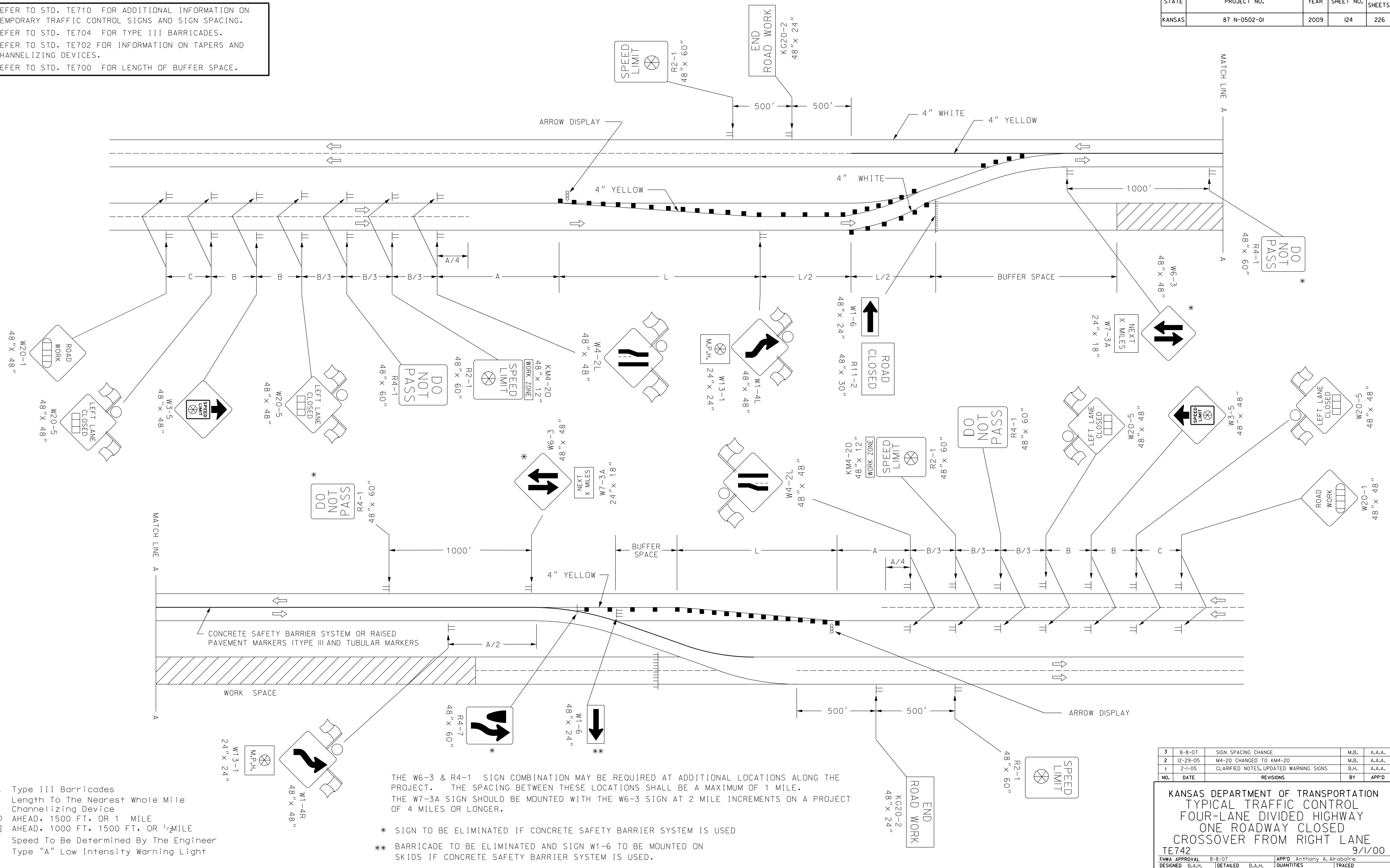

Plotted By : \$\$/USERNAME/\$\$
 Plot File : \$\$\$/SPEC/\$\$\$
 Plot Date : \$\$\$/SYTIME/\$\$\$

- ⊥ Type III Barricades
- X Length To The Nearest Whole Mile
- Channelizing Device
- ▨ AHEAD, 1500 FT, OR 1 MILE
- ▨ AHEAD, 1000 FT, 1500 FT, OR 1/2 MILE
- ⊗ Speed To Be Determined By The Engineer
- Type "A" Low Intensity Warning Light

THE W6-3 & R4-1 SIGN COMBINATION MAY BE REQUIRED AT ADDITIONAL LOCATIONS ALONG THE PROJECT. THE SPACING BETWEEN THESE LOCATIONS SHALL BE A MAXIMUM OF 1 MILE.
 THE W7-3A SIGN SHOULD BE MOUNTED WITH THE W6-3 SIGN AT 2 MILE INCREMENTS ON A PROJECT OF 4 MILES OR LONGER.

- * SIGN TO BE ELIMINATED IF CONCRETE SAFETY BARRIER SYSTEM IS USED
- ** BARRICADE TO BE ELIMINATED AND SIGN W1-6 TO BE MOUNTED ON SKIDS IF CONCRETE SAFETY BARRIER SYSTEM IS USED.

NO.	DATE	REVISIONS	BY	APP'D
3	8-8-07	SIGN SPACING CHANGE	M.B.	A.A.A.
2	12-29-05	M4-20 CHANGED TO KM4-20	M.B.	A.A.A.
1	2-1-05	CLARIFIED NOTES, UPDATED WARNING SIGNS	B.H.	A.A.A.

KANSAS DEPARTMENT OF TRANSPORTATION
 TYPICAL TRAFFIC CONTROL
 FOUR-LANE DIVIDED HIGHWAY
 ONE ROADWAY CLOSED
 CROSSOVER FROM RIGHT LANE
 TE742 9/1/00

DESIGNED	B.A.H.	APP'D	Anthony A. Alrobalre
DESIGN CK.	DETAIL CK.	QUANTITIES	TRACED
		QUAN. CK.	TRACE CK.