

FHWA REG. NO.	STATE	PROJECT NO.:	YEAR	SHEET NUMBER	TOTAL SHEETS
7	KANSAS	87 N-0502-01	2009	169	226
A.R.R.A-N05(201)					

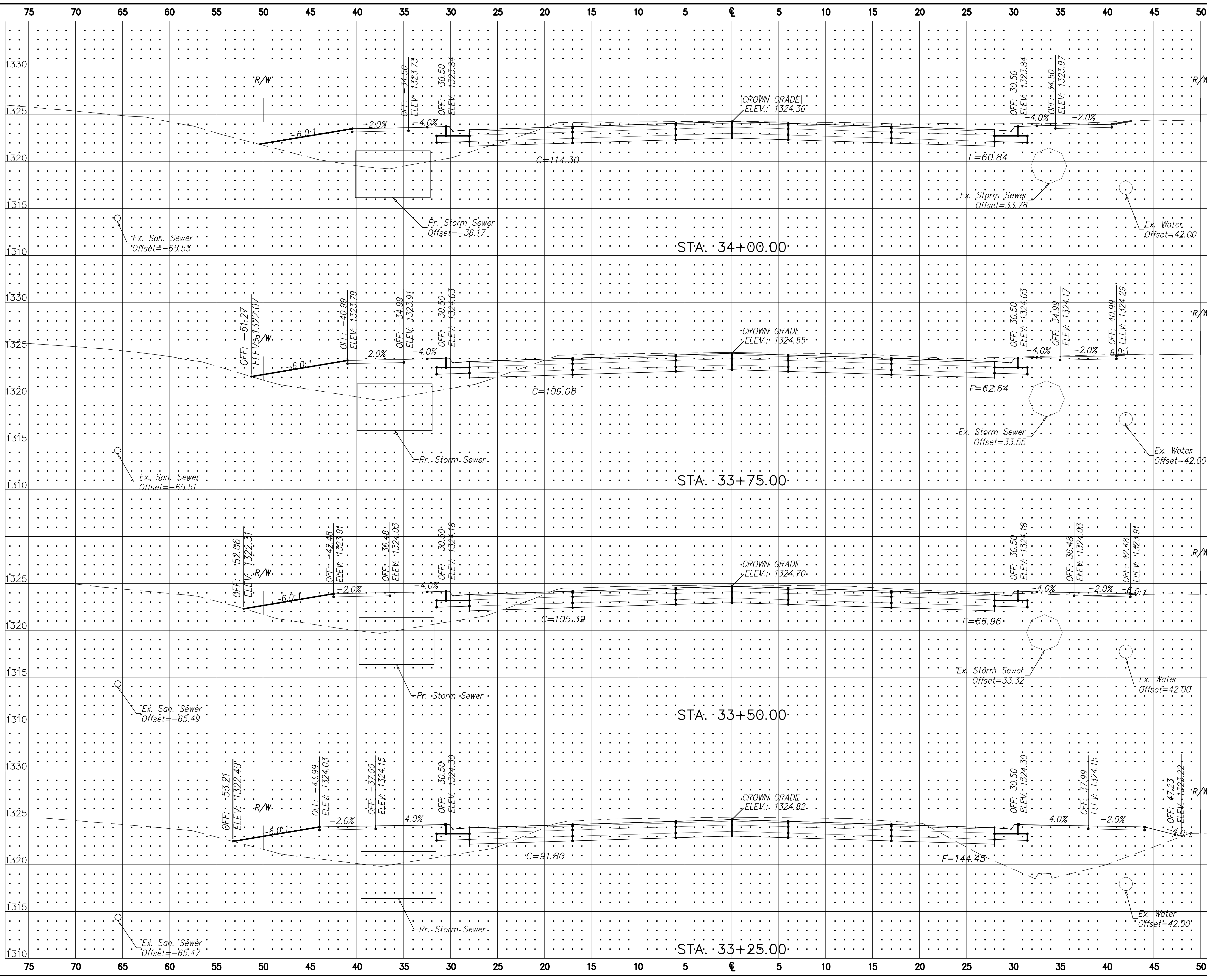

No.	Date	By	Approved	Revision

MAIZE ROAD
WEST KELLOGG AVE. TO PAWNEE AVE.
CITY OF WICHITA, KANSAS

POE & ASSOCIATES, INC.
CONSULTING ENGINEERS
 5940 E. Central, Suite 200 • Wichita, KS 67208-4242
 Phone 316/685-4714 • FAX 316/685-4444

Engineer: P. FERGUSON	Sheet 169 of 226
Designer: K. WARREN	
KDOT Job No.: 87 N-0502-01	Proj. Job No.: 1935
	Date: AUG 2008