

FHWA REG. NO.	STATE	PROJECT NO.:	YEAR	SHEET NUMBER	TOTAL SHEETS
7	KANSAS	87 N-0502-01	2009	201	226
A.R.R.A-N05(201)					

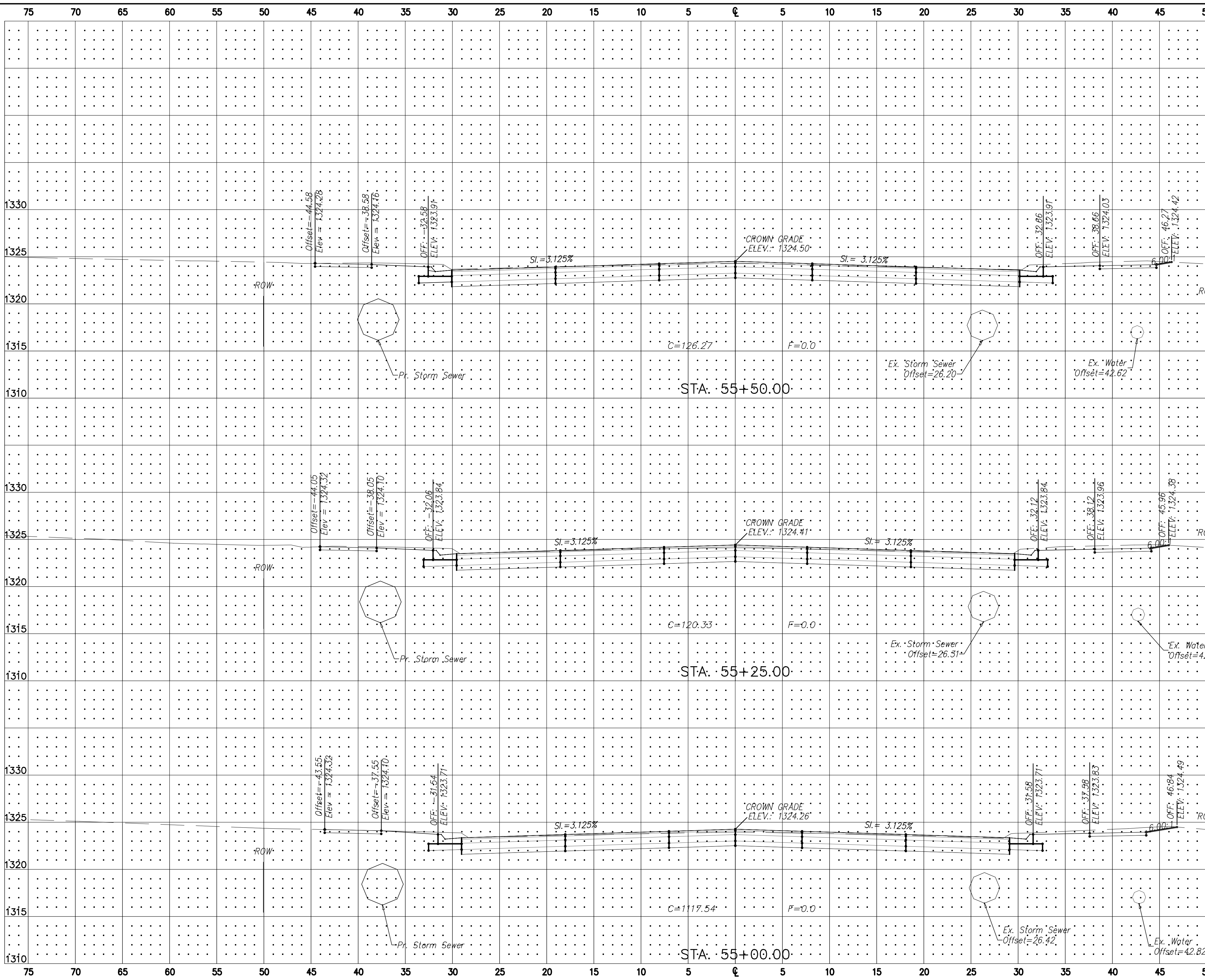

No.	Date	By	Approved	Revision

MAIZE ROAD
WEST KELLOGG AVE. TO PANWEE AVE.
CITY OF WICHITA, KANSAS

POE & ASSOCIATES, INC.
CONSULTING ENGINEERS
5940 E. Central, Suite 200 • Wichita, KS 67208-0242
Phone 316/685-4114 • FAX 316/685-4444

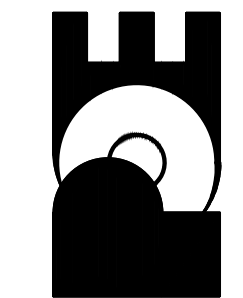

Engineer: P. FERGUSON
Designer: K. WARREN
KDOT Job No.: 87 N-0502-01 Poe Job No.: 1935
Date: AUG 2008