

FHWA REG. NO.	STATE	PROJECT NO.:	YEAR	SHEET NUMBER	TOTAL SHEETS
7	KANSAS	87 N-0502-01	2009	30	226

A.R.R.A.-N050(201)

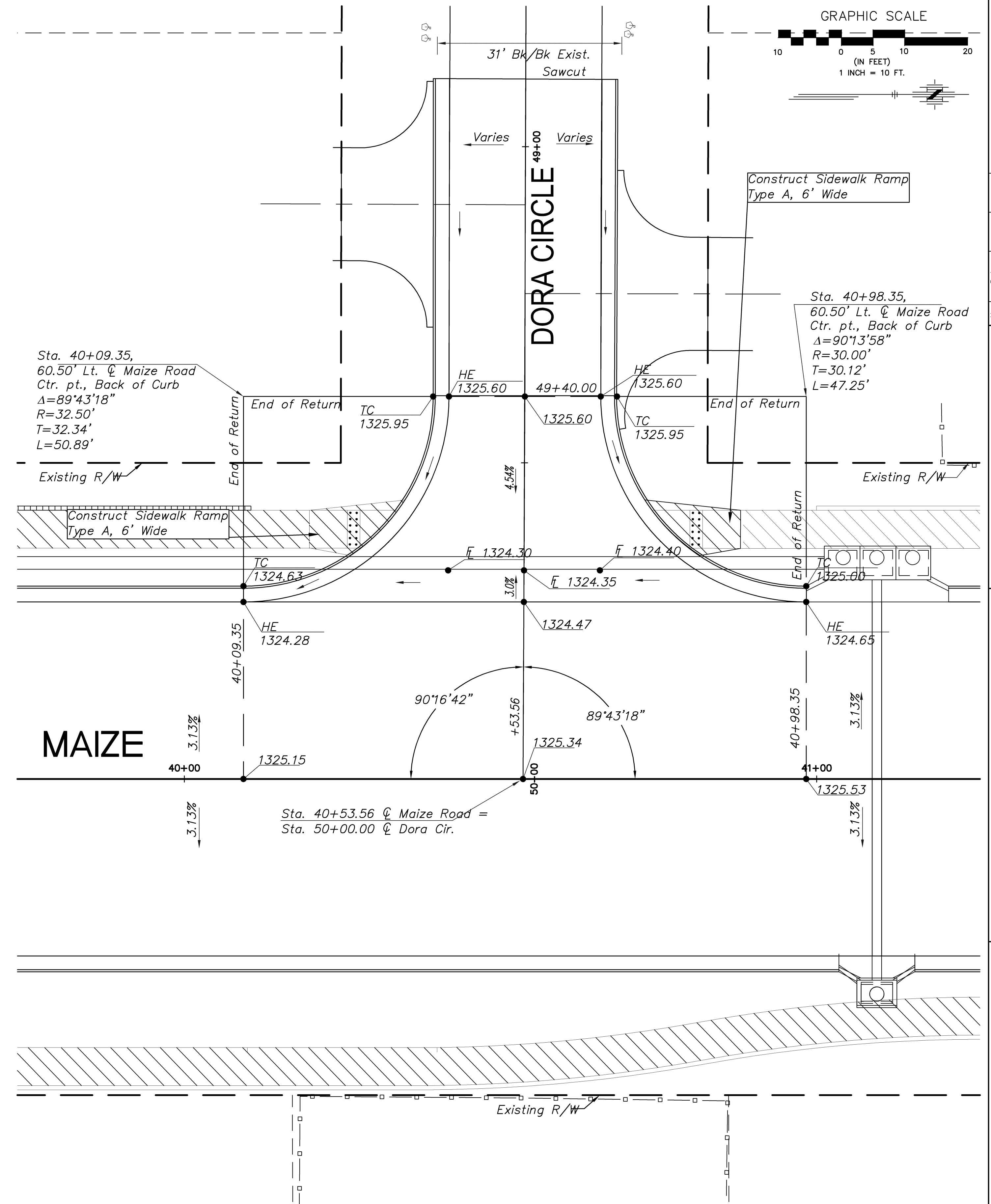
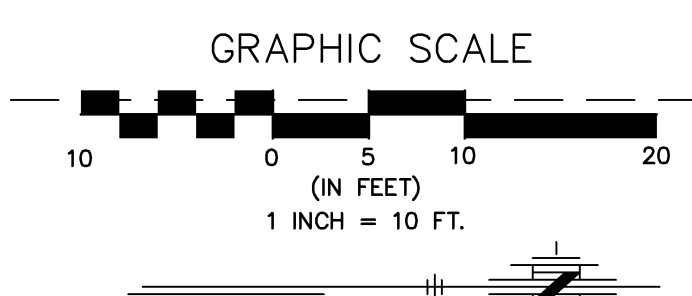
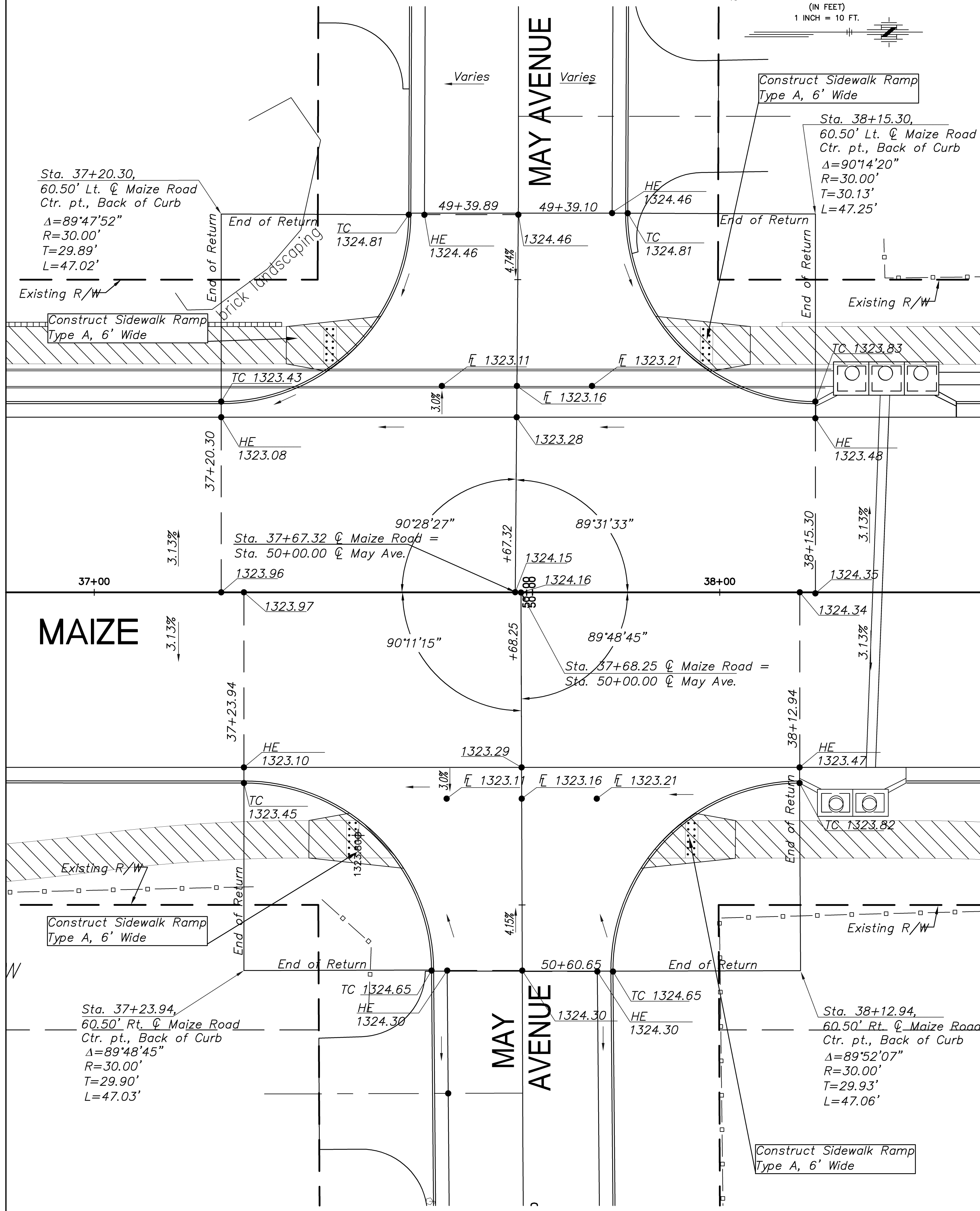
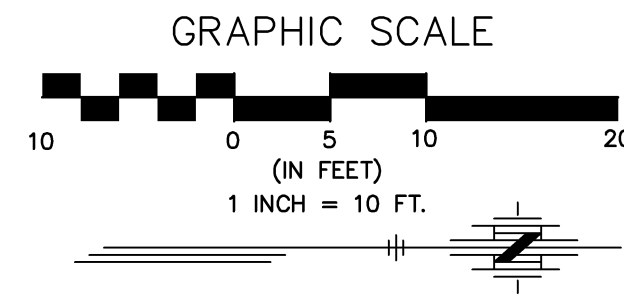

No.	Date	By	Approved	Revision

MAIZE ROAD  
WEST KELLOGG AVE. TO PAWNEE AVE.  
CITY OF WICHITA, KANSAS  
MAY 30+68.25  
DORA 40+53.56

POE & ASSOCIATES, INC.  
CONSULTING ENGINEERS  
5940 E. Central, Suite 200 • Wichita, KS 67208-0242  
Phone 316/685-4114 • FAX 316/685-4444

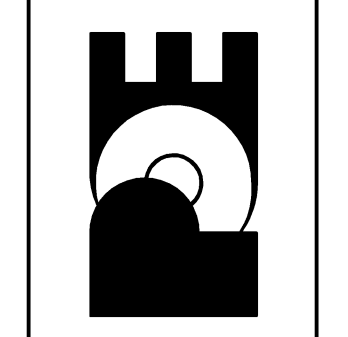

Engineer: P. FERGUSON  
Designer: K. WARREN  
KDOT Job No.: 87 N-0502-01  
Date: SEPTEMBER 2009  
Poe Job No.: 1935