

| FHWA REG. NO. | STATE | PROJECT NO.: | YEAR | SHEET NUMBER | TOTAL SHEETS |
|---------------|--------|--------------|------|--------------|--------------|
| 7 | KANSAS | 87 N-0502-01 | 2009 | 52 | 226 |

A.R.R.A-N05(201)
 Sta. 49+49.54, 43.50' Lt.
 Construct Type 1 Curb Inlet
 L=6'-4", W=6'-4", H=7'-0"
 Install 188.5 L.F. 42" RCP(N)
 See Sheet No. 58

Sta. 45+75.43, 34.17' Lt.
 Construct Type 1-A Curb Inlet
 L=11'-4", W=5'-4", H=7'-0"
 Install 249.5 L.F. 24" RCP(N)
 See Sheet No. 58

Sta. 48+24.94, 34.17' Lt.
 Construct Type 1-A Curb Inlet
 L=11'-4", W=5'-4", H=7'-0"
 Install 125.9 L.F. 30" RCP(N)
 See Sheet No. 58

Sta. 49+23.46, 68.65' Lt.
 Construct Type 1 Manhole
 Dia.=4.0', H=6'-0"
 Install 36.9 L.F. 18" RCP(E)
 See Sheet No. 58

Sta. 48+70.18, 87.07' Lt.
 Construct Type 1-A Curb Inlet
 L=6'-4", W=4'-4", H=5'-0"
 Install 37.4 L.F. 18" RCP(N)
 See Sheet No. 58

Sta. 49+07.58, 86.94' Lt.
 Construct Type 1-A Curb Inlet
 L=6'-4", W=4'-4", H=5'-6"
 Install 24.2 L.F. 18" RCP(NE)
 See Sheet No. 58

Sta. 48+32.14, 33.67' Rt.
 Construct Type 1-A Curb Inlet
 L=11'-4", W=4'-4", H=6'-0"
 Install 68.9 L.F. 24" RCP(W)
 See Sheet No. 58

Sta. 45+72.77, 33.67' Rt.
 Construct Type 1-A Curb Inlet
 L=6'-4", W=4'-4", H=6'-0"
 Install 67.8 L.F. 18" RCP(W)
 See Sheet No. 58

Sta. 49+41.55, 33.67' Rt.
 Construct Type 1-A Curb Inlet
 L=6'-4", W=4'-4", H=5'-6"
 Install 77.7 L.F. 24" RCP(W)
 See Sheet No. 58

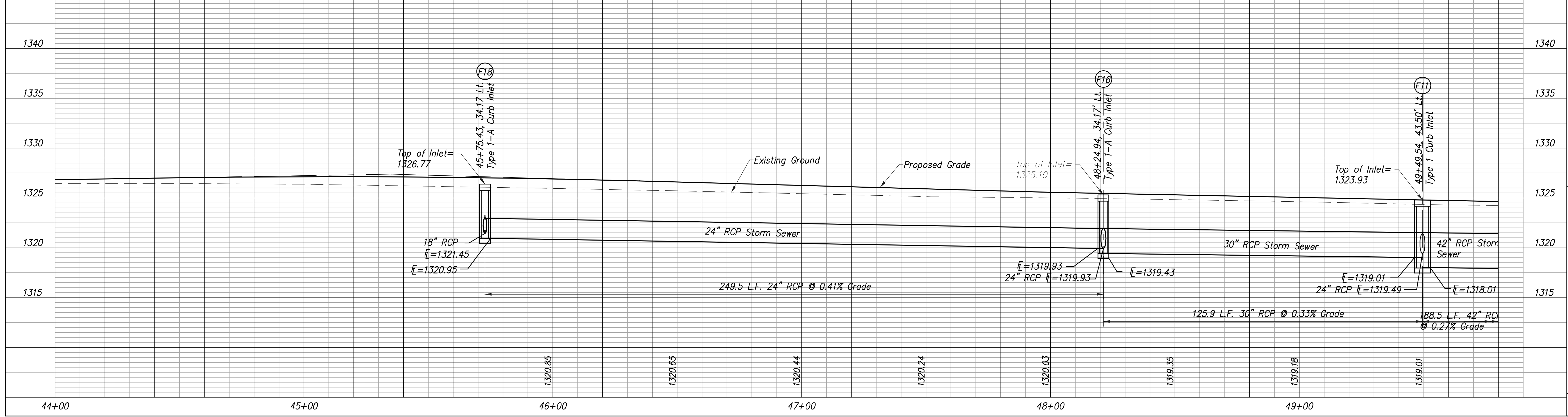
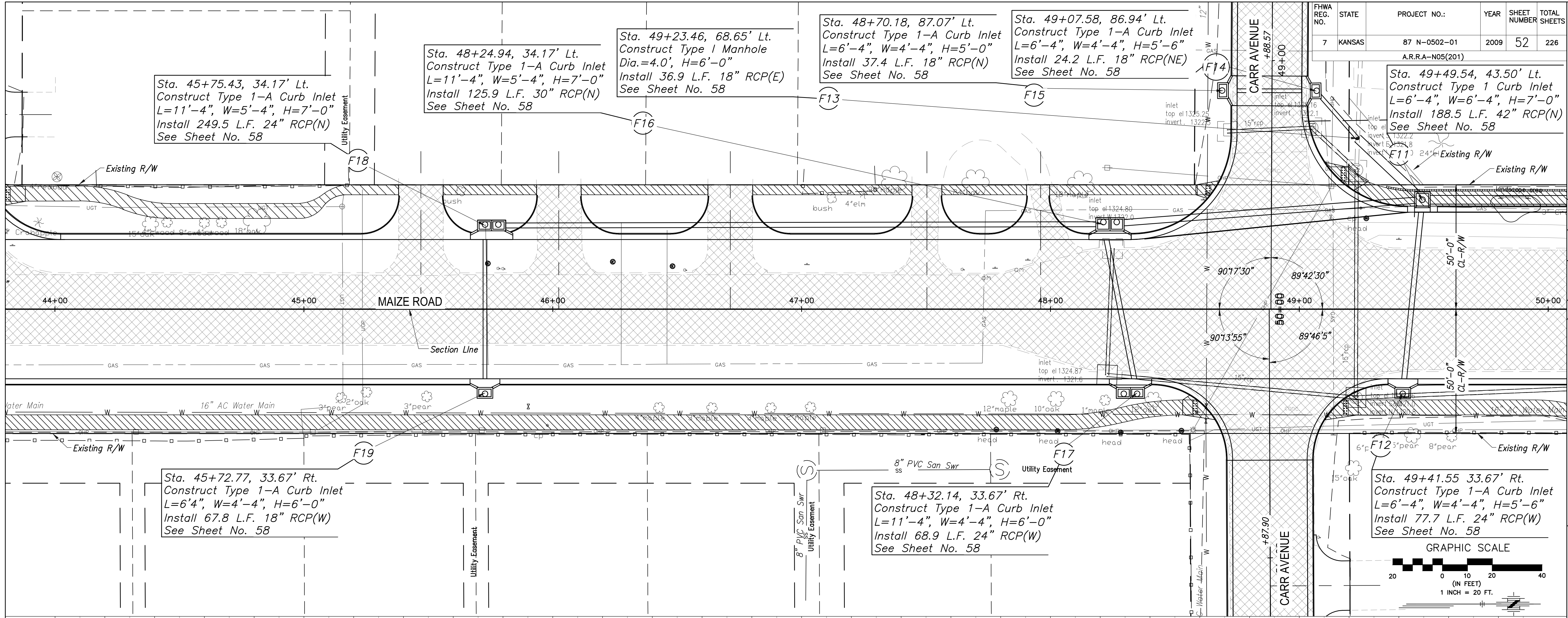
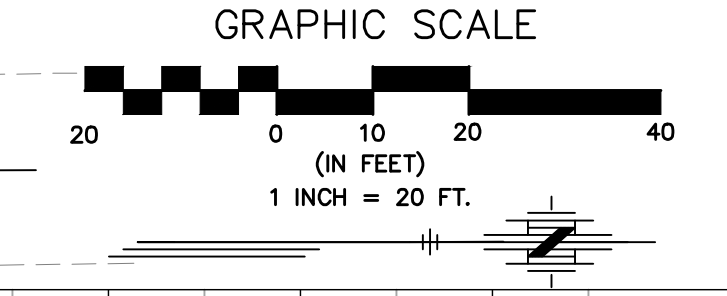

MAIZE ROAD
 WEST KELLOGG AVE. TO PAWNEE AVE.
 CITY OF WICHITA, KANSAS
 STORM SEWER P & P 44+00 to 49+80

POE & ASSOCIATES, INC.
 CONSULTING ENGINEERS
 5940 E. Central, Suite 200 • Wichita, KS 67208-4212
 Phone: 316/665-4114 • FAX: 316/665-4444

Engineer: P. FERGUSON
 Designer: K. WARREN
 KDOT Job No.: 87 N-0502-01 • P&E Job No.: 1935
 Date: SEPTEMBER 2009

52 of 226