

La Placita

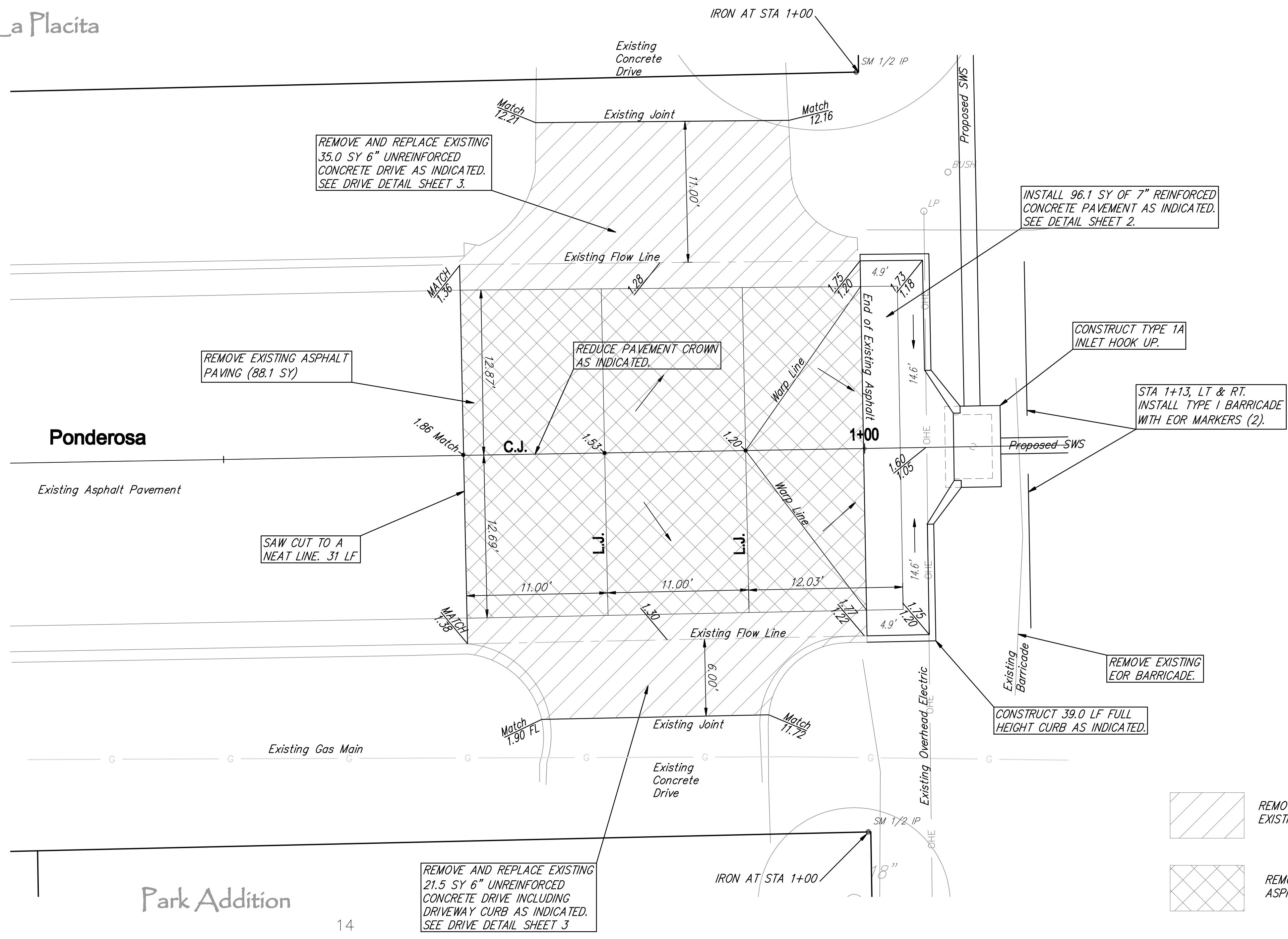
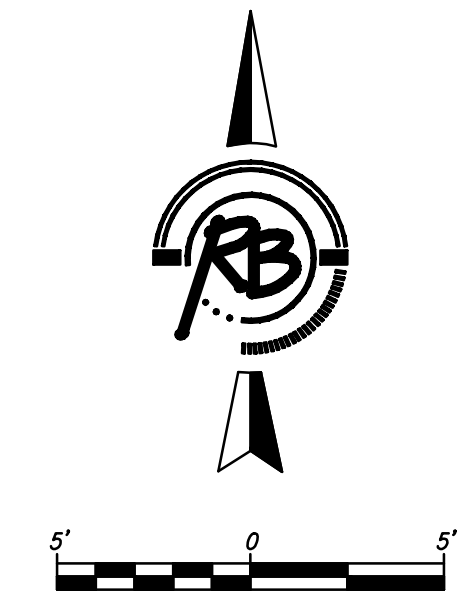

REMOVE AND REPLACE EXISTING 35.0 SY 6" UNREINFORCED CONCRETE DRIVE AS INDICATED. SEE DRIVE DETAIL SHEET 3.

INSTALL 96.1 SY OF 7" REINFORCED CONCRETE PAVEMENT AS INDICATED. SEE DETAIL SHEET 2.

REMOVE EXISTING ASPHALT PAVING (88.1 SY)

REDUCE PAVEMENT CROWN AS INDICATED.

CONSTRUCT TYPE 1A INLET HOOK UP.

STA 1+13, LT & RT. INSTALL TYPE I BARRICADE WITH EOR MARKERS (2).

SAW CUT TO A NEAT LINE. 31 LF

REMOVE EXISTING EOR BARRICADE.

CONSTRUCT 39.0 LF FULL HEIGHT CURB AS INDICATED.

REMOVE AND REPLACE EXISTING 21.5 SY 6" UNREINFORCED CONCRETE DRIVE INCLUDING DRIVEWAY CURB AS INDICATED. SEE DRIVE DETAIL SHEET 3

REMOVE AND REPLACE EXISTING CONCRETE DRIVE

REMOVE EXISTING ASPHALT PAVING

Park Addition

CONCRETE PAVEMENT IN THE STREET IS TO REMAIN 7" REINFORCED CONCRETE ON 5" CRUSHED ROCK BASE THROUGHOUT THE ENTIRE ALIGNMENT.

**LA PLACITA PARK ADDITION
PONDEROSA
WICHITA, KANSAS**



Ruggles & Bohm, P.A.
Engineering, Surveying, Land Planning

224 North Main
Wichita, Kansas 67203
www.rbkansas.com

(316) 264-8800
(316) 264-4821 fax
E-mail: info@rbkansas.com

DESIGNED BY: EJG
DRAWN BY: EJG
REVIEWED BY: Sept. 22, 2009
DATE: 5
SHEET: 14

PROJECT NUMBER: 562-859204

PROJECT FILE: Engineering Base {Ponderosa}