

PROJECT NO.	YEAR	SHEET NO.	TOTAL SHEETS
KA-1006-04	2010	30D	71

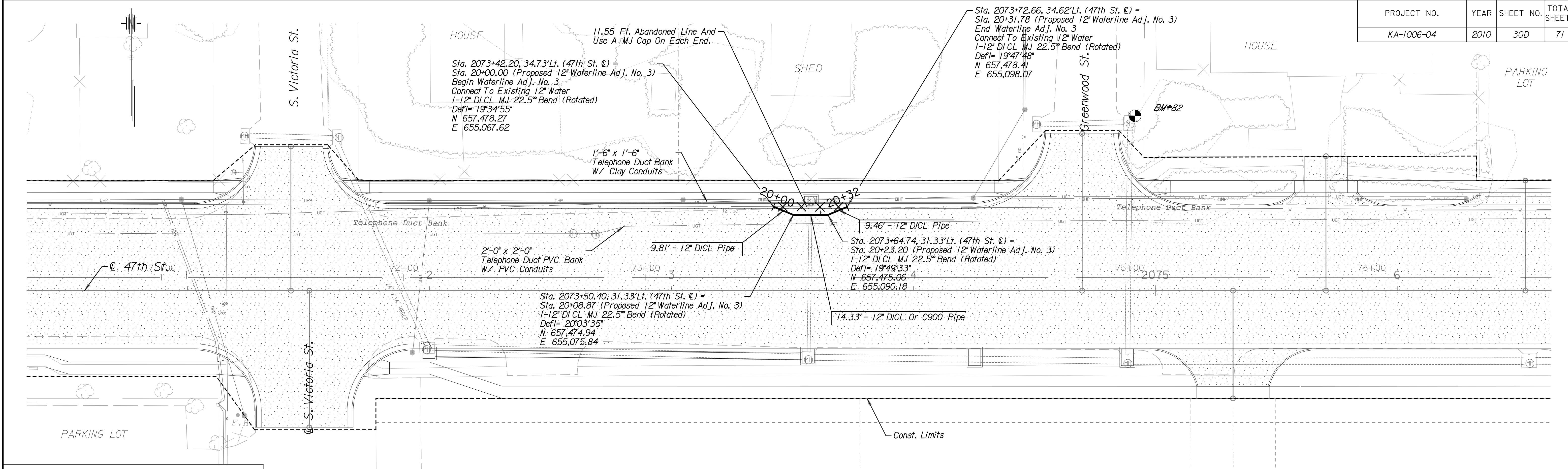

B.M. #82 "cut on NE corner curb inlet NE corner intersection 47th and Greenwood E. side Greenwood +/- 50' N. of E. 47th Sta. 2074+91.67, 72.28' Lt., E. 47th, Elev. 1270.98 (NAVD 88)

Note: All Pipes On This Sheet Shall Be Cleaned And Swabbed.
 Unless Noted Otherwise, Elevations Shown Are Top Of Pipe.

WATERLINE ADJUSTMENT NO. 3

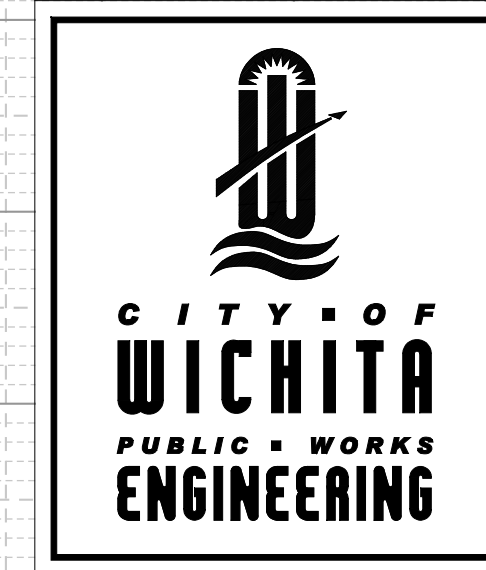
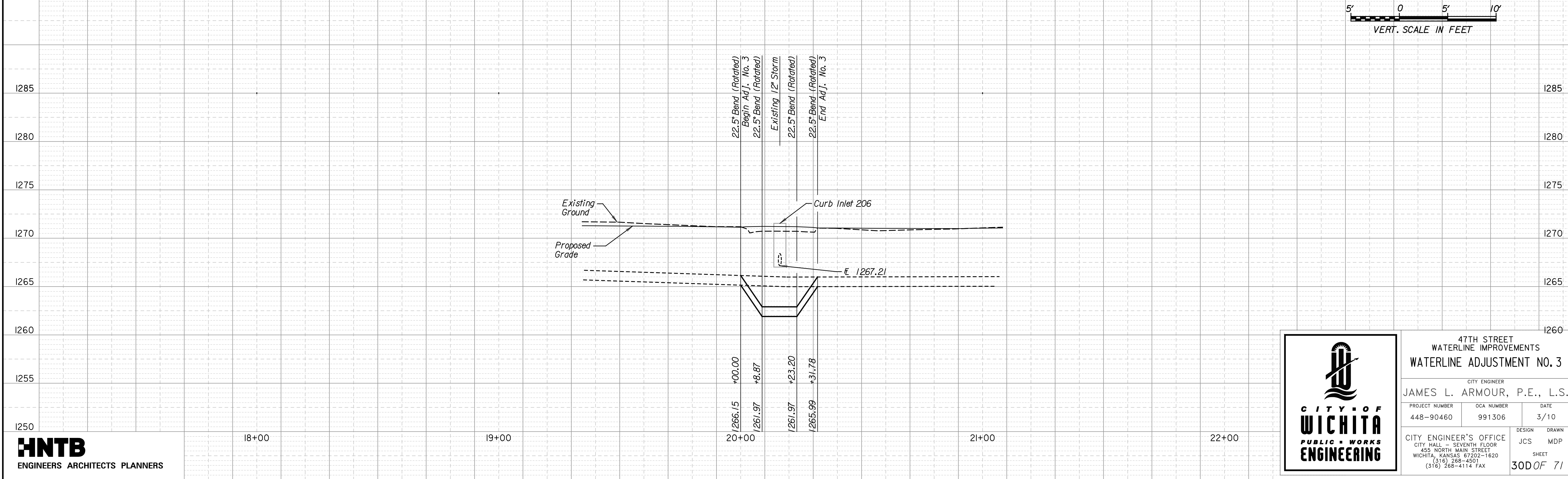
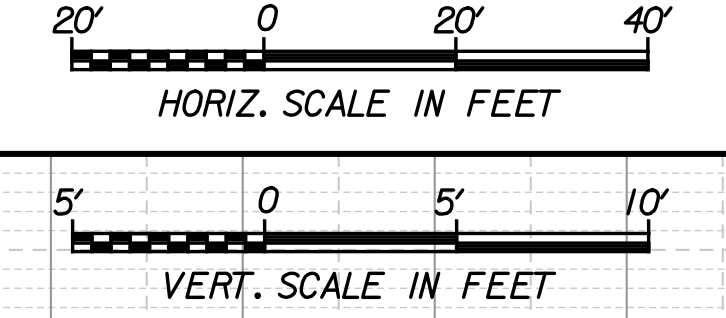

47TH STREET WATERLINE IMPROVEMENTS WATERLINE ADJUSTMENT NO. 3		
CITY ENGINEER		
JAMES L. ARMOUR, P.E., L.S.		
PROJECT NUMBER	OCA NUMBER	DATE
448-90460	991306	3/10
CITY ENGINEER'S OFFICE		DESIGN
CITY HALL - SEVENTH FLOOR		JCS
455 NORTH MAIN STREET		MDP
WICHITA, KANSAS 67202-1620		SHEET
(316) 268-4501		30D OF 71
(316) 268-4114 FAX		

Plotted on: Thursday, March 11, 2010 4:17
 mpc1115
 Plot Queue: \\cbe\w00\KCP\B\F\FPS
 Plot Scale: 1/8"=1'-0"
 Design Filename: \\kco\w00\Jobs\50317\WaterRes\CD\PlanProf\47th...p1002.dgn



\\kco\w00\Jobs\50317\WaterRes\CD\PlanProf\47th...p1002.dgn