

PROJECT NO.	YEAR	SHEET NO.	TOTAL SHEETS
KA-1006-04	2010	51	71

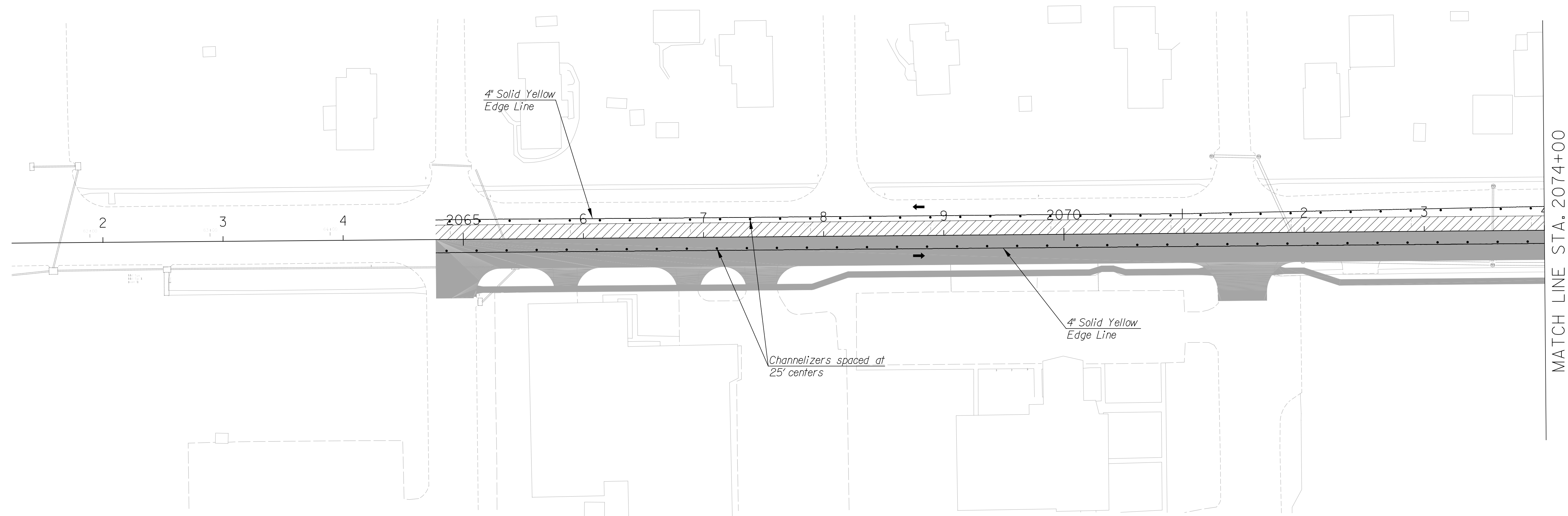
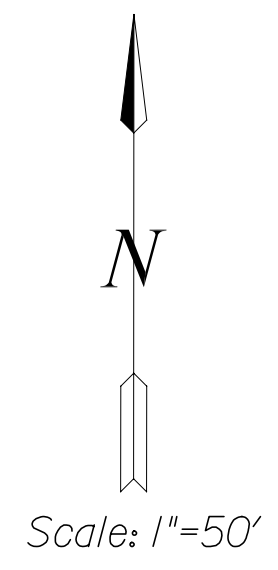

LEGEND

- Current Phase Construction
- Previously Completed Construction
- Temporary Asphalt
- Type "A" Low Intensity Warning Light
- Temporary Concrete Safety Barrier (Type F3)
- Channelizer
- Traffic Location
- Red Type "B" High Intensity Warning Light
- Type III Barricades
- Changeable Message Sign
- Phase construct with lane closure during off-peak hours.

Plotted on: Friday, February 26, 2010 9:03
 Kschoncker Plot Output: \\CBSM00\KCS08935-PS
 Plot Scale: 49.9999 Plot Table: 5037_half.dgn
 Design Filename: \\kcow00\jobs\5037\Roadway\CD\TrafficControl\47th_TC_Ph2_01.dgn



TRAFFIC CONTROL PHASE 2 47TH ST. TEMP. MARKING & SIGNING PLAN		
CITY ENGINEER JAMES L. ARMOUR, P.E., L.S.		
PROJECT NUMBER 472-84872	OCA NUMBER 991306	DATE 03/10
CITY ENGINEER'S OFFICE CITY HALL - SEVENTH FLOOR 455 NORTH MAIN STREET WICHITA, KANSAS 67202-1620 (316) 268-4501 (316) 268-4114 FAX		DESIGN EGS
DRAWN RAM		SHEET 51 OF 71

\\kcow00\jobs\5037\Roadway\CD\TrafficControl\47th_TC_Ph2_01.dgn