

THIS SHEET FOR INFORMATION ONLY:  
WEIR TO BE CONSTRUCTED BY PHASE 1 CONTRACTOR

**EROSION CONTROL NOTES**

1. EROSION CONTROL IS TO MEET ALL FEDERAL, STATE, COUNTY, AND LOCAL STANDARDS.
2. CONTRACTOR SHALL PROVIDE AND PRESERVE EROSION PROTECTION THROUGHOUT PROJECT CONSTRUCTION. THE PLAN PROVIDED HERE IS FOR FINAL PROTECTION. VARIOUS PHASES OF THIS PLAN SHALL BE IMPLEMENTED OR MODIFIED TO CONTROL EROSION. MODIFICATIONS OF THE PLAN SHALL BE APPROVED BY THE OWNER'S REPRESENTATIVE.
3. SEEDING AREAS SHALL BE PREPARED FOR PLANTING WITH COMMON AGRICULTURAL TECHNIQUES. ALL RESERVE AREAS SHALL BE FINE GRADED USING SMALL EQUIPMENT. REMOVE EXISTING GRASS, VEGETATION, AND TURF. DO NOT MIX INTO SURFACE SOIL. LOOSEN SOIL TO A DEPTH OF AT LEAST 6". GRADE AREAS TO A SMOOTH UNIFORM SURFACE PLANE. ROLL, RAKE, AND REMOVE RIDGES AND FILL DEPRESSIONS. THE SURFACE SHALL BE FREE FROM STICKS, SMALL STONES, AND OTHER EXTRANEIOUS MATERIALS. APPROVE WITH OWNER'S REPRESENTATIVE BEFORE PLANTING.
4. CONTRACTOR IS RESPONSIBLE FOR MAINTAINING AND IMPLEMENTING ALL EROSION CONTROL.
5. THE CONTRACTOR SHALL SEED ALL DISTURBED AREAS AS FOLLOWS:  
PERENNIAL RYE @ 150 LBS./ACRE  
10-20-10 @ 150 LBS./ACRE
6. ALL SEED SHALL BE DISTRIBUTED WITH AN ACCEPTABLE DRILL INTENDED FOR SUCH OPERATIONS, OR OTHER EQUIPMENT APPROVED BY THE OWNER'S REPRESENTATIVE. SEEDING DEPTH SHALL BE 1/4".
7. BROADCASTING WILL BE ALLOWED IN INACCESSIBLE AREAS TO THE DRILL ONLY AFTER GROUND IS DISTURBED TO CREATE A SUITABLE SEEDBED. SEEDING DEPTH SHALL BE 1/4".
8. ALL SEEDED AREAS SHALL BE IMMEDIATELY MULCHED W/ CLEAN PRAIRIE HAY AT 2 TONS/ACRE. ANCHOR MULCH BY CRIMPING INTO TOPSOIL WITH SUITABLE MECHANICAL EQUIPMENT.

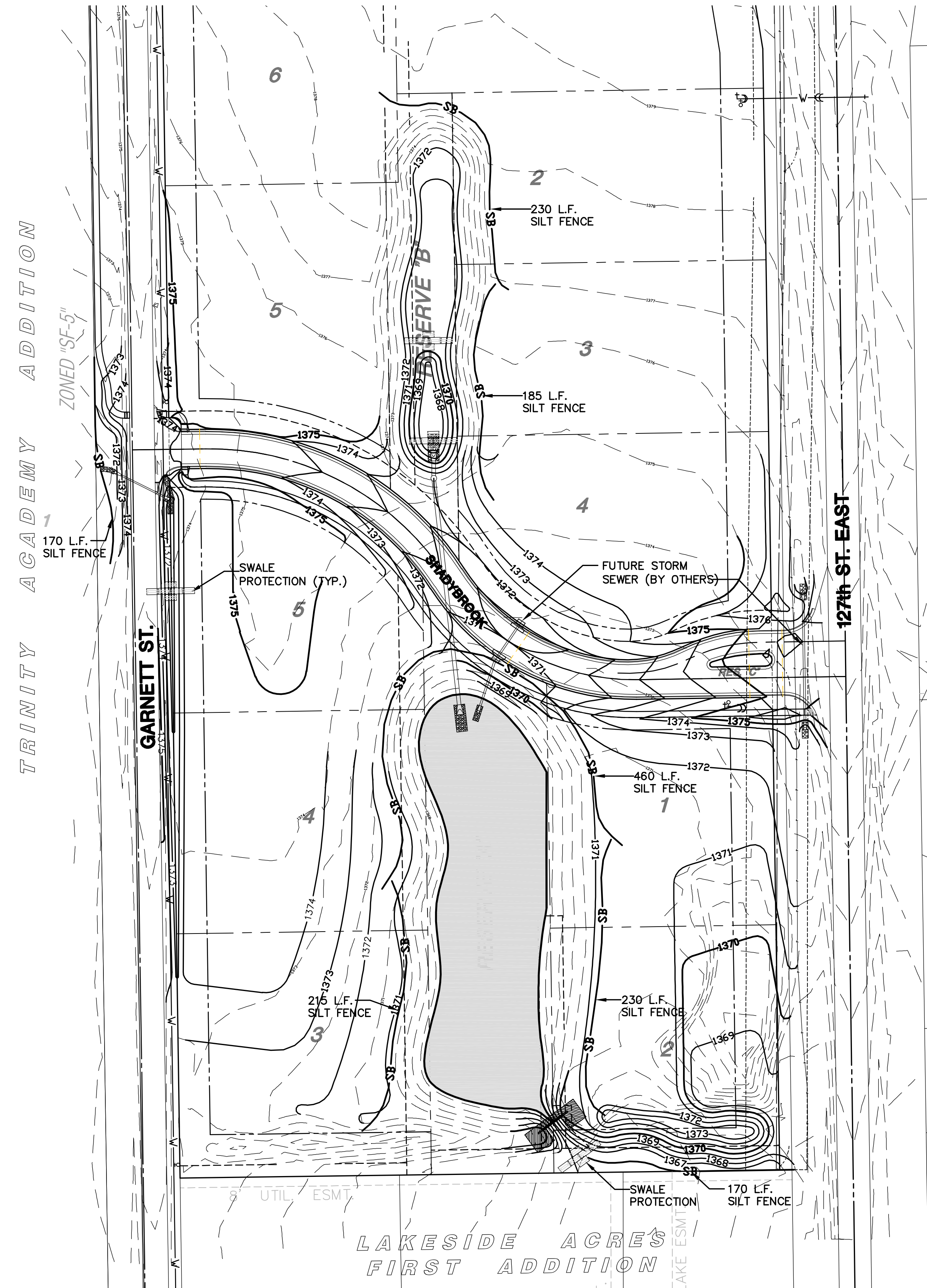

**EROSION CONTROL LEGEND**

- SILT PROTECTION FENCE
- HAY BALE SEDIMENT BARRIER
- CURB INLET SEDIMENT BARRIER

**EROSION CONTROL PLAN**  
SCALE: 1" = 60'-0"

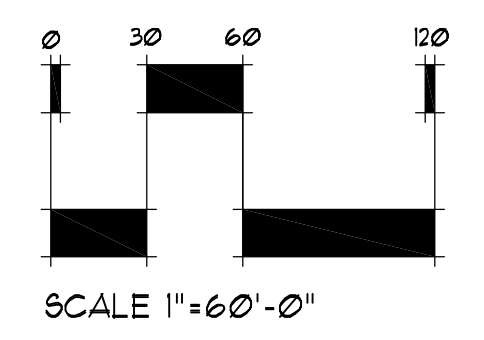

**GRADING AND DRAINAGE PLANS**  
**SUMMIT CROSSING**  
WICHITA, KANSAS

**EROSION CONTROL PLAN**

SHEET TITLE  
**08542**  
PROJECT NUMBER

**MKEC**  
DESIGN BY  
**RKO**  
DRAWN BY  
**GJA**  
CHECKED BY

ISSUED  
**May 2010**  
REVISED

SHEET NO.  
**3 of 11**