

WATER LINES TO SERVE REFLECTION LAKE at CLOUD CITY

3rd Addition

1466 PPW (607853)

CITY OF WICHITA, KANSAS
Jim Armour, P.E., City Engineer

RECORD DRAWING AS-BUILTS 3-29-2010
ENGINEER: KEMILLER ENGINEERING
CONTRACTOR: MCCULLOUGH EXC.
INSPECTOR: POE AND ASSOCIATES, INC.

GENERAL NOTES:

- Contractor will be required to provide notice to utility companies a minimum of twenty-four (24) hours prior to any excavation, as follows:

Kansas One-Call (316)687-2470

The Contractor must notify the following in case of an emergency:

Cox Communications (316)262-0661
Kansas Gas Service (316)383-8600
K.G.E. Electric (316)383-8600
Peoples Natural Gas Company (800)303-0357
AT&T 1-555-1212
City of Andover (316)733-1303
City of Wichita Water Dept. (316)268-4071
Kerry Gibson (316)268-4555
- Underground utility service lines and overhead utility pole lines are to be adjusted as necessary by others prior to construction unless the plans specifically call for their adjustment by the Contractor or unless the plans specifically identify a utility to be adjusted by its owner during construction. Existing utilities and their locations, as shown on the plans, represent the best information obtainable for design. Location information has been obtained from the various utility companies and is either from company record drawings or company-provided field locations. The Contractor will be required to work around existing utilities within the right-of-way which do not conflict with proposed construction.
- A saw cut of at least one-half the depth of existing surface courses or one-fourth the depth of existing total pavement thickness shall be provided at locations where proposed construction abuts an existing surface course or pavement for which partial removal of that surface or pavement is required, except when such saw cuts are within three (3) feet of an existing joint the limits of removal shall be extended to the existing joint. Such saw cuts will not be paid for directly and this cost shall be considered as subsidiary to the removal of the surface or pavement.
- Rubble from the removal of miscellaneous structures and excess excavation which is to be wasted shall be disposed of on sites to be provided by the Contractor. These sites shall be approved by the Engineer as to suitability, appearance and site location. Locations that, in the opinion of the Engineer, will leave an unsightly appearance will not be approved.
- All disposal sites must be approved by the Kansas Department of Health and Environment. Material either stockpiled or disposed of in a flood plain would require a Kansas State Board of Agriculture permit. Any material dumped in waters of the United States or wetlands is subject to U.S. Corps permitting regulations. Any material buried or stockpiled beyond approved of Engineers construction limits would require additional archeological investigations unless buried in a previously approved borrow location.
- The Engineer shall take field ties to all quarter section corners. The Contractor shall set a City survey monument in the required location where such quarter section corners fall within the limits of pavement construction. Survey monuments will be furnished by the City. The Engineer will accurately locate and install the iron as the quarter section corner. This work will not be paid for directly, but shall be considered subsidiary to the other pay items of work in the contract.
- The Contractor shall notify pipeline companies at least twenty-four (24) hours in advance of any work being performed across and/or adjacent to pipelines.
- The Contractor shall give all property owners and/or tenants of developed property directly abutting the construction of the project a minimum of ten (10) days advance notice prior to start of construction.
- The Contractor shall seed, fertilize and mulch all disturbed areas upon completion on construction. Incidental to the bid item for "Site Clearing and Restoration."
- If proposed water line has less than 2' of existing ground cover, use protective fill as stated on Water Assembly Detail Sheet.

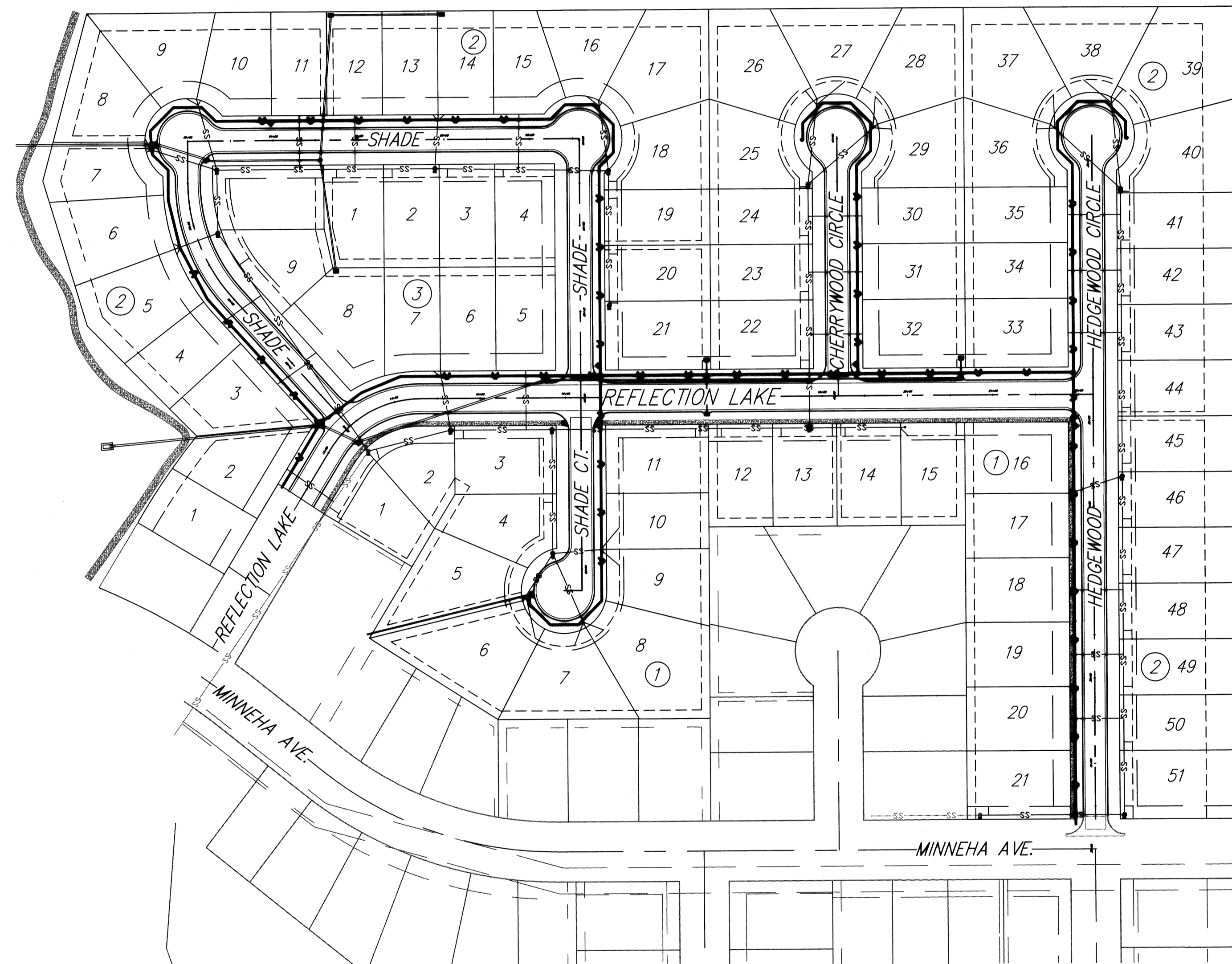

APPROVED AS NOTED
BY CITY ENGINEER OF WICHITA,
BY WICHITA WATER & SEWER DEPARTMENT,
& BY WICHITA FIRE DEPARTMENT

Public Works *[Signature]* 4-13-09
Water & Sewer *[Signature]* 4-1-09

NOTE TO CONTRACTORS
Public Property:
Inspection and testing for the waterline is to be provided by a Licensed Consulting Engineering Firm under contract with the Owner/Developer. Said inspection to be in accordance with the City of Wichita standard construction engineering practices and certified by a Professional Engineer Licensed in the state of Kansas. No work shall be performed in dedicated easements or public right-of-way by the Contractor without such inspection nor shall any work be commenced without written authorization by the City Engineer. All Construction and Materials shall comply with the City or Wichita Specifications and Standards (on file and available in the City Engineer's Office).

May 2008

6" & 8" DUCTILE IRON TYTON JOINT PIPE
HANDLEY INDUSTRIES, INC. 2" CATHODIC TEST STATIONS
MESA AGRA CONDULET TEST STATIONS
MESA MAXMAG HIGH POTENTIAL MAGNESIUM ANODES
CLOW MEDALLION HYDRANTS
CLOW GATE VALVES
SIGMA/RUSSELL VALVE BOXES
SIGMA DUCTILE IRON MECH. JOINT FITTINGS

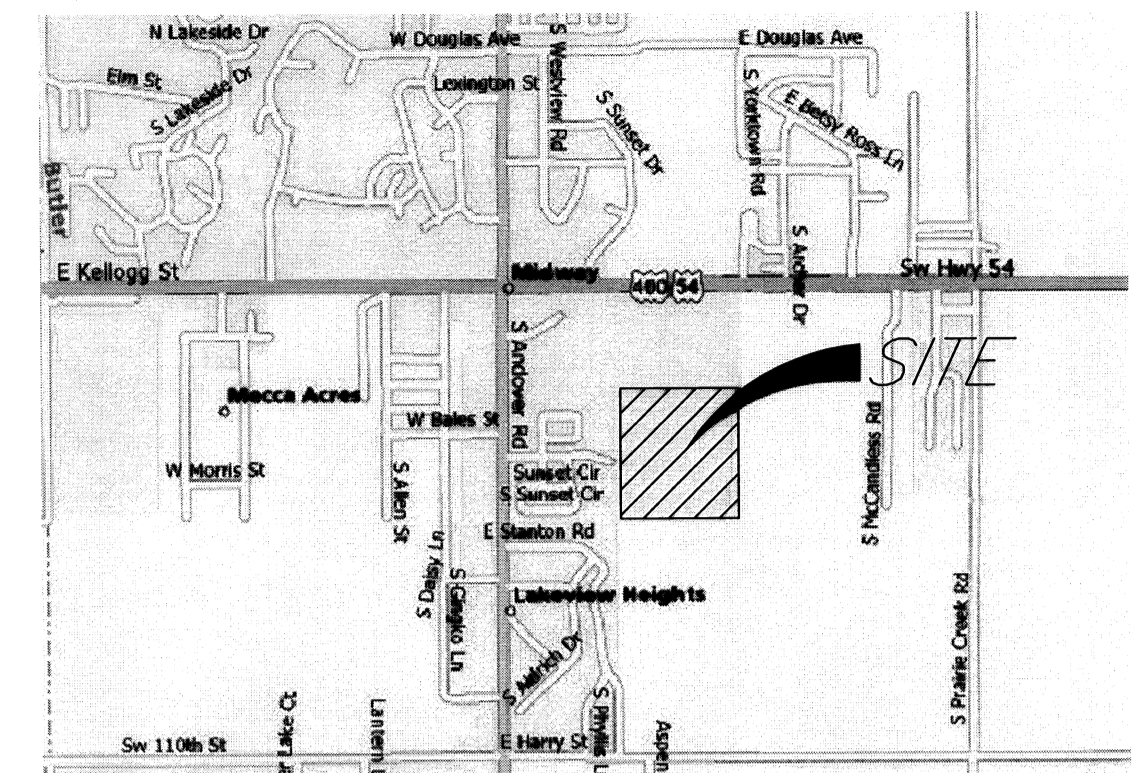
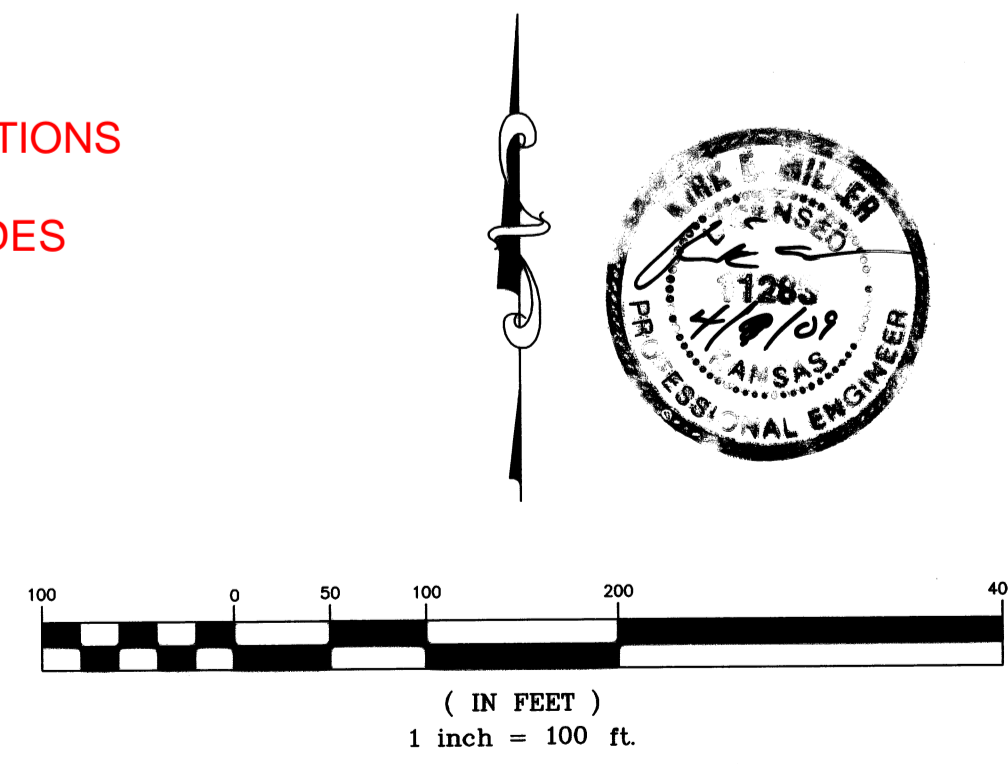

LOCATION MAP

INDEX OF SHEETS:

- Cover Sheet
- Line 1 Plan/Profile
- Line 1 Plan/Profile
- Line 2 Plan/Profile
- Line 2 Plan/Profile
- Line 3 Plan/Profile
- Line 4 Plan/Profile
- Line 5 Plan/Profile
- Line 5 Plan/Profile
- Line 5 Plan/Profile
- Water Assembly Details

Baselines:

- Reflection Lake BL
Starting Sta. 10+00.00 at Intersection of E Minneha Ave. and E Reflection Lake. Following E Reflection Lake.
- Hedgewood BL
Starting Sta. 30+00.00 at Intersection of E Minneha Ave. and E Hedgewood. Following on E Hedgewood.
- Cherrywood Circle BL
Starting Sta. 40+00.00 at Intersection of E Reflection Lake and E Cherrywood Circle. Following E Cherrywood Circle.
- Shade 50+00 BL
Sta. 50+00.00 at Intersection of E Shade and E Reflection Lake. Following E Shade.
- Shade 60+00 BL
Sta. 60+00.00 at Center of West Round-a-bout. Following E Shade Eastward.
- Shade 70+00 BL
Sta. 70+00.00 at West Intersection of E Reflection Lake and E Shade. Following E Shade.

Benchmarks:

- Top Steel "T" Post set 2" below grade, 6 feet North of Fence Corner, Fence East and South Gate West, At South end McCandless.
Elev. = 1314.06



516 S. Market,
Wichita, KS 67202 316/264-0242